



21 NORTHFIELDS,
LETCHWORTH, SG6 4RJ

Lane &
BENNETTS



21 Northfields
Letchworth Garden City
Hertfordshire
SG6 4RJ

Lane & Bennetts are delighted to offer this impressive three double bedroom family home, walking distance to good schools and local amenities. Stylishly presented, with a high standard of fixture and fittings, it is a property worth seeing to appreciate its fine qualities.

The open plan kitchen & dining space is the heart of the home, boasting space for a range cooker, whilst the large living room has an open feature fireplace, and patio doors lead to a sunny decking area. There is an entrance hall, utility space and family shower room. There is plenty of storage at the property, which is fully double glazed, and had a new boiler in 2014.

The South facing garden is approx. 100ft, landscaped and divided to provide a Japanese inspired Zen space with nature pond, and a hidden garden with outbuildings. Just over a mile from the town centre and station, the 100 acre Norton common, and the 13.6 mile Letchworth Garden City Greenway are both an easy walk away.

The estate agents that bring you: **KNOWLEDGE. INTEGRITY. RESULTS.**

Lane &
BENNETTS

A FABULOUS THREE BEDROOM FAMILY HOME, BEAUTIFULLY MAINTAINED THROUGHOUT



KEY FEATURES

- WELL PROPORTIONED THREE DOUBLE BEDROOM HOME
- DUAL ASPECT LOUNGE ROOM
- LARGE KITCHEN / DINER
- STUNNING, MATURE GARDEN APPROX 100FT
- CLOSE TO SCHOOLS AND AMENITIES
- UTILITY AREA
- HIGH QUALITY FIXTURES THROUGHOUT



21 Northfields

Approximate Gross Internal Area
936 sq ft - 87 sq m

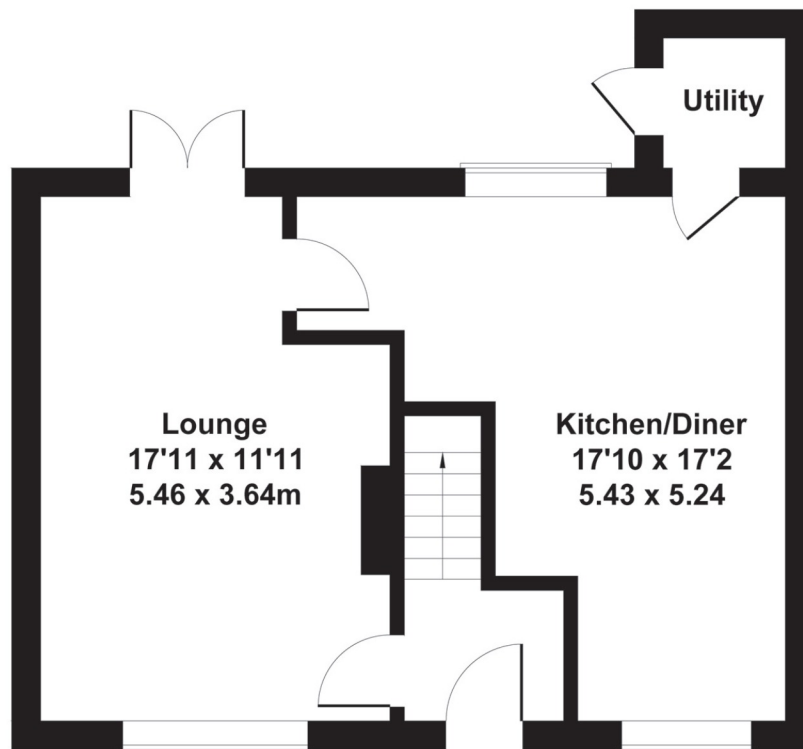

GROUND FLOOR

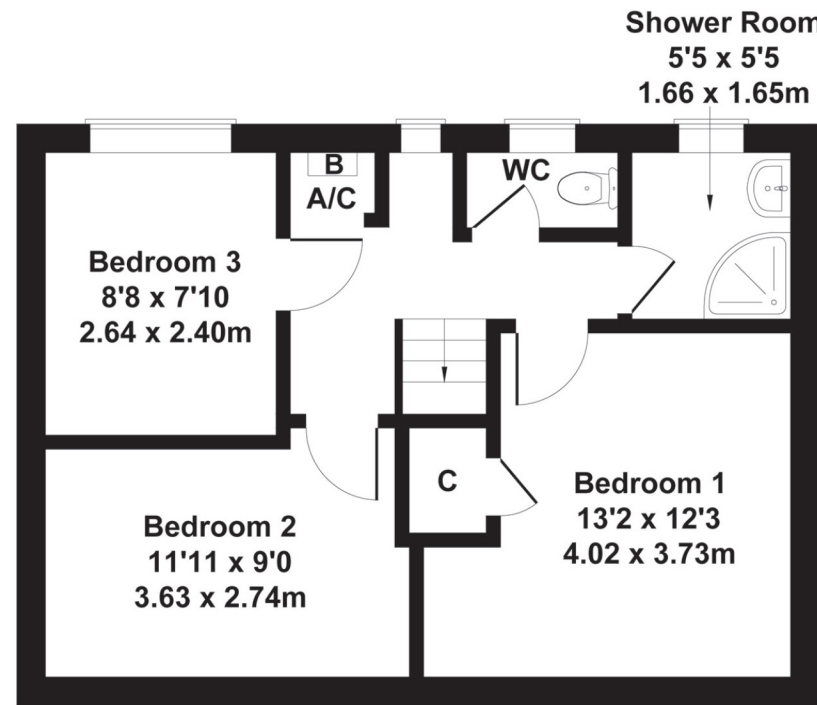

FIRST FLOOR

Not to Scale. Produced by The Plan Portal 2022
For Illustrative Purposes Only.



rightmove 
find your happy



See all our properties at
 **OnTheMarket.com**

IMPORTANT NOTICE:
THE CONSUMER PROTECTION REGULATIONS 2008 & THE BUSINESS PROTECTION FROM MISLEADING MARKETING REGULATIONS 2008. Please note that we have not tested any apparatus, equipment, fixtures, fittings or services, and so cannot verify they are in working order or fit for their purpose. The agent has not had sight of the Title documents. References to the tenure are based on information supplied by the seller. A buyer is advised to obtain verification from their solicitor or surveyor. Furthermore solicitors should confirm that items described in the sales particulars are included in the sale since circumstances can change during marketing or negotiations. A final inspection prior to exchange of contracts is also recommended. Although we try to ensure accuracy, measurements used in this brochure are approximate, and prospective purchasers should check the accuracy of the measurements themselves.