



Queen Street

Wilshere Court | Hitchin | Hertfordshire | SG4 9TT

www.stonegate-estates.co.uk



QUEEN STREET

Property Description

We are delighted to offer for sale this two double bed roomed first floor retirement property built by the highly regarded Pegasus Homes.

The apartment is situated within the town centre and therefore offers easy access to all local amenities that this delightful town has to offer,

There is a generous living room with a Juliet balcony, a fitted kitchen, two double bedrooms with fitted wardrobe, a refitted shower room and built in storage cupboards.

This well regarded development offers a communal lounge and laundry along with gardens to the front and rear. Parking is also to be found at the front and there is also the added benefit of a on site development manger.

Viewing is strongly recommended.

£325,000 Leasehold





Approximate Gross Internal Area
69.9 sq m / 752 sq ft

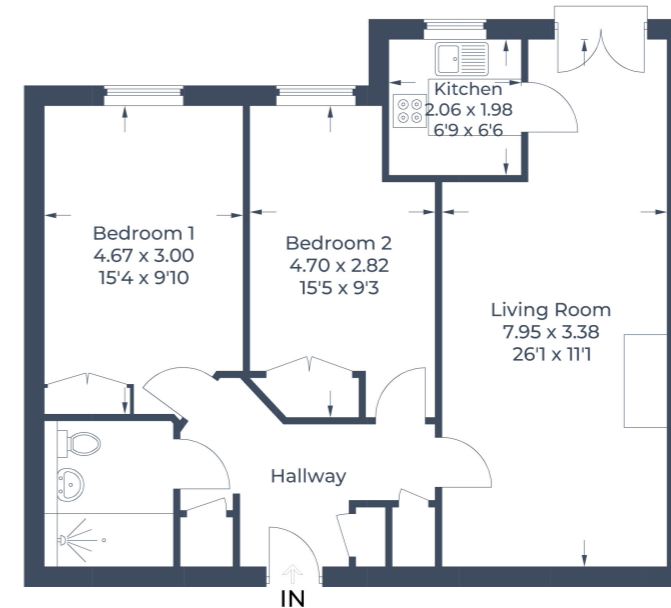

Illustration for identification purposes only,
measurements are approximate, not to scale.
© CJ Property Marketing Produced for Stonegates



- Two Bedroom Retirement Apartment
- Independent Living
- Residents lounge
- Town Centre Location
- Development Manager on Site
- Residents & Visitors Parking
- Gardens
- Refitted Shower Room
- Lift to all Floors

EPC Rating: B

Stonegate Estate Agents

01462 438979

sales@stonegate-estates.co.uk | www.stonegate-estates.co.uk

