

FOR SALE

Offers in Excess of £250,000

Meols Court, Meols Drive, Hoylake, Wirral. CH47 4AQ



No Onward Chain! This wonderful top floor apartment is situated on the prestigious Meols Drive and has fabulous views over the Royal Liverpool Golf Course as well being conveniently positioned nearby to the hustle and bustle of Market Street and Hoylake Train Station.





Ground Floor

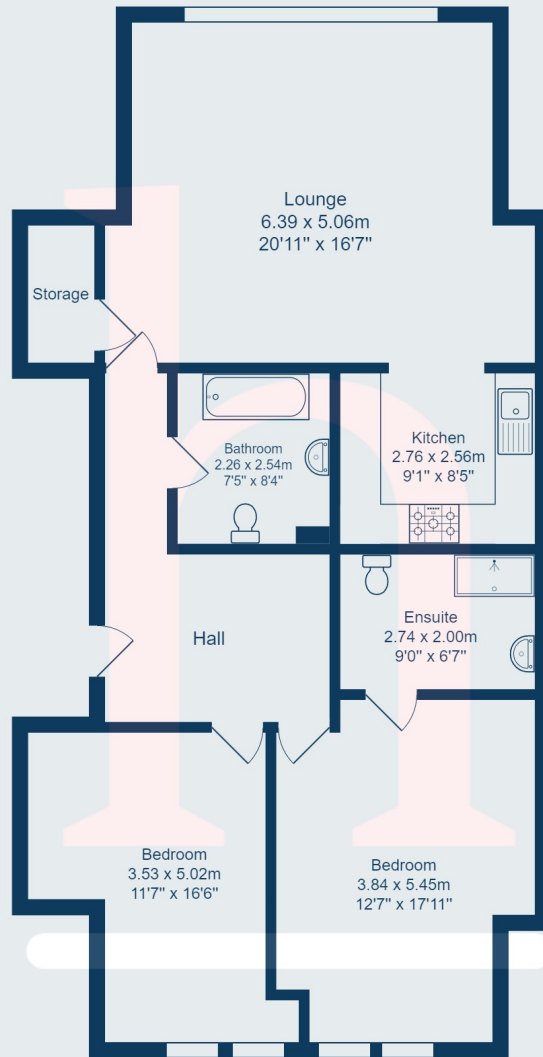

Total Area: 97.8 m² ... 1053 ft²

All measurements are approximate and for display purposes only.