



## 20 Rosehill Mews, Douglas, Isle of Man. IM2 2NA

Well presented, extended terraced home nestled within a popular residential location with sea views and low maintenance garden. Ideal for first time buyers or investors.



£259,500 Freehold

## PROPERTY DESCRIPTION

---

Manxmove are pleased to bring to market 20 Rosehill Mews, Farmhill.

This modern terraced home provides a great opportunity for first time buyers or investors, the property is offered with no onward chain and is ready to move straight into.

Situated within a popular residential cul-de-sac, it's close to schools, shops, business park and bus services.

On the ground floor you will find a spacious lounge with open aspect to front plus an extended kitchen/diner with French doors leading out to the garden. One of the stand out features within this property are the superb views over Douglas town centre towards the sea.

On the first floor are two large double bedrooms which are complimented by a three piece bathroom.

To the front of the property is a small easily maintained lawned garden. To the rear is a spacious and easily maintained area with gated access to rear which enjoys a good level of privacy.

**INCLUSIONS** Fitted carpets, curtains, blinds and light fittings.

**DISCLAIMER** Whilst Manxmove Ltd believe that these details are correct, neither Manxmove Ltd or their clients guarantee their accuracy in any way. Consequently, these details are not to be used to form part of any legally binding contract. Prospective purchasers or tenants are advised to visit this property to satisfy themselves as to the correctness of these details. Please note, we use wide angle camera lenses in order to show as much of each room as possible. This is not intended to mislead any prospective purchasers or tenants in any way and an honest verbal description is always available prior to viewing if required.

## FEATURES

---

- Modern Terraced Home
- Popular Residential Location
- Ideal for First Time Buyers and Investors
- Lounge plus Extended Kitchen
- 2 Double Bedrooms plus Bathroom
- Sea Views
- Low Maintenance Gardens
- No Onward Chain



# Property Images

---



# FLOORPLAN

GROUND FLOOR  
531 sq.ft. (49.4 sq.m.) approx.

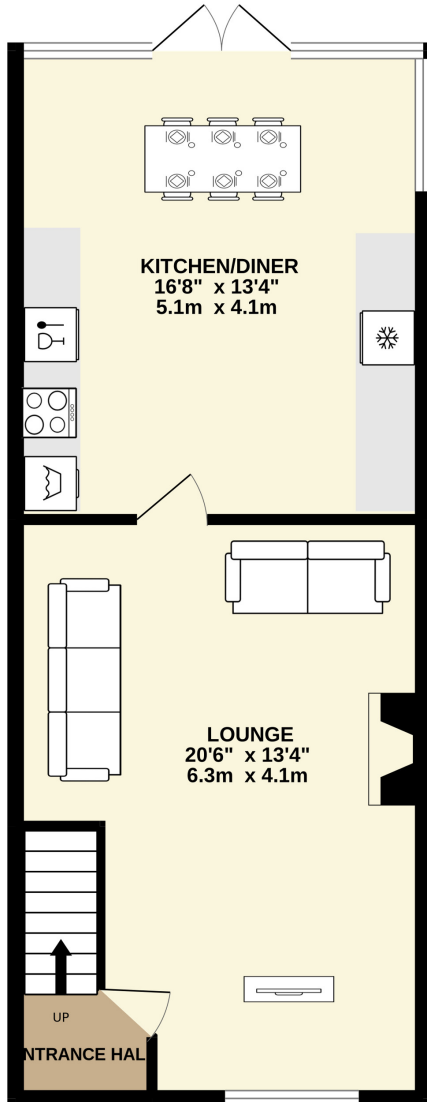

1ST FLOOR  
436 sq.ft. (40.5 sq.m.) approx.

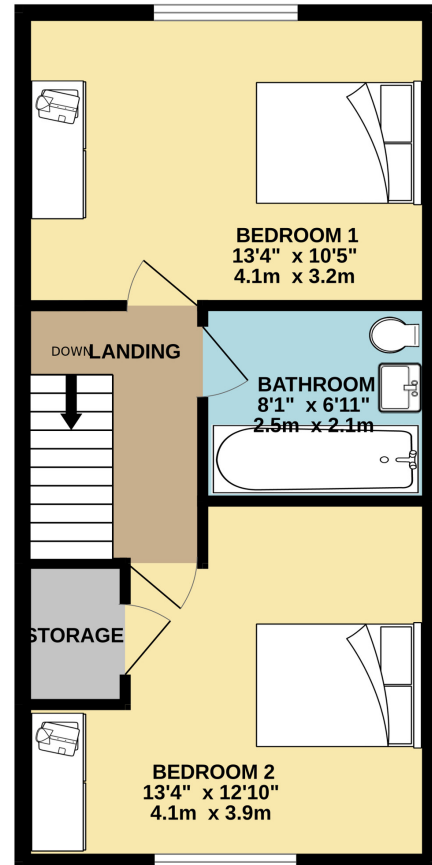

TOTAL FLOOR AREA : 967 sq.ft. (89.9 sq.m.) approx.

Whilst every attempt has been made to ensure the accuracy of the floorplan contained here, measurements of doors, windows, rooms and any other items are approximate and no responsibility is taken for any error, omission or mis-statement. This plan is for illustrative purposes only and should be used as such by any prospective purchaser. The services, systems and appliances shown have not been tested and no guarantee as to their operability or efficiency can be given.  
Made with Metropix ©2024

**DISCLAIMER:** Whilst Manxmove Ltd believe that these details are correct, neither Manxmove Ltd or their clients guarantee their accuracy in any way. Consequently, these details are not to be used to form part of any legally binding contract. Prospective purchasers or tenants are advised to visit this property to satisfy themselves as to the correctness of these details. Please note, we use wide angle camera lenses in order to show as much of each room as possible. This is not intended to mislead any prospective purchasers or tenants in any way and an honest verbal description is always available prior to viewing if required.