



8 Braehead, Cupar, Fife, KY15 4BE

Beautifully Presented & Spacious, Four Bedroom, Semi-Detached Home with Gardens & Driveway

Up to date price and viewing info at mov8realestate.com/property

éspc rightmove  Zoopla
find your happy

Property Description

Beautifully presented and spacious, four-bedroom, semi-detached family home, with gardens and driveway. Set in a quiet side street in the popular town of Cupar, an idyllic central Fife location.

Comprises an entrance hallway, living room, kitchen/dining room, four flexible double bedrooms and a family bathroom.

Highlights include a stylish kitchen and bathroom, updated internal doors, extensive contemporary flooring and modern lighting. In addition, there is modern gas central heating, double glazing and good storage provision.

Externally, there is low-maintenance landscaping to the front; whilst a generous terrace rear garden includes patios, a lawn and a storage shed.

A welcoming entrance hall features understair storage, and affords access throughout the majority of the ground floor and the stairs leading to the upper hall. Set to the front with a southerly aspect, the living features a large bay window allowing plentiful natural light, carpeted flooring and spotlighting. Set off the living room, the stylish kitchen affords access to the rear garden, whilst modern fitted units include stone effect worktops with matching splash backs and a sink with drainer; with appliances including an integrated oven and electric hob, and a freestanding fridge/freezer. Completing the ground floor, with wood effect flooring continuing from the hall, bedroom four offers a flexible space for a potential home office.

On the upper floor, bedroom one is set to the front with wood effect flooring and a central light fitting; whilst two further bedrooms are set to opposite aspects, similarly well-sized and finished with bedroom two featuring a fitted wardrobe with mirror sliding doors. Completing the accommodation, the bathroom is fitted with a modern three-piece suite including a mains mixer shower over the bath, and partially panelled and tiled splash walls.



8 Braehead, Cupar, KY15 4BE

Approximate Gross Internal Area: (1076 sq ft - 100 sq m.)

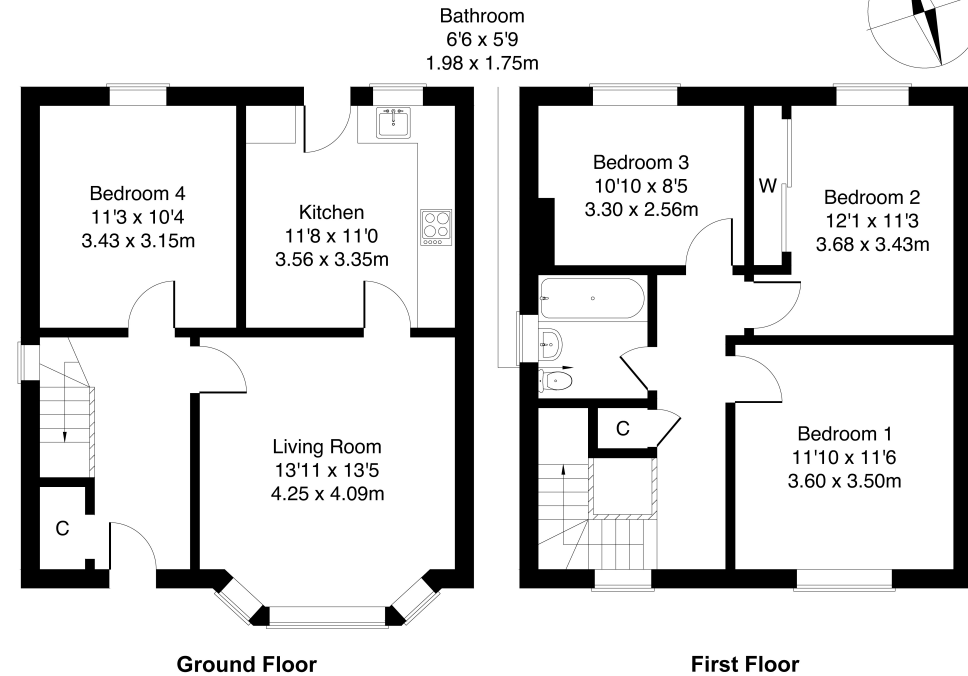
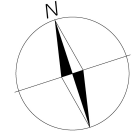

Legal Disclaimer : Floor-plan and measurements are for illustrative guidance only, and not intended to form part of any contract.

Area Description

Cupar is a thriving town in central Fife, situated between Dundee and Glenrothes, with a mixture of traditional and modern properties. Local amenities include the shopping streets of Crossgate and Bonnygate providing many high-street and local retail opportunities, as well as a post office, sports centre, and golf course. There is ample schooling provided from nursery level, with two primary

schools, and secondary education being provided by the well-known Bell Baxter High School. Cupar Railway Station is on the East Coast, Aberdeen to London line, allowing easy commuting to Edinburgh, Dundee and Perth, and due to its central location and regular bus services, Cupar is also ideally placed for travel to nearby St Andrews.





Our Services

- Free pre-sale property valuations
- Great value fixed estate agency fees
- Extensive buyer matching database
- Purchase and sale conveyancing

Contact Us

0345 646 0208

sales@mov8realestate.com

www.mov8.com

Head Office

6 Redheughs Rigg, Edinburgh, EH12 9DQ

Glasgow Office

77 Renfrew Street, Glasgow, G2 3BZ



Estate Agents and Solicitors

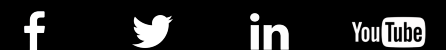

These particulars do not form part of any contract and the statements or plans contained herein are not warranted nor are they to scale. All descriptions, dimensions, areas, reference to condition and necessary permissions for use and occupation and other details are given in good faith, and are believed to be correct, but any prospective purchaser should not rely on them as statements or representations of fact, and any prospective purchaser must satisfy themselves by inspection or otherwise as to the correctness of each of them. The Seller shall not be bound to accept the highest or any offer nor to accept a full offer of the Fixed Price where this is applicable. Approximate measurements have been taken by sonic device and measurements are most often taken to the widest point of any room or space. Services and appliances have not been tested for efficiency or safety and no warranty is given as to their compliance with any Regulations. Offers should be made using the Combined Standard Clauses.