



4 Elliot Place, Glenrothes, Fife, KY6 1ER

Light & Beautifully Presented, Two-Bedroom, Mid-Terrace Home with Gardens

Up to date price and viewing info at [mov8realestate.com/property](https://www.mov8realestate.com/property)



Property Description

Light and beautifully presented, two-bedroom, mid-terrace home, with gardens. Set in a small quiet cul-de-sac, in a popular and family-orientated residential area of Glenrothes, Fife.

Comprises an entrance hall, living/dining, kitchen, two double bedrooms, and a family bathroom.

Highlights include a stylish fitted kitchen with appliances, a modern bathroom suite, and contemporary flooring. In addition, there is gas central heating, double glazing and good storage including bedroom stores and a loft.

Externally, there is a low-maintenance garden to the front, enclosed by tall privacy hedging; with a south-facing rear garden including brick-built store sheds, a patio, lawn and greenhouse.

The cul-de-sac offers unrestricted residential parking, with well-maintained communal green spaces adjacent.

A welcoming entrance hall affords access to the carpeted stairs leading to the upper hall, and throughout the ground floor, with understair storage space and a built-in storage cupboard. Enjoying a dual aspect allowing plentiful natural light, a spacious living room has wood effect flooring, two light fittings, and a fireplace. Set to the rear, with a door leading to the southerly-facing garden, the kitchen is fitted with modern units and worktops, a tiled surround, and a sink with a drainer; with freestanding appliances including a gas cooker, a fridge/freezer, a washing machine and a dishwasher.

On the upper floor, two well-finished and good-sized bedrooms, are set to opposite aspects, featuring wood effect flooring, central light fittings, and built-in wardrobe storage space. Completing the accommodation, a stylish bathroom is fitted with a modern three-piece suite including a rainfall shower over the bath and tiled splash walls.



4 Elliot Place, Glenrothes KY6 1ER

Approximate Gross Internal Area: (743 sq ft - 69 sq m.)

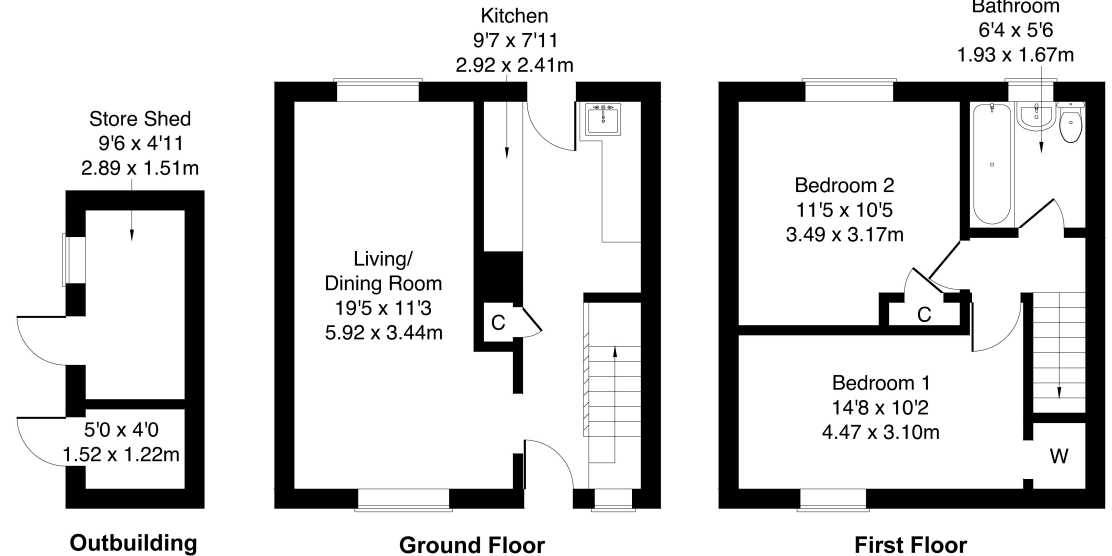
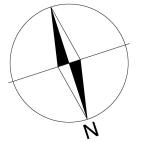

Legal Disclaimer : Floor-plan and measurements are for illustrative guidance only, and not intended to form part of any contract.

Area Description

Glenrothes is Fife's third largest town, with a mixture of residential properties throughout. Retail opportunities include the Kingdom Shopping Centre, with a broad range of high-street names, with supermarkets including an ASDA, ALDI, Lidl and Marks & Spencer. The Michael Woods Centre provides extensive modern sports and leisure facilities, whilst Glenrothes boasts its very own

18-hole golf course, cinema and theatre in the Rothes Halls. Both primary and secondary schooling are well provided for, with further education available at The Adam Smith College at the Stenton campus of Fife College. For the commuter, the A92 allows rapid access to Edinburgh and the central belt and there are railway stations at both Thornton and Markinch.





Our Services

- Free pre-sale property valuations
- Great value fixed estate agency fees
- Extensive buyer matching database
- Purchase and sale conveyancing

Contact Us

0345 646 0208

sales@mov8realestate.com

www.mov8.com

Head Office

6 Redheughs Rigg, Edinburgh, EH12 9DQ

Glasgow Office

77 Renfrew Street, Glasgow, G2 3BZ



Estate Agents and Solicitors

