

Truuli



Canterbury Road, Croydon, Surrey, CR0 3HD

£325,000 Freehold

- Victorian terrace
- Bright reception with lovely fireplace and beams on ceiling
- Generously sized private garden
- Walking distance to Mayday University hospital, shops, schools & transport
- Private garden

Canterbury Road, Croydon, Surrey, CR0 3HD

£325,000 Freehold

This delightful Victorian Terrace, situated on the sought-after Canterbury Road, effortlessly combines classic charm with contemporary comfort.

Featuring spacious rooms and a welcoming layout, this home is perfect for families, professionals, or investors.

Canterbury Road

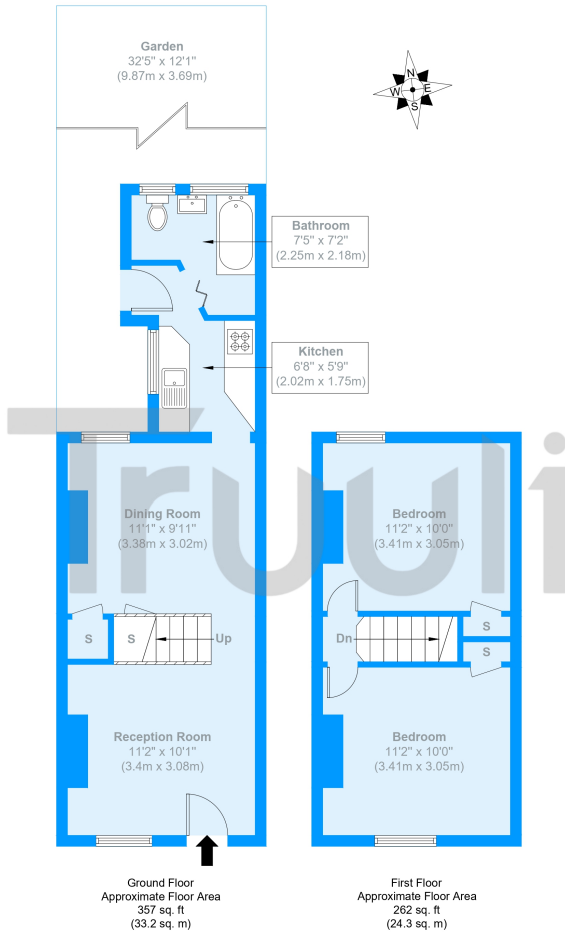

Approximate Gross Internal Area = 57.5 sq m / 619 sq ft

The Floor plan is not to scale and measurements and areas shown are approximate and therefore should be used for illustrative purposes only. The plan has been prepared in accordance with the RICS code of Measuring Practice and whilst we have confidence in the information produced it must not be relied on. Maximum lengths and widths are represented on the floor plan. If there is any aspect of particular importance, you should carry out or commission your own inspection of the property.
Copyright © BleuPlan

Energy Efficiency Rating		Current	Potential
Very energy efficient - lower running costs			
(92+)	A		
(81-91)	B		
(69-80)	C		76
(55-68)	D		
(39-54)	E	40	
(21-38)	F		
(1-20)	G		
Not energy efficient - higher running costs			
England, Scotland & Wales		EU Directive 2002/91/EC	

