



**Cheney Court
Husbands Bosworth
Lutterworth
Leicestershire
LE17 6LX**

Offers in Excess of £123,000

bettermove

Cheney Court Lutterworth

Bettermove are proud to present this 2 bedroom flat in the sought after area of Husbands Bosworth.

The property benefits from double glazing, electric heating throughout and has off street parking available via an allocated parking space. The council tax band is B.

This is a leasehold property with 108 years remaining on the lease; the ground rent is £12.50 per month, the service charge is £84.67 per month and the building insurance is £131.92 per annum.

The interior of this well presented property situated on the first floor of the building briefly comprises a spacious living room, fitted kitchen, two bedrooms and the family bathroom. on the ground floor. The exterior boasts a communal garden, perfect for enjoying the summer months.

Located in the popular village of Husbands Bosworth, the property is close to a range of amenities, including shops, restaurants and pubs. Excellent transport connections can be found from the M1, the A14 and many local bus routes.

This exciting opportunity should not be missed! All enquiries can be made through Bettermove on 0330 004 0050.



Ground Floor

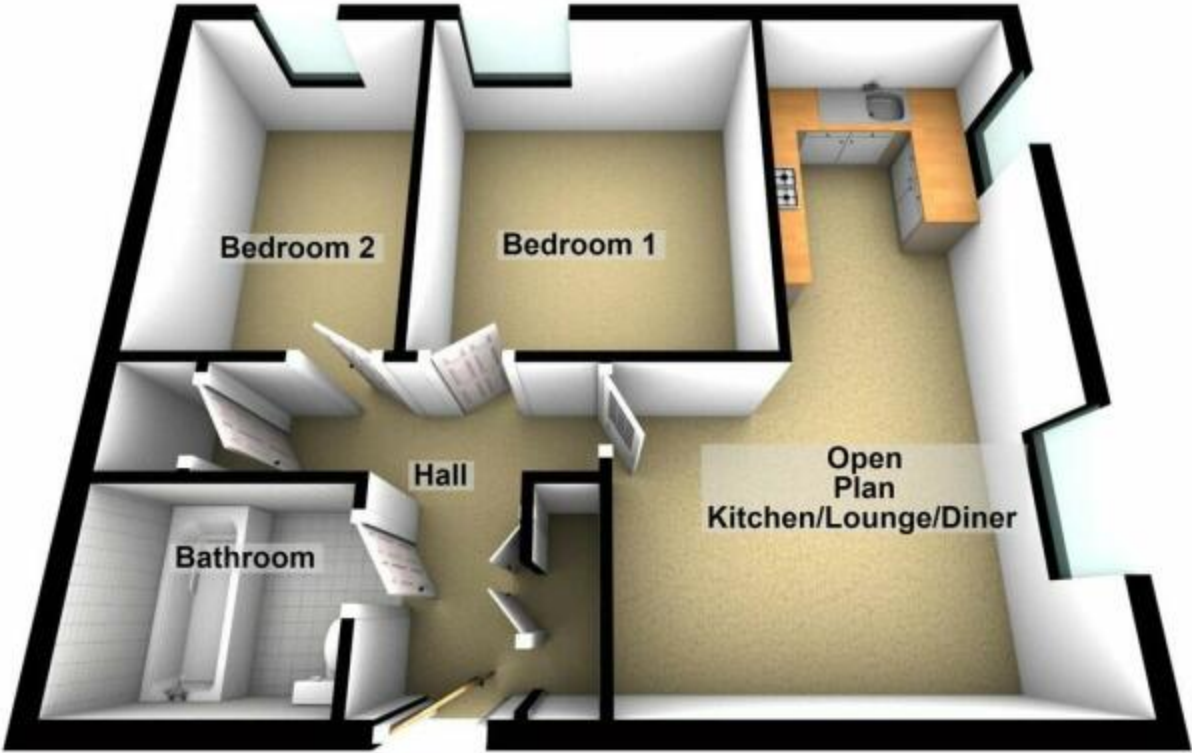

Energy Efficiency Rating		
	Current	Potential
<i>Very energy efficient - lower running costs</i>		
(92+) A		
(81-91) B	82	82
(69-80) C		
(55-68) D		
(39-54) E		
(21-38) F		
(1-20) G		
<i>Not energy efficient - higher running costs</i>		
England, Scotland & Wales	EU Directive 2002/91/EC	



20-22 Bridge End, Leeds, LS1 4DJ
t: 0330 004 0050 e: hello@bettermove.co.uk
www.bettermove.co.uk