



RETIREMENT PROPERTIES  
For Sale/Rent  
0333 321 4075



**4 Perrin Court, Parkland Grove, Ashford, Surrey TW15 2GA**  
**£209,950 - Leasehold**



## PROPERTY DESCRIPTION

Situated in the heart of Ashford with easy access to everything, this ground floor one double bedroom apartment has doors leading to communal gardens. The accommodation comprises a hallway, a living room, kitchen with built in oven and hob, shower room, and a double bedroom, with fitted wardrobes. The communal areas include attractive gardens, ample parking, a large residents' lounge, laundry room, and a guest suite for the use of visitors, the apartment also has the benefit of an on site house manager, emergency pull cords or buttons in all rooms. Viewings are highly recommended.

## POINTS OF INTEREST

- TOWN CENTRE LOCATION
- NO ONWARD CHAIN
- ACCESS TO COMMUNAL GARDENS
- PARKING
- WALK IN SHOWER
- CLOSE TO LOCAL BUS ROUTES





GROUND FLOOR  
497 sq.ft. (46.2 sq.m.) approx.

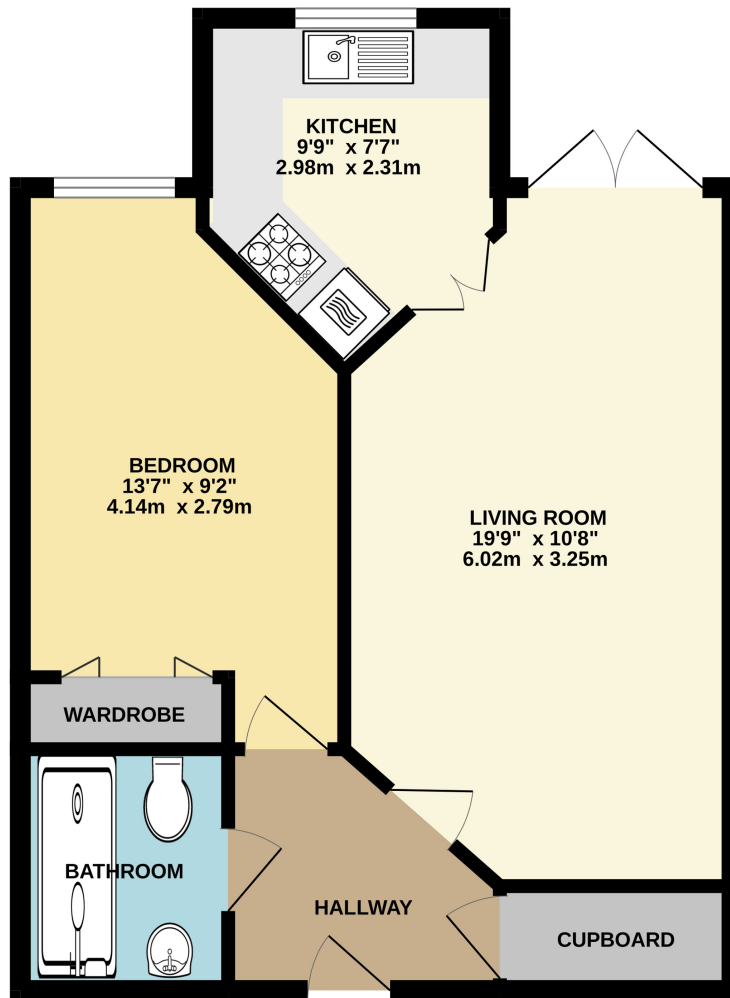

TOTAL FLOOR AREA : 497 sq.ft. (46.2 sq.m.) approx.

Whilst every attempt has been made to ensure the accuracy of the floorplan contained here, measurements of doors, windows, rooms and any other items are approximate and no responsibility is taken for any error, omission or mis-statement. This plan is for illustrative purposes only and should be used as such by any prospective purchaser. The services, systems and appliances shown have not been tested and no guarantee as to their operability or efficiency can be given.  
Made with Metropix ©2024