



Bensham Lane, Croydon, Surrey, CR0 2RY

£550,000 Freehold

- End of terrace Victorian home
- Arranged over three floors
- Balcony to master bedroom
- Many original features including fireplaces
- Formal reception & 21" reception
- Private garden with generous side return
- No onward chain

Bensham Lane, Croydon, Surrey, CR0 2RY

£550,000 Freehold

Situated in a popular and sought-after residential location, this elegant Victorian semi-detached home is a true gem.

Lovingly maintained and cherished by its current owners for many years, the property exudes timeless charm and character. It boasts a wealth of original period features – including high ceilings, ornate cornicing, and original fireplaces – all thoughtfully blended with modern comforts to create a warm and inviting family home.

Bensham Lane

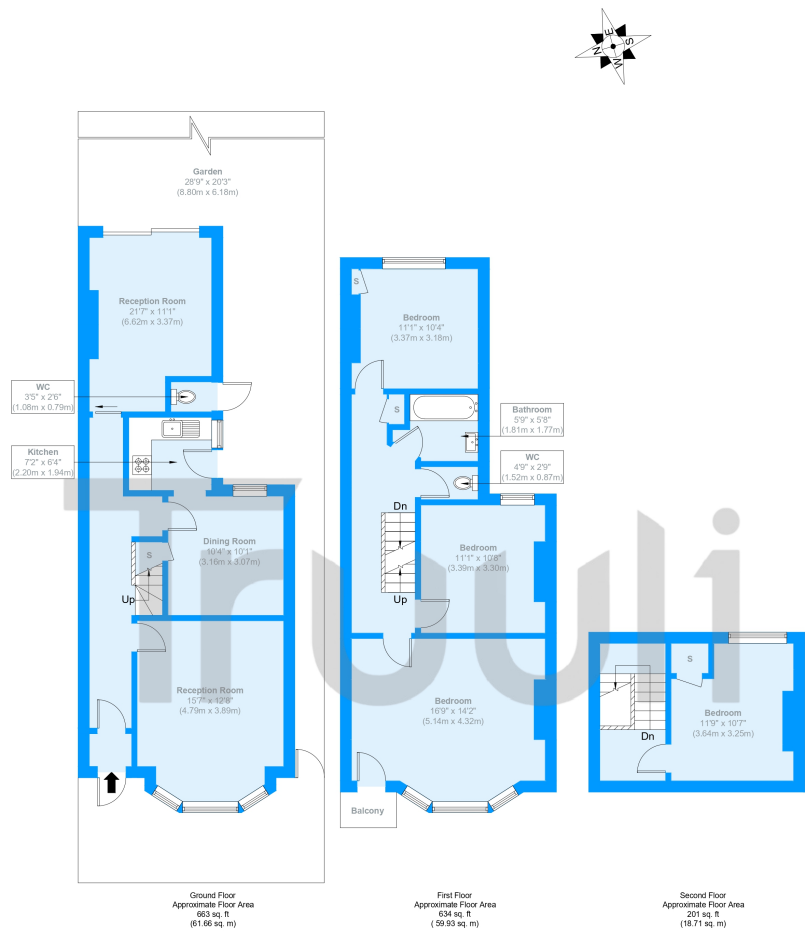

Approximate Gross Internal Area = 140.3 sq m / 1510 sq ft

The Floor plan is not to scale and measurements and areas shown are approximate and therefore should be used for illustrative purposes only. The plan has been prepared in accordance with the RICS code of Measuring Practice and whilst we have confidence in the information produced it must not be relied on. Maximum lengths and widths are represented on the floor plan. If there is any aspect of particular importance, you should carry out or commission your own inspection of the property.
Copyright © Bleuplan

