



**Flat 24 Hawthorn Gardens, The Hawthorns,
Caerleon, Newport. NP18 1NX
£165,000
Tenure Leasehold**

- WELL MAINTAINED, LARGER THAN AVERAGE, 1ST FLOOR APARTMENT
- PLEASANT OUTLOOK OVER WELL KEPT GARDENS
- COMMUNAL ENTRANCE WITH LIFT
- ENTRANCE HALL WITH STORAGE
- BRIGHT LOUNGE/DINER OPEN TO A REFITTED KITCHEN
- 2 BEDROOMS
- DRESSING ROOM & EN-SUITE SHOWER ROOM
- FAMILY BATHROOM
- ALLOCATED PARKING
- NO CHAIN

Situated just off the Usk Road, within easy access of Caerleon Village this well presented, larger than average, 2 bedroom apartment enjoys a pleasant outlook over well kept communal gardens and is offered for sale with no chain.

In brief the accommodation comprises:

A communal hallway with staircase and lift to all floors.

To the first floor: An entrance hall with security intercom. A lounge/diner overlooks the pleasant gardens with open arch leading to the kitchen having part tiled walls.

The master bedroom benefits from a walk in wardrobe and en-suite shower room the second bedroom having a built in wardrobe.

A bathroom leads off the main hall with shower over bath and part tiled walls.

Outside: The property occupies well maintained communal grounds having allocated parking

Services:

Council Tax Band:

D



Approx Gross Internal Area
54 sq m / 577 sq ft

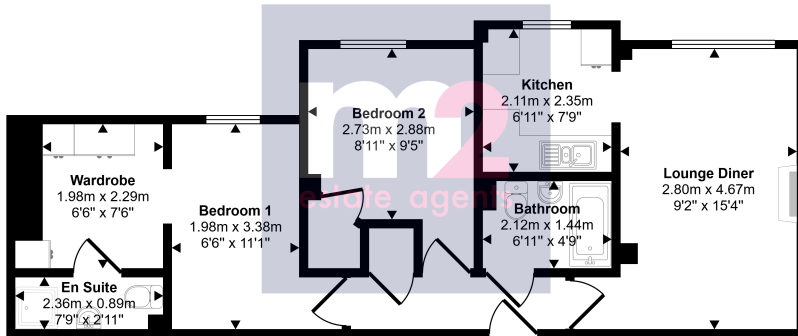

Floorplan

This floorplan is only for illustrative purposes and is not to scale. Measurements of rooms, doors, windows, and any items are approximate and no responsibility is taken for any error, omission or mis-statement. Icons of items such as bathroom suites are representations only and may not look like the real items. Made with Made Snappy 360.

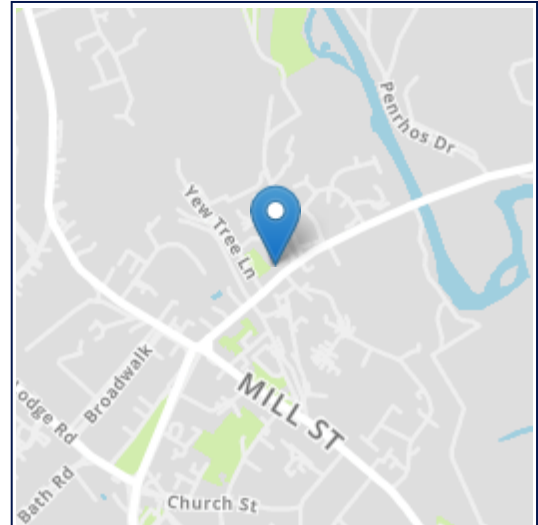

All room sizes are approximate. Electrical installations, plumbing, central heating and drainage installations are noted on the basis of a visual inspection only. They have not been tested and no warranty of condition or fitness for purpose is implied in their inclusion. Potential purchasers are warned that they must make their own enquiries as to the condition of the appliances, installations or any element of the structure or fabric of the property.

M2 Estate Agents for themselves and for the Vendors and Lessors of this property whose agents they are give notice that, (i) the particulars are set out as a general outline only for the guidance of the intended Purchasers or Lessors, and do not constitute part of an offer or contract (ii) all descriptions, dimensions, reference to condition and necessary permissions for the use and occupation and other details are given without responsibility and any intending Purchasers or Tenants should not rely on them as statements or representations of fact but satisfy themselves by inspection or otherwise as to the correctness of each of them (iii) no person in the employment of M2 Estate Agents has any authority to make or give any representation or warranty whatever in relation to this property.

I/We acknowledge that I/we have read and understand your terms letter and that these property (Flat 24 The Hawthorns, Newport, NP18 1NX) details have been checked and:

Are Correct

Are Correct with Attached Amendments

Signature _____ Print Name _____

Date _____

Signature _____ Print Name _____

Date _____