

The Glebe

Salisbury, SP3 4NJ

COOPER
AND
TANNER



£299,950 Freehold

A rare opportunity to acquire this three bedroom mid terrace house set in the sought after village of Steeple Langford set in the Wylde Valley and is close to the well known Langford Lakes. The property offers good sized accommodation and would make an ideal family home. There is a driveway with parking for several cars and a good sized enclosed rear garden. Early viewing is highly recommended.

The Glebe

Salisbury

SP3 4NJ

 3  1  1 EPC E

£299,950 Freehold

DESCRIPTION

A three bedroom mid terrace house offering good size family accommodation set in the popular village of Steeple Langford close to the well know Langford Lakes. . The property offers good sized accommodation and would make an ideal family home. The property has an entrance porch , hallway, a large extended kitchen/breakfast room which is fully fitted with wall and base units and has a rayburn, an extended Lounge/dining room with a fireplace and has patio doors to the rear garden, a downstairs cloakroom, sun room and a workshop. Leading upstairs there are three bedrooms and a family bathroom.

OUTSIDE

The property is approached over a driveway which offers parking for four cars also there are various plants and shrubs. There is a side access which leads through to the back of the property. A particular feature is the rear garden which is full of borders well stocked with established plants and shrubs. There is a patio area , a lawned area and the whole garden is privately enclosed. The garden benefits from views across to a paddock beyond.

LOCATION

Hanging Langford is set in the popular Wylde Valley and is best known as the home to Langford Lakes Nature Reserve where there are lovely walks. The village is also popular with cyclists. There is a Doctors surgery close by in Codford and Wilton. The village is located off the main A36 which gives you easy access to Salisbury, Wilton and Warminster town.

COUNCIL TAX BAND

BAND C





The Glebe, Steeple Langford, Salisbury, SP3

Approximate Area = 1418 sq ft / 131.7 sq m

For identification only - Not to scale

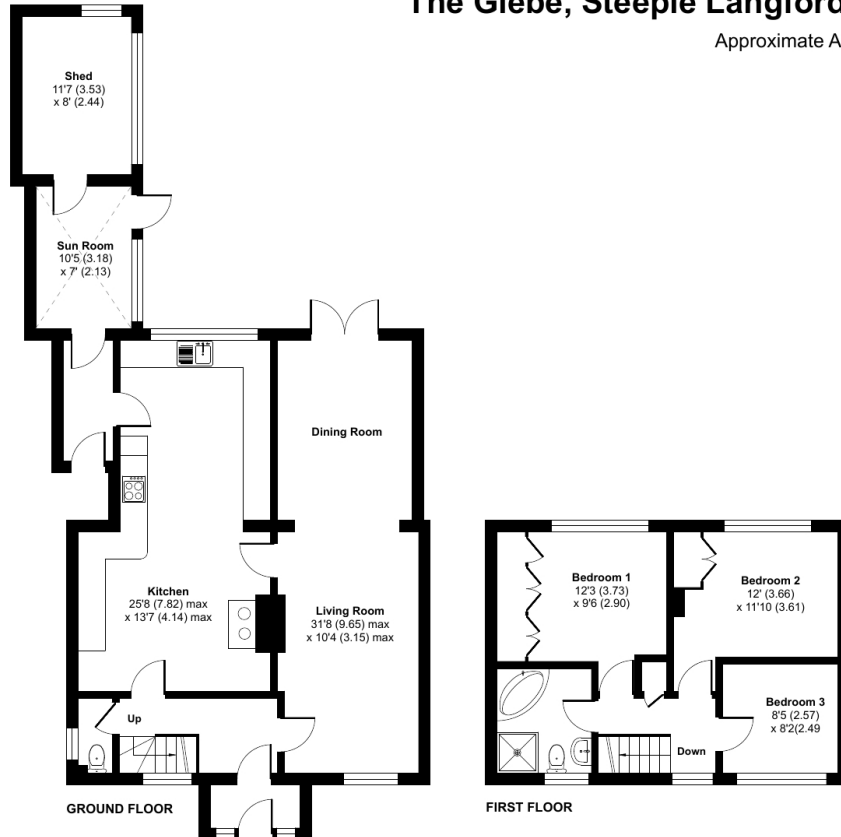

Floor plan produced in accordance with RICS Property Measurement Standards incorporating International Property Measurement Standards (IPMS2 Residential). © nitchecom 2023. Produced for Cooper and Tanner. REF: 964572

WARMINSTER OFFICE

Telephone 01985 215579

48-50, Market Place, Warminster, Wiltshire BA12 9AN

warminster@cooperandtanner.co.uk

**COOPER
AND
TANNER**

Important Notice: These particulars are set out as a general outline only for the guidance of intended purchasers and do not constitute, nor constitute part of, an offer or contract. All descriptions, dimensions, reference to condition and necessary permissions for use and occupation, warranties and other details are given without responsibility and any intending purchasers should not rely on the m as statements or representations of fact but must satisfy themselves by inspection or otherwise as to the correctness of each of them.

