



5 Erlensee Way, Biggleswade, Bedfordshire, SG18 8GG

£384,995

COME AND VIEW THIS FOUR BEDROOM end of terrace property situated on the popular Kings Reach development and offers SPACIOUS well designed accommodation on three levels. Downstairs cloakroom, lounge, kitchen/dining room, four bedrooms, en-suite to master, family bathroom, front and rear gardens and off road parking for one car. An internal viewing is highly recommended.



- 4 BEDROOM END OF TERRACE
- SITUATED ON THE POPULAR KINGS REACH DEVELOPMENT
- OVER 1200 SQ FT OF ACCOMMODATION
- NO CHAIN
- KITCHEN/DINING ROOM
- LOUNGE
- BALCONY
- MASTER BED WITH EN SUITE
- REAR GARDEN - NOT OVERLOOKED
- CAR PORT /PARKING SPACE

### 5 Erlensee Way, Biggleswade

Approximate Gross Internal Area  
1216 sq ft - 113 sq m

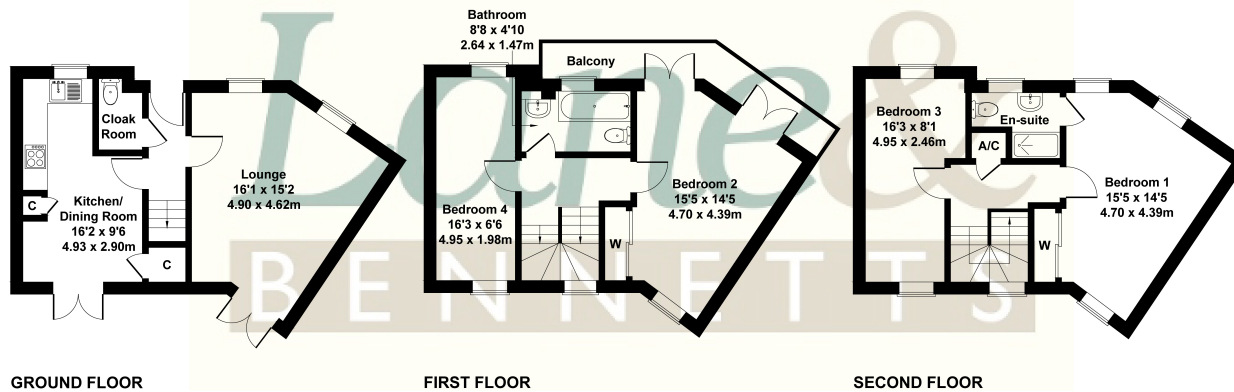

Not to Scale. Produced by The Plan Portal 2023  
For Illustrative Purposes Only.

