



56 Clifton Road, Henlow, Bedfordshire, SG16 6BL

£400,000

Three bedroom semi-detached property situated in a private close of just two houses backing and siding onto fields. Although in need of some updating the property offers great potential with room to extend to the side and rear (subject to planning). Offered with two reception rooms, kitchen, two double and one single bedroom plus bathroom and is situated on a mature plot with outbuildings. Off road parking is provided by a carport and driveway. This is the first time this property has ever come to the market.



## 56 Clifton Road Henlow

Approximate Gross Internal Area  
893 sq ft - 83 sq m

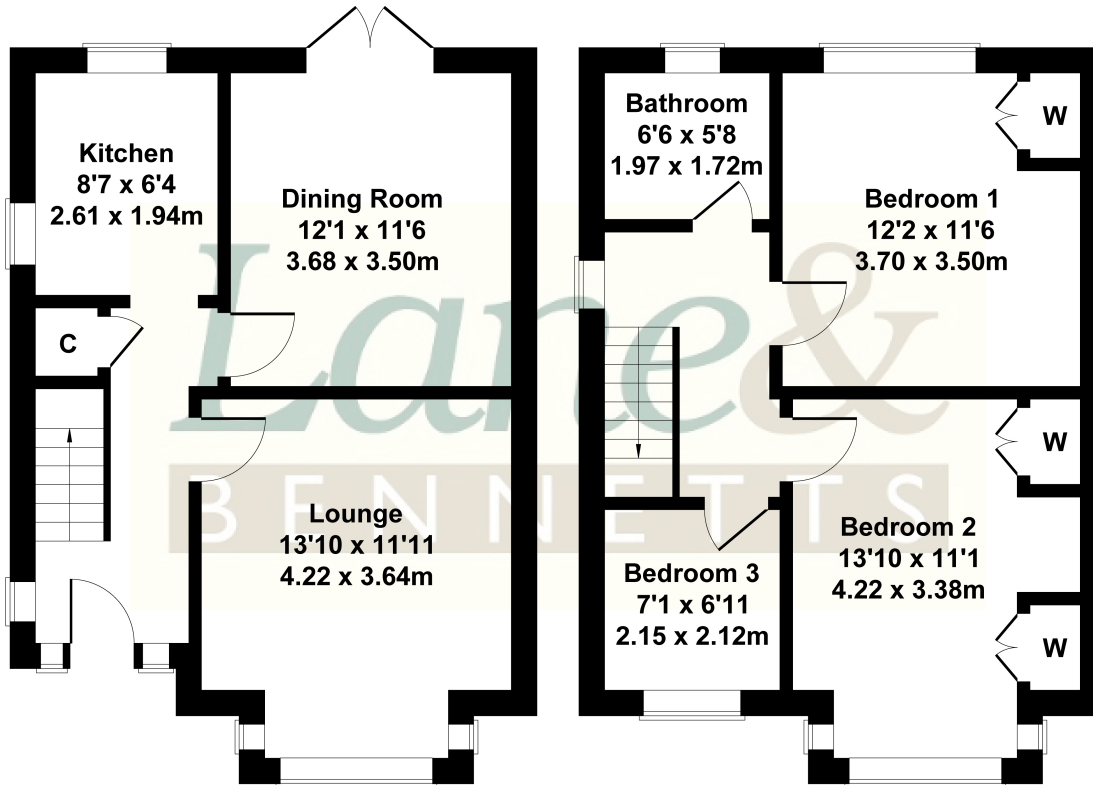

**GROUND FLOOR**

**FIRST FLOOR**

Not to Scale. Produced by The Plan Portal 2024  
**For Illustrative Purposes Only.**

- FIRST TIME THIS PROPERTY HAS EVER COME TO THE MARKET
- THREE BEDROOM SEMI DETACHED HOME
- IN NEED OF SOME UPDATING & MODERNISATION
- GREAT POTENTIAL TO IMPROVE/EXTEND (SUBJECT TO PLANNING)
- PRIVATE CLOSE OF 2 HOUSES
- OFF ROAD PARKING + CAR PORT
- BACKS AND SIDES ONTO COUNTRYSIDE
- CATCHMENT FOR "GOOD" SCHOOLS
- EASY ACCESS TO A1 & ARLESEY TRAIN STATION

