



 1  1  1 EPC C

£95,000 Leasehold

16 The Pennings
Axbridge
BS26

COOPER
AND
TANNER



16 The Pennings

Axbridge

BS26

 1  1  1 EPC C

£95,000 Leasehold

This delightful top floor retirement apartment for the over 55's offers one good size double bedroom with lovely views, is located just a short stroll from facilities and is offered with no onward chain!

Communal entrance hall Approached via an internal communal hallway with easy to manage low rising stairs which also have the benefit of a Stannah stair lift. The communal areas within The Pennings are well decorated and include a small residents lounge for meeting and greeting guests on a ground floor level.

LOUNGE/DINER 21' 3" x 10' 0" (6.48m x 3.05m) Wooden double glazed window to the front elevation offering glorious south facing views over the countryside. Wall mounted storage heater. Television and telephone points.

KITCHEN 7' 3" x 7' (2.21m x 2.13m) Range of wall and base units with roll edge work surfaces over and a stainless steel one and a quarter bowl sink unit inset. Tiled splash backs. Built in oven. Four ring electric hob with extractor hob over. Built in washer/dryer. Built in fridge/freezer. Smoke alarm.

BATHROOM 8' 8" x 7' (2.64m x 2.13m) Bath with electric shower over and shower screen. Tiled splash

backs. Low level WC. Pedestal wash basin. Wall mounted light and shaver point. Wall mounted

heater. Extractor fan. Airing cupboard housing the hot water tank.

BEDROOM 16' 10" x 9' 6" (5.13m x 2.9m) Rear aspect UPVC double glazed window. Domed ceiling. Smoke alarm. Storage heater. Television point. Ceiling light.

COMMUNAL AREA The development has been constructed with the relevant security very much in mind and is approached by electric gates to the side with a sweeping tarmac off road driveway. To the rear there are allocated parking spaces and this apartment has a numbered space for its sole use. There are landscaped gardens to the side and front and a recessed dustbin area.

Local Information Axbridge

Local Council: Sedgemoor

Council Tax Band: A

Heating: Storage Heaters

Tenure: Leasehold



Motorway Links

- M5 J21
- M5 J22



Train Links

- Worle
- Burnham & Highbridge



Nearest Schools

- Axbridge COE First School
- Kings of Wessex

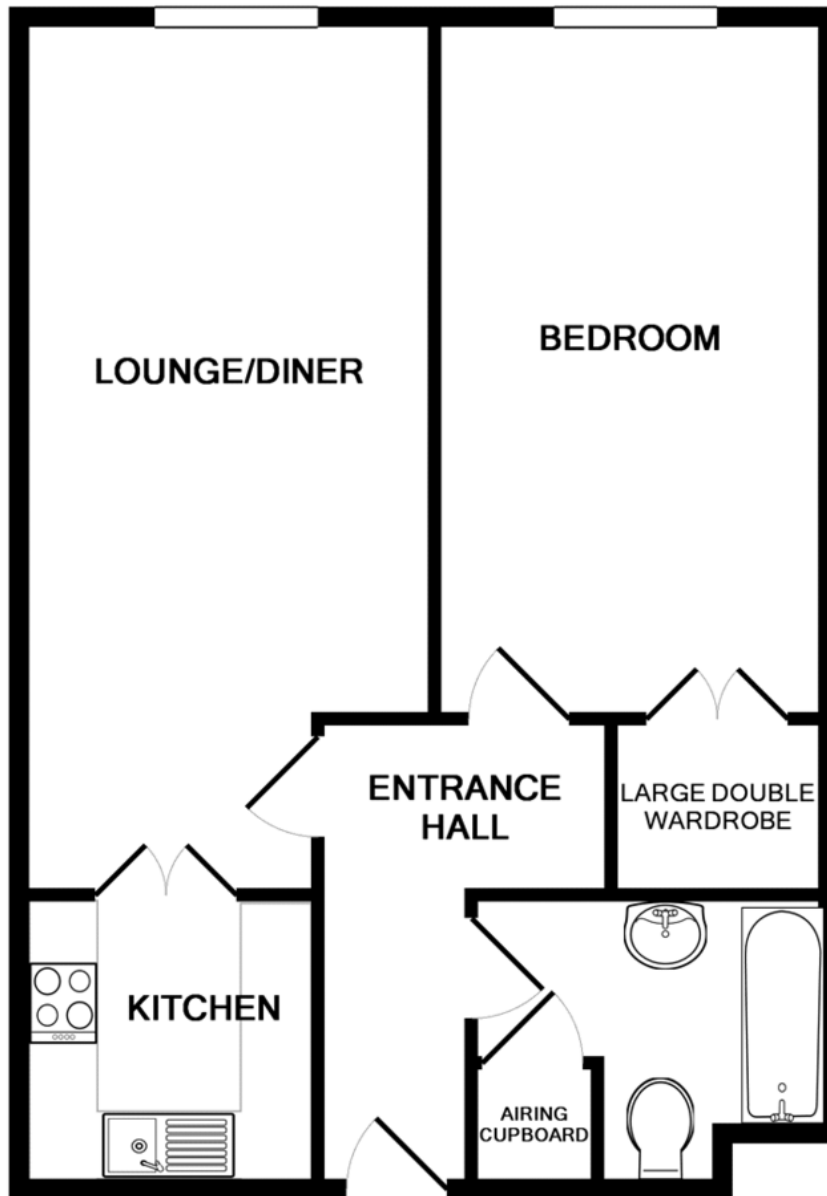

Whilst every attempt has been made to ensure the accuracy of the floor plan contained here, measurements of doors, windows, rooms and any other items are approximate and no responsibility is taken for any error, omission, or mis-statement. This plan is for illustrative purposes only and should be used as such by any prospective purchaser. The services, systems and appliances shown have not been tested and no guarantee as to their operability or efficiency can be given
 Made with Metropix ©2011

CHEDDAR OFFICE

telephone 01934 740055

2 Saxon Court, Union Street, Cheddar, Somerset BS27 3NA

cheddar@cooperandtanner.co.uk

**COOPER
AND
TANNER**

Important Notice: These particulars are set out as a general outline only for the guidance of intended purchasers and do not constitute, nor constitute part of, an offer or contract. All descriptions, dimensions, reference to condition and necessary permissions for use and occupation, warranties and other details are given without responsibility and any intending purchasers should not rely on them as statements or representations of fact but must satisfy themselves by inspection or otherwise as to the correctness of each of them.

