





8 Canterbury Court, Chaucer Road, Ashford, Surrey TW15 2PT
£209,950 - Leasehold



PROPERTY
DESCRIPTION

Ground floor one bedroom maisonette situated in Ashford town centre with Ashford train station (Waterloo 35 min) and local amenities within easy walking distance. This one bedroom ground floor apartment benefits from communal gardens and parking to the rear, a great investment opportunity or first time purchase.

POINTS OF
INTEREST

- Town centre location
- Ground Floor
- Close to station
- One bedroom maisonette
- Parking
- Communal gardens





GROUND FLOOR

360 sq.ft. (33.5 sq.m.) approx.

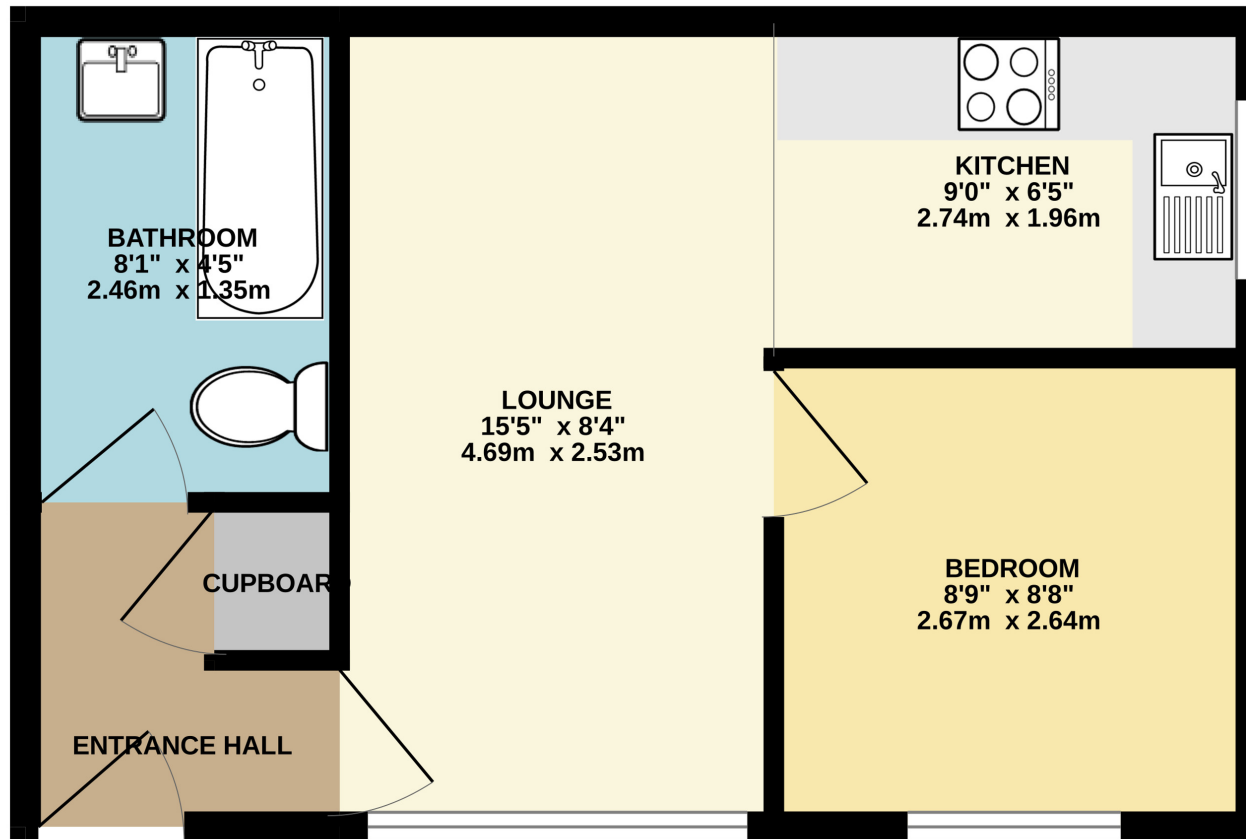

TOTAL FLOOR AREA : 360 sq.ft. (33.5 sq.m.) approx.

Whilst every attempt has been made to ensure the accuracy of the floorplan contained here, measurements of doors, windows, rooms and any other items are approximate and no responsibility is taken for any error, omission or mis-statement. This plan is for illustrative purposes only and should be used as such by any prospective purchaser. The services, systems and appliances shown have not been tested and no guarantee as to their operability or efficiency can be given.
Made with Metropix ©2024