



Wensleydale Close,
Sneyd Green



OneAgency

01782 970222

hello@oneagencygroup.co.uk



£745 pcm

Semi detached house, situated in the popular location of Sneyd Green, convenient for Hanley city centre, Festival Park and the A53. The property benefits from an en suite to the master bedroom, off road parking and rear garden with patio area. Viewing is recommended.





ENTRANCE LOBBY

Door to side, radiator, tiled floor, stairs to first floor.

KITCHEN

2.62m x 2.64m (8' 7" x 8' 8") Double glazed window to the front, radiator, tiled floor,, fitted with a range of wall, base and drawer storage units, fitted oven and hob with extractor fan above, plumbing for automatic washing machine, stainless steel sink and drainer unit with mixer tap, plumbing for dishwasher, double glazed window to the front.

FAMILY ROOM

2.27m x 4.67m (7' 5" x 15' 4") Double glazed window to the front, radiator.

LOUNGE/DINER

5.21m x 3.58m (17' 1" x 11' 9") Sliding patio doors to the rear, double glazed window to the rear, gas fire with feature surround, laminate floor, radiator.

LANDING

Radiator, airing cupboard, access to loft.

MASTER BEDROOM

3.99m x 2.70m (13' 1" x 8' 10") Double glazed window to front, radiator.

EN SUITE

Double glazed frosted window to the front, shower cubicle with electric shower, WC, hand wash basin, part tiled walls, radiator.

BEDROOM TWO

3.07m x 2.63m (10' 1" x 8' 8") Radiator, double glazed window to the rear.

BEDROOM THREE

2.07m x 2.63m (6' 9" x 8' 8") Radiator, double glazed window to the rear.

BATHROOM

White bathroom suite comprising of panelled bath, WC and hand wash basin. Part tiled walls, radiator, double glazed frosted window to the side.

OUTSIDE

Off road parking. Garden and patio area to the rear.



All contents, positioning & measurements are approximate and for display purposes only
Plan produced by Thorin Creed

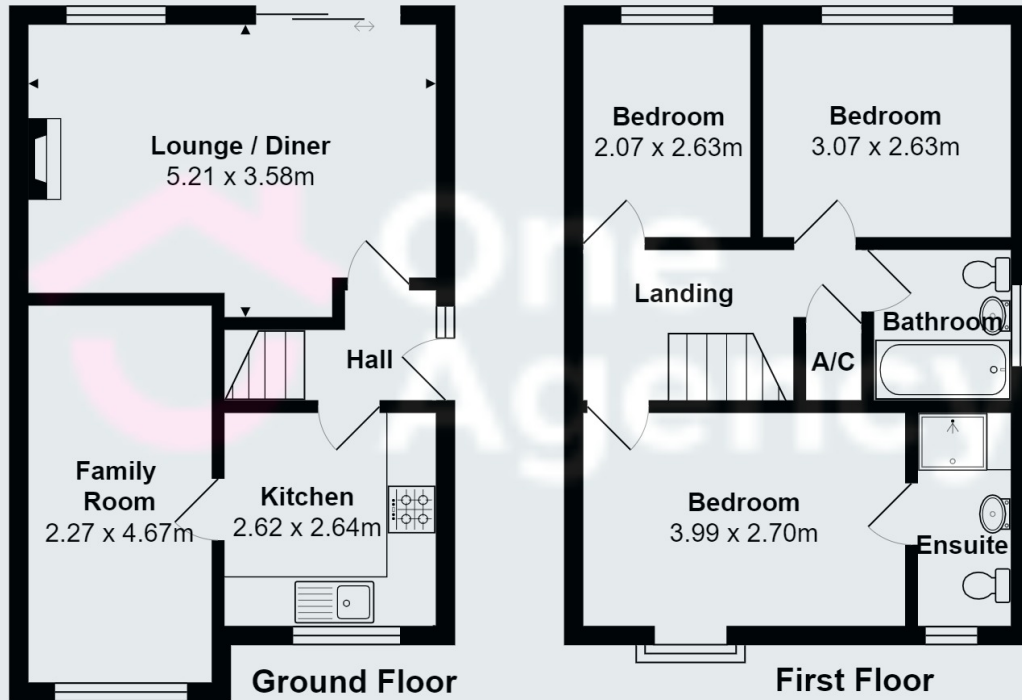

Total Area: 80.0 m²



OneAgency, 9 & 10 Ridge House Drive, Festival Park, Stoke-on-Trent, ST1 5SJ

01782 970222

hello@oneagencygroup.co.uk

Every attempt has been made to ensure accuracy, however, all measurements are approximate and for illustrative purposes only. **Not to scale.**

In accordance with The Consumer Protection from Unfair Trading Regulations 2008 the following particulars have been prepared in good faith and they are not intended to constitute part of an offer or contract. We have not carried out a structural survey and the services, appliances and specific fittings have not been tested. All photographs, measurements, floor plans and distances referred to are given as a guide only and should not be relied upon for the purchase of carpets or any other fixtures and fittings. Lease details, service charges and ground rent (where applicable) are given as a guide only and should be checked and confirmed by your Solicitor prior to exchange of contracts.