



Wratten Road West

Hitchin | Hertfordshire | SG5 2EJ

www.stonegate-estates.co.uk



WRATTEN ROAD WEST

Property Description

This immaculately presented, nearly new ground floor apartment offers very spacious, light and airy accommodation in the recently built and exclusive Churchill Development close to the town centre.

The accommodation benefits from high specification fittings throughout including a cupboard off the entrance hall, a fully fitted kitchen with built-in appliances, a good size lounge with a door to its own patio area which overlooks one of the communal gardens, a very good size double bedroom with a walk-in wardrobe offering ample shelving and hanging space. The shower room has fitted cupboards and vanity unit and a walk-in glass shower cubicle.

Other benefits include the communal lounge area and kitchen and very well stocked and kept communal gardens to enjoy and parking for residents.

Dovehouse Lodge is managed by Millstream Management Services and works closely with Churchill Retirement Living who built the development and provides a manager on site 5 days a week as well as a 24 hours, 365 days a year service by the Careline team.

Rarely available as a re-sale apartment we strongly recommend a viewing of this beautiful apartment.

£375,000 Leasehold



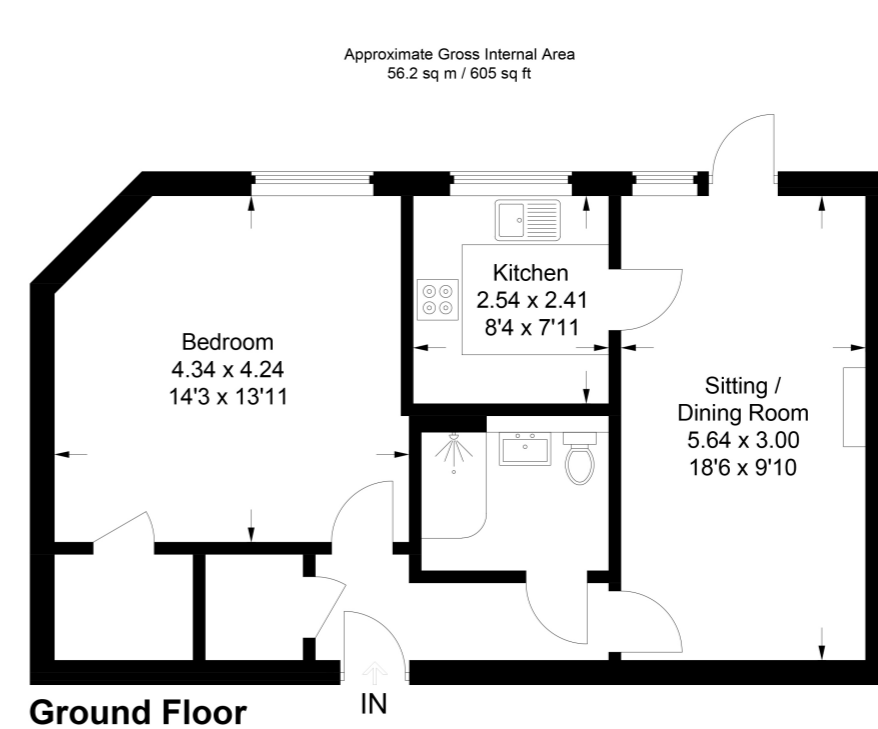

This plan is for layout guidance only. Not drawn to scale unless stated. Windows and door openings are approximate. Whilst every care is taken in the preparation of this plan, please check all dimensions, shapes and compass bearings before making any decisions reliant upon them.
© CJ Property Marketing Ltd



- Town Centre Location
- One Bedroom Retirement Apartment
- Ground Floor
- Immaculately Well Presented
- Over Looking Gardens
- Residents Lounge
- Door onto Garden
- Well Appointed Kitchen

EPC Rating:

Stonegate Estate Agents

01462 438979

sales@stonegate-estates.co.uk | www.stonegate-estates.co.uk

