



Flat 2, 3 Moor View Road, Oakdale, Poole, Dorset BH15 3LS

£180,000 Share of Freehold

info@anthonydavid.co.uk

www.anthonydavid.co.uk

01202 677444

**** NO FORWARD CHAIN **** A one bedroom purpose built first floor apartment being conveniently situated a short walk from local shops, bus stops, schools and parks. The property presents an ideal first time buy/investment and has the added benefit of a private garden. The accommodation on offer comprises: Lounge, modern fitted kitchen, double bedroom and bathroom. Externally the property boasts a private Westerly aspect garden being mainly laid to lawn. To the front there is one allocated parking space. Further features include: PET FRIENDLY, share of the freehold, gas central heating and UPVC double glazing.

**ANTHONY
DAVID & CO**

FIRST FLOOR
463 sq.ft. (43.0 sq.m.) approx.

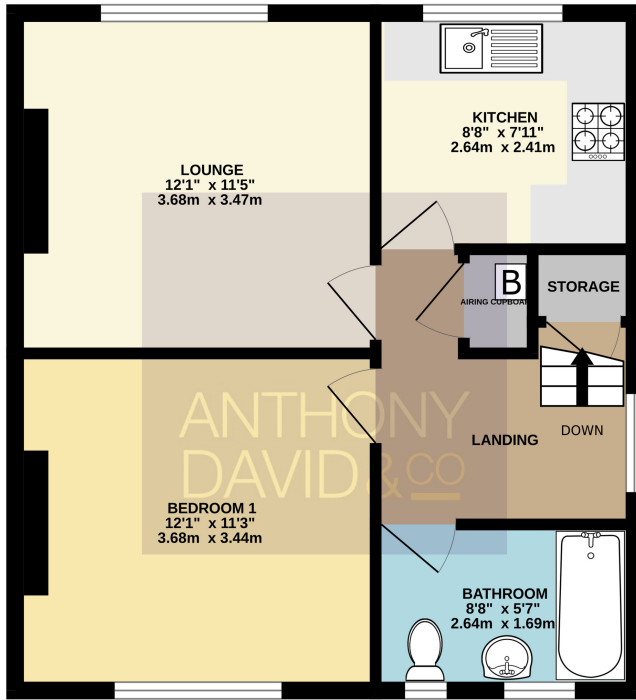

Stairs to Landing

Lounge 12' 1" x 11' 5" (3.68m x 3.48m)

Kitchen 8' 8" x 7' 11" (2.64m x 2.41m)

Bedroom 12' 1" x 11' 3" (3.68m x 3.43m)

Bathroom 8' 8" x 5' 7" (2.64m x 1.70m)

Garden Westerly aspect

Parking One allocated parking space

Tenure Share of the Freehold

999 year lease

Service Charge - as and when



TOTAL FLOOR AREA : 463 sq.ft. (43.0 sq.m.) approx.

Whilst every attempt has been made to ensure the accuracy of the floorplan contained here, measurements of doors, windows, rooms and any other items are approximate and no responsibility is taken for any error, omission or mis-statement. This plan is for illustrative purposes only and should be used as such by any prospective purchaser. The services, systems and appliances shown have not been tested and no guarantee as to their operability or efficiency can be given.
Made with Metropix ©2024



Energy Efficiency Rating		Current	Potential
Very energy efficient - lower running costs			
(92+)	A		
(81-91)	B		
(69-80)	C		
(55-68)	D	64	76
(39-54)	E		
(21-38)	F		
(1-20)	G		
Not energy efficient - higher running costs			
England, Scotland & Wales		EU Directive 2002/91/EC	

Property Misdescriptions Act 1991

Property details contained herein do not form part of an offer or contract. Any measurements are included for guidance only and as such must not be used for the purchase of carpets or fitted furniture. We have not tested any apparatus, equipment, fixtures, fittings or services neither have we confirmed or verified the legal title of the property. All prospective purchasers must satisfy themselves as to the correctness and accuracy of such details provided by us. We accept no liability for any existing or future defects relating to any property.