

FOR SALE

£450,000 Leasehold



Flat 2 Littlecourt, Ballards Lane, London, N12 0ES

- Share of freehold
- 2 double bedrooms
- Communal garden
- Lease - 999 years remaining
- Separate bathroom and toilet
- Close to shops and transport links
- 0.6 miles to West Finchley tube station
- Council Tax - Band C



PROPERTY DESCRIPTION

Share of freehold Jeremy Leaf & Co are delighted to offer this spacious ground floor apartment in a purpose built development benefiting from two double bedrooms, separate kitchen, bright reception room, original wooden flooring, fitted wardrobes and communal rear garden.

Offered chain free this property is ideally located on Ballards Lane, just yards from the shops, amenities and transport links of North Finchley with West Finchley only 0.6 miles away (Northern Line).

Council Tax band - C / Lease - 999 years



ROOM DESCRIPTIONS



FLOORPLAN

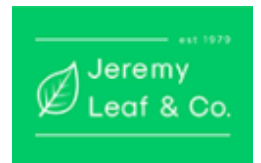

Approx Gross Internal Area
73 sq m / 783 sq ft

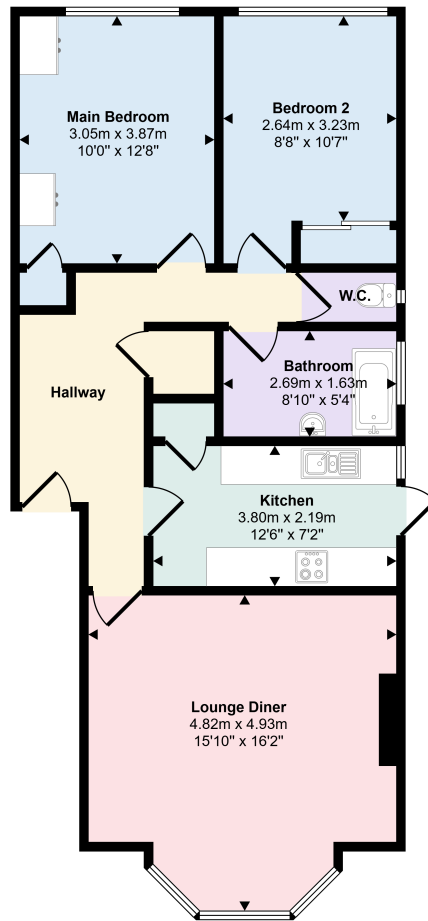

Floorplan

This floorplan is only for illustrative purposes and is not to scale. Measurements of rooms, doors, windows, and any items are approximate and no responsibility is taken for any error, omission or mis-statement. Icons of items such as bathroom suites are representations only and may not look like the real items. Made with Made Snappy 360.

North Finchley
863, High Road, London, N12 8PT
020 8446 4295
property@jeremyleaf.co.uk