



Day & Co
ESTATE AGENTS

28 Cavendish Street
Keighley
BD21 3RG



14 Saddlers Way, Long Lee,
Keighley, West Yorkshire, BD21
4FN

**35% SHARED
OWNERSHIP**
£59,500

T: 01535 664609

W: www.dayandcoestateagents.co.uk

E: keighley@dayandcoestateagents.co.uk

- 35% SHARED OWNERSHIP
- GARDENS & OFF ROAD PARKING
- NO CHAIN

- MODERN THREE BED SEMI-DETACHED
- GROUND FLOOR W.C
- EPC RATING B

SUMMARY

** 35% SHARED OWNERSHIP ** Shared Ownership could be a way to get onto the property ladder when you can't afford to buy a home on the open market. You buy an initial share and make a monthly payment to rent the remaining share. Modern Three Bedroom Semi-Detached House With Gardens & Off Road Parking. EPC Rating B

FULL DESCRIPTION

A modern Three Bedroom semi-detached house available to purchase on a 35% shared ownership basis situated in the popular area of Long Lee. In brief the accommodation comprises of an Entrance Hallway, Downstairs W.c. with toilet and wash basin. Living room, Dining Kitchen with a modern range of fitted wall and base units, window and French Doors to the rear. First Floor - Landing, Three Bedrooms, House Bathroom comprising of a bath with screen and shower over, w.c., wash basin. Gas Central Heating & Double Glazing. Outside - Front Garden, Off Road Parking, Enclosed Lawn Garden to the rear. EPC Rating B

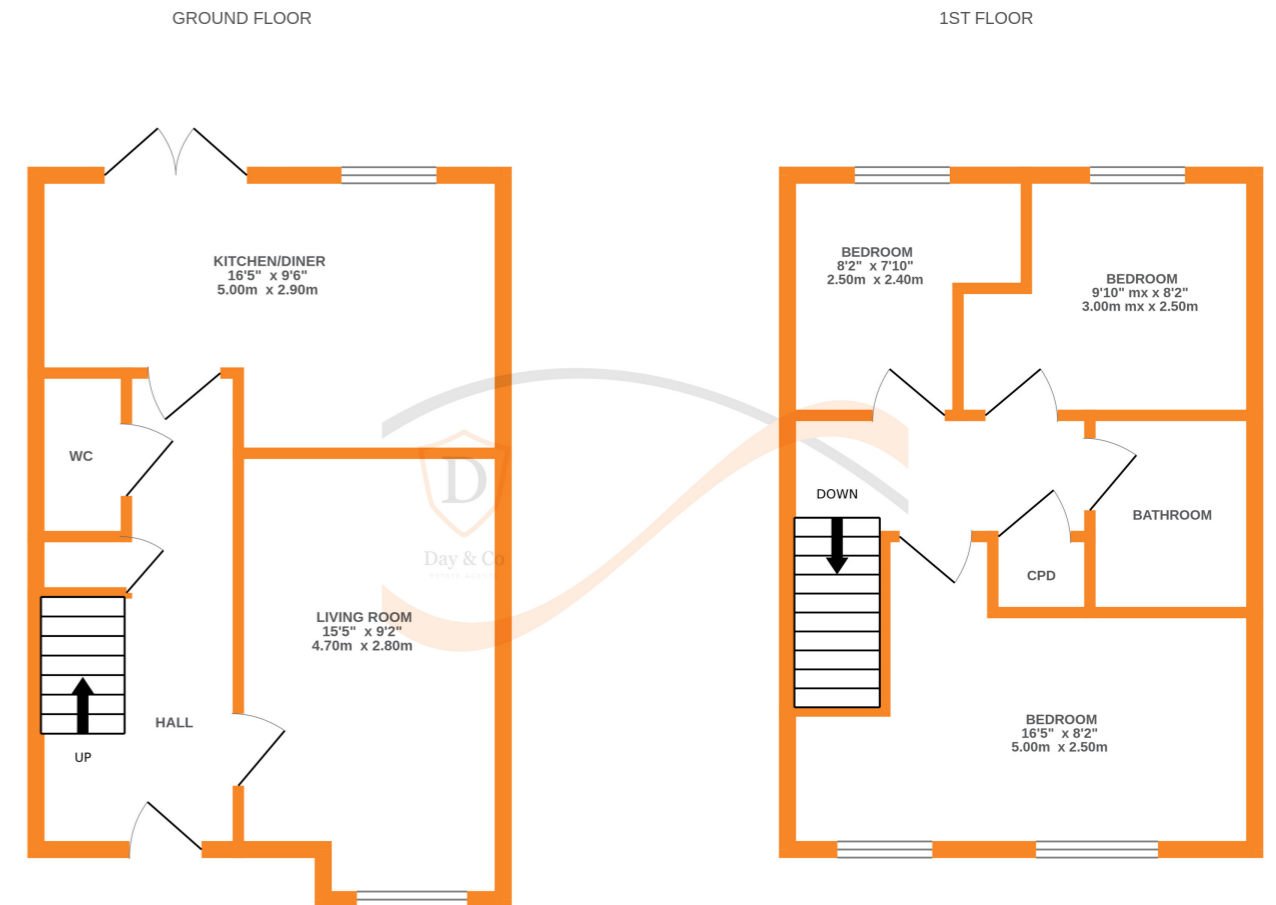

Whilst every attempt has been made to ensure the accuracy of the floorplan contained here, measurements of doors, windows, rooms and any other items are approximate and no responsibility is taken for any error, omission or mis-statement. This plan is for illustrative purposes only and should be used as such by any prospective purchaser. The services, systems and appliances shown have not been tested and no guarantee as to their operability or efficiency can be given.
Made with Metropix 6/2024