

19 Westbrook Drive

Folkestone
CT20 2EQ

£565,000 FREEHOLD

FOR SALE WITH BURNAP + ABEL... Welcome to your dream home on Westbrook Drive in the charming seaside town of Folkestone. This stunning 4-bedroom semi-detached house, built in 2017, offers a perfect blend of modern design and functionality. Step inside and be greeted by a spacious lounge, ideal for relaxing with family and friends. The open-plan kitchen/diner is perfect for hosting gatherings or enjoying casual meals with loved ones. A convenient ground floor W.C adds to the practicality of this home. The garage has been cleverly converted into a utility room and additional storage space, providing you with all the room you need for organisation and convenience. Upstairs, you will find four generously sized bedrooms, including a luxurious en-suite master bedroom and a stylish family bathroom. Located on Westbrook Drive in Folkestone, this property offers easy access to local amenities, excellent schools, and Folkestone's High Speed transport links. Don't miss out on the opportunity to make this house your forever home - schedule your viewing today!



Entrance Hall

Lounge

18' 2" x 14' 1" (5.54m x 4.29m)

W.C

Kitchen/Dining Room

16' 1" x 10' 0" (4.90m x 3.05m)

First Floor Landing

Bedroom One

14' 1" x 11' 3" (4.29m x 3.43m)

Family Bathroom

9' 10" x 6' 7" (3.00m x 2.01m)

Bedroom Two

14' 1" x 9' 0" (4.29m x 2.74m)

Bedroom Three

20' 3" x 9' 8" (6.17m x 2.95m)

Second Floor Landing

Master Bedroom

15' 8" x 10' 8" (4.78m x 3.25m)

Shower Room

Garage

Utility/Store - 11' 2" x 9' 6" (3.40m x 2.90m)

Garage/Store Area - 12' 4" x 9' 10" (3.76m x 3.00m)

Off Road Parking

Rear Garden

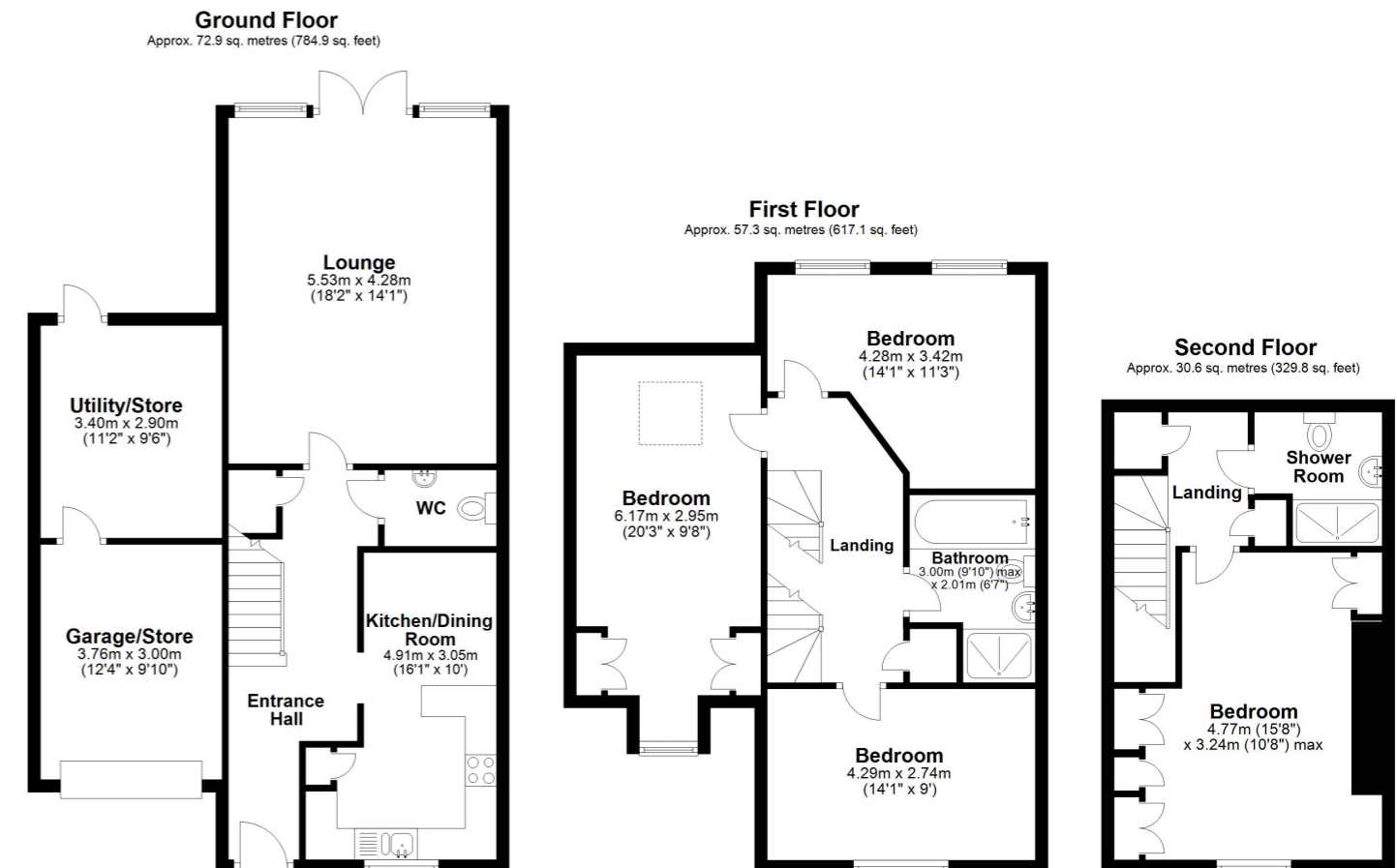

Whilst every attempt has been made to ensure the accuracy of the floor plan contained here, measurements of doors, windows, rooms and any other items are approximate and no responsibility is taken for any error, omission or mis-statement. This plan is for illustrative purposes only and should be used as such by any prospective purchaser. Plan produced using PlanUp.

