



## Hansel Road, London, NW6 5FP

£1,850 pcm

- One Double Bedroom Apartment
- Large Balcony Overlooking Communal Gardens
- Available 9th November 2021
- Third Floor with Lift
- New Build
- Ample Storage
- Car Park Space Available

## Hansel Road NW6

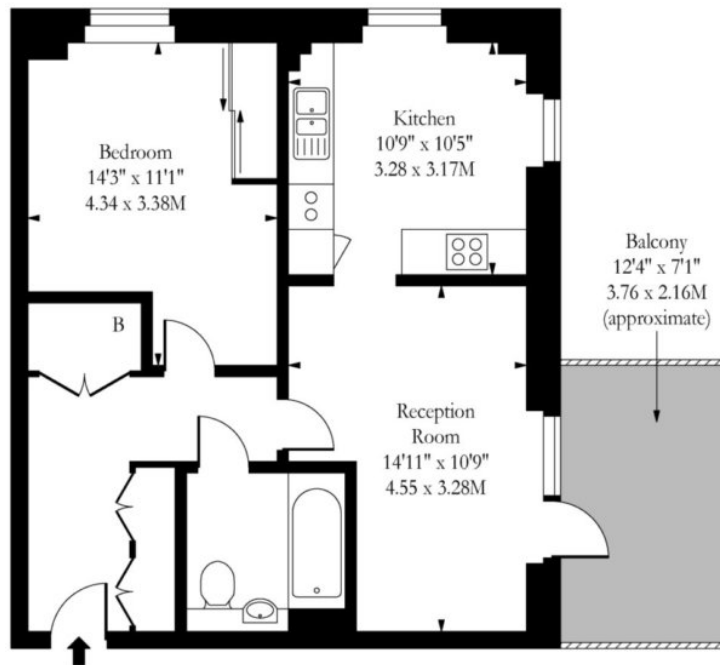

Third Floor

Approx Gross Internal Area

584 Sq Ft - 54.25 Sq M

Measured in accordance with RICS guidelines. Every attempt is made to ensure accuracy  
However all measurements are approximate.

The floor plan is illustrative purposes only and is not to scale

[www.tomekphotography.co.uk](http://www.tomekphotography.co.uk)

