





- End-Terrace Home
- Two Reception Rooms
- Two Double Bedrooms
- Large Bathroom
- Very Long Rear Garden
- Backing onto Wincham Brook
- Off Road Parking for Several Cars

Description

This traditional end-terrace home is located on the east side of the town with easy access to the A556. The house itself comprises: A porch, a lounge, a dining room and kitchen breakfast room on the ground floor and two double bedrooms, a large bathroom and landing on the first floor. Externally there is a small front garden set behind a mature hedge. To the rear there is parking for several cars, accessed over a private lane and beyond this area there is a very long, mature garden that backs onto Wincham Brook and is a true haven, which needs to be seen to believe.



Location

There are several shops nearby, catering from most everyday needs along with a highly regarded local primary school. There are two nearby High Schools, the highly regarded County High School Leftwich and Rudheath Senior Academy. Local transport facilities could not be better served with the A556 immediately available with connections to the M6 Motorway, only six miles away. The Northern Line railway with trains from Chester to Manchester is accessible from either Northwich or nearby Lostock Gralam and The Mainline West Coast Railway is available from Hartford. Northwich caters for a more comprehensive range of amenities, including leading supermarkets with Waitrose, Sainsbury's and Tesco all represented.

Tenure

EPC Rating:



Ground Floor

Approx. 49.4 sq. metres (531.5 sq. feet)

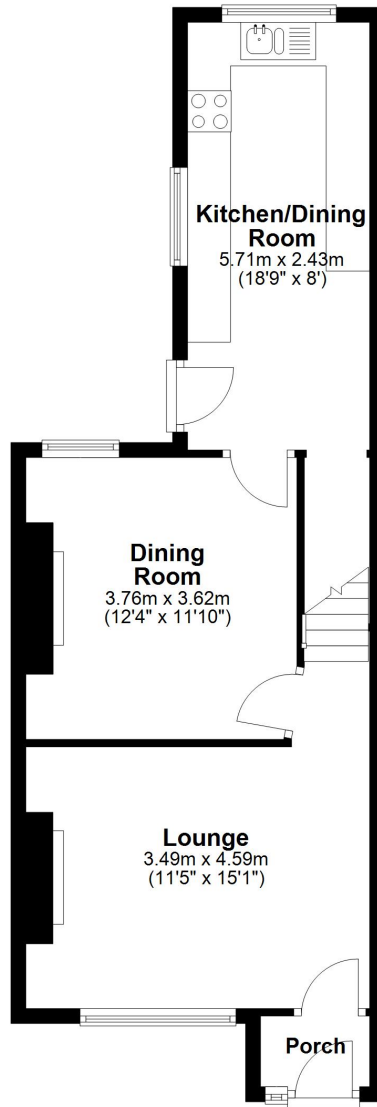

First Floor

Approx. 44.5 sq. metres (478.8 sq. feet)

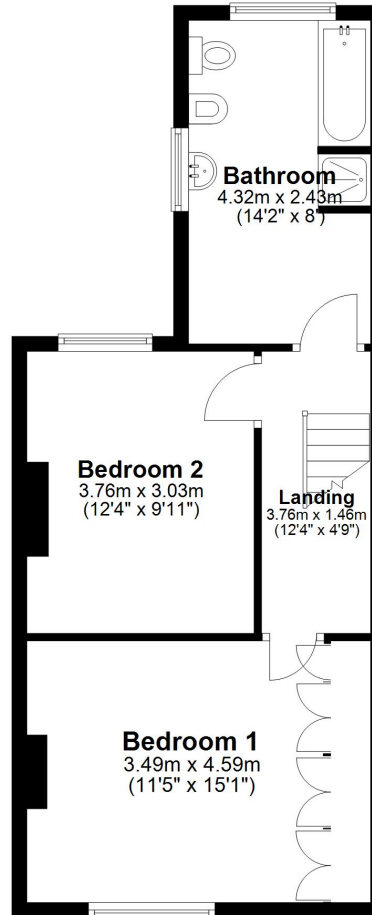

Total area: approx. 93.9 sq. metres (1010.3 sq. feet)



Williams Estates is the trading name of Williams Estates (Ltd). Registered address 33, The Green, Hartford, Northwich, Cheshire, CW8 1QA.

Reg number 07682683. Director Andrew P Williams