



**Flat 35 Felbridge Court, High Street, Feltham, Greater London. TW13 4BZ.**  
**1 Bedroom Retirement Property - £110,000 Leasehold**



# Flat 35 Felbridge Court, High Street, Feltham, Greater London. TW13 4BZ.

01784 451458

## 1 Bedroom Retirement Property - £110,000 Leasehold

**OVER 60'S ONLY - HUGELY SPACIOUS ONE BEDROOM APARTMENT SITUATED IN THE MUCH SOUGHT AFTER FELBRIDGE COURT RETIREMENT DEVELOPMENT IDEALLY LOCATED WITHIN MOMENTS OF FELTHAM HIGH STREET AND MAINLINE TRAIN STATION. The property benefits from a spacious lounge/diner, modern fitted kitchen, large double bedroom, modern white bathroom suite, residents parking & no onward chain. Viewings Highly Recommended!**

### Key Features

**OVER 60'S ONLY**

**LOCATED WITHIN HEART OF FELTHAM TOWN CENTRE**

**SOUGHT AFTER MCCARTHY & STONE RETIREMENT DEVELOPMENT**

**NO ONWARD CHAIN**

**SPACIOUS ROOMS THROUGHOUT**

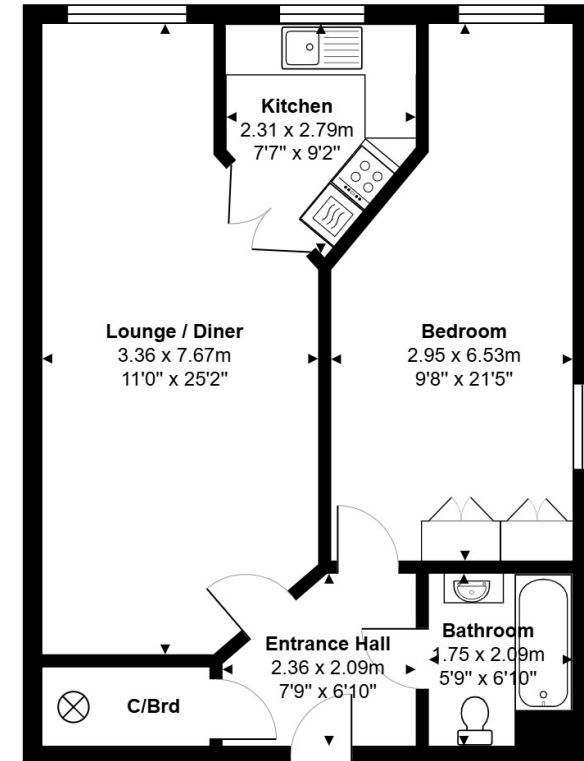

Third Floor

Total Area: 56.8 m<sup>2</sup> ... 611 ft<sup>2</sup>

All measurements are approximate and for display purposes only.







# Flat 35 Felbridge Court, High Street, Feltham, Greater London. TW13 4BZ.

gregory-brown.co.uk

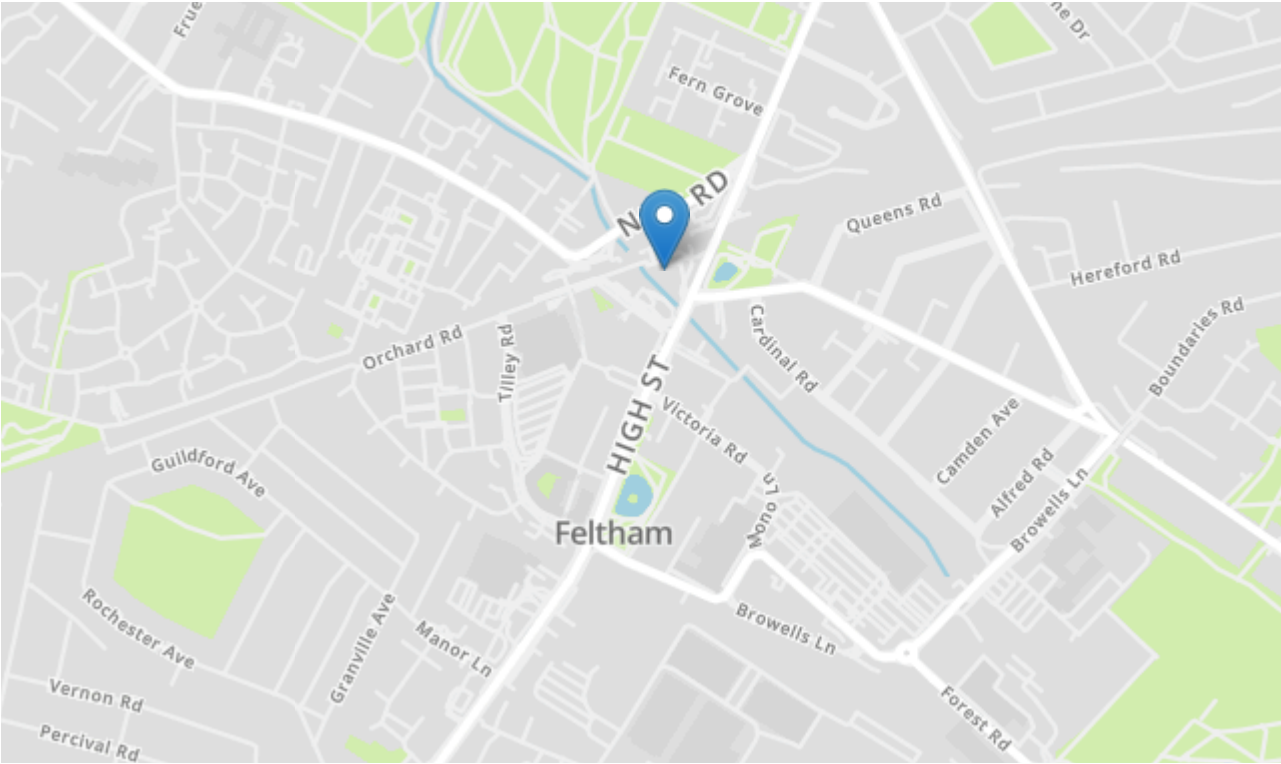

Tenure	Leasehold
Lease Term	To Be Confirmed
Ground Rent	To Be Confirmed
Service Charge	To Be Confirmed
Local Authority	
Council Tax	

We have prepared these property particulars as a general guide to a broad description of the property. They are not intended to constitute part of an offer or contract. We have not carried out a structural survey and the services, appliances and specific fittings have not been tested. All photographs, measurements, floorplans and distances referred to are given as a guide only and should not be relied upon for the purchase of carpets or any other fixtures or fittings. Lease details, service charges and ground rents (where applicable) and council tax are given as a guide only and should be checked and confirmed by your solicitor prior to exchange of contracts. The copyright of all details, photographs and floorplans remain exclusive to Gregory Brown.

