



Upland Road | Billericay | £539,950





# Upland Road

Billericay | Essex | CM12 0JS

The Property Specialists of Billericay are delighted to offer for sale this beautifully presented three double bedroom family home.

This deceptively spacious home is perfectly located within a short walk of Billericay High Street, Mainline Railway Station with its routes to London Liverpool Street and also within a short walk of Lake Meadows Park.

The ground floor accommodation comprises of a fantastic size living room to the rear which is the whole width of the house, opening up to the decked south facing garden enjoying the sunny outlook. In addition, the property has a separate dining room which is next to the superb fitted kitchen with its huge range of fitted units with ample storage and high spec integrated appliances.

On the first floor there are three good size bedrooms with an impressive sized main bedroom with the added advantage of a beautiful en-suite shower room.

Outside there is off road parking to the front and a shared drive to the right leading to a detached garage. The rear garden has a decked terraced patio area with steps down to good size lawn with a variety of mature trees and shrubs.

An internal viewing is strongly advised to fully appreciate the size and space on offer.







- Semi Detached Family Home
- Entrance Lobby And Hallway
- Recently Fitted High Specification Kitchen With Integrated Appliances
- Large Living Room Opening Up To The Sunny South Facing Garden
- Separate Dining Room
- Three good Size Bedrooms
- En-suite Shower Room To The Master Bedroom
- Modern Family Bathroom With Three Piece Suite
- Detached Garage
- South Facing Garden
- Off Road Parking
- No Onward Chain



**APPROX INTERNAL FLOOR AREA  
96 SQ M 1034 SQ FT**

This plan is for layout guidance only and is  
**NOT TO SCALE**

Whilst every care is taken in the preparation  
of this plan, please check all dimensions,  
shapes & compass bearings before making  
any decisions reliant upon them.

Copyright The Property Specialists



## Ground Floor

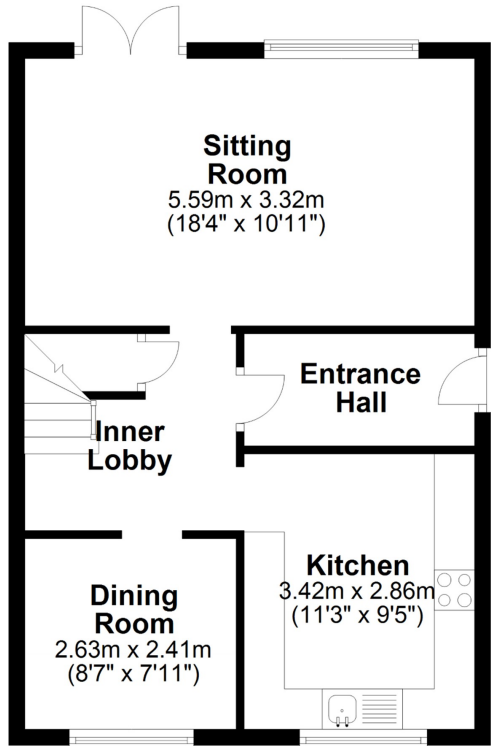

## First Floor

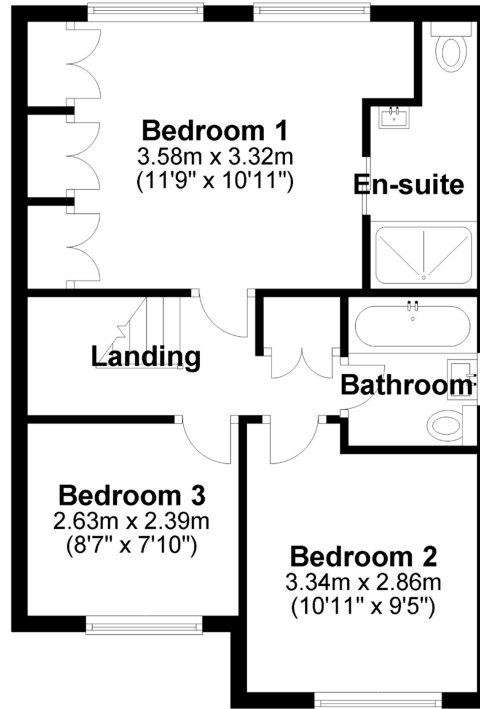

Viewing strictly by appointment with The Property Specialists



Making Moving Home  
**Less Stressful**

135 High Street, Billericay,  
Essex, CM12 9AB  
**Tel: 01277 654446**  
sales@thepropertyspecialists.co.uk