



149 Church Street, Langford, Bedfordshire, SG18 9NX

£325,000

SEMI-DETACHED COTTAGE WITH A PAIR OF GARAGES. Situated in the heart of the village is this extended property that now offers a 24FT living room, kitchen + cloakroom and upstairs are two double bedrooms and a bathroom. The real bonus is the off road parking for several cars + a pair of garages as well as the generous garden.



149 Church Street

Approximate Gross Internal Area
866 sq ft - 80 sq m

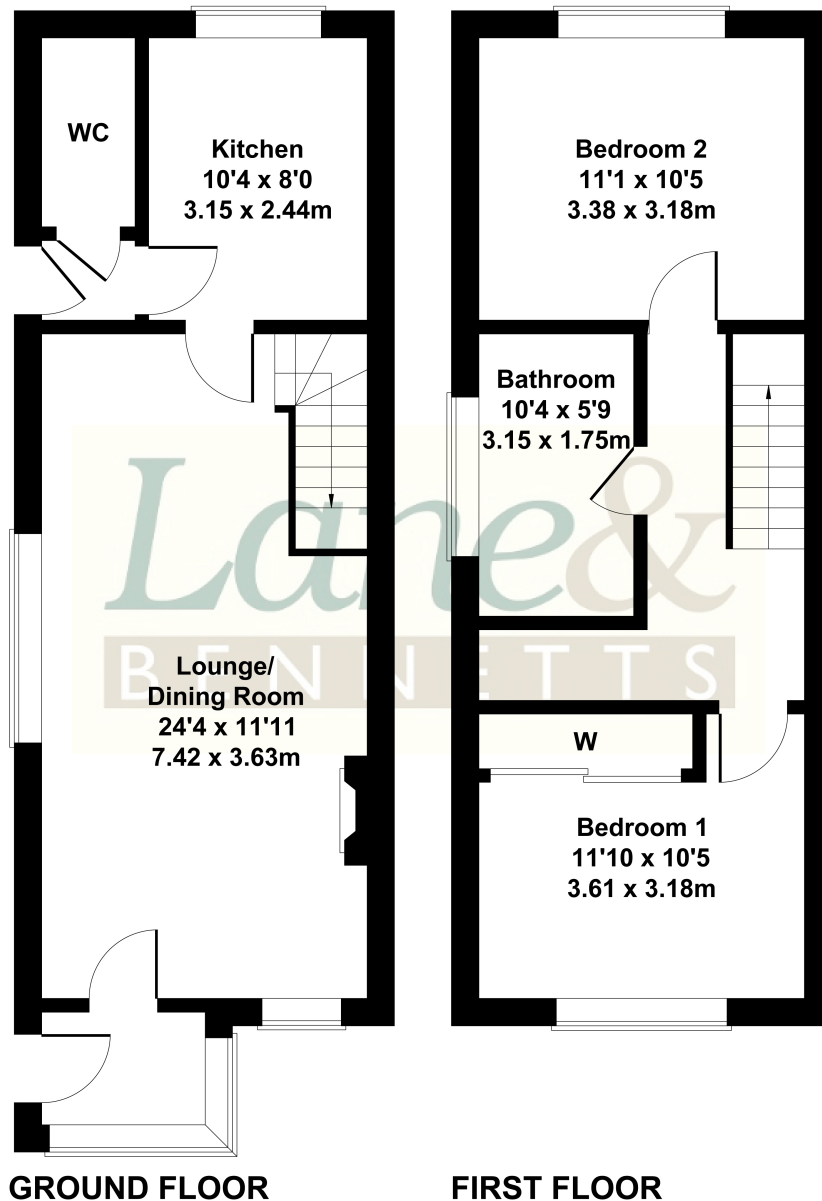

GROUND FLOOR

FIRST FLOOR

Not to Scale. Produced by The Plan Portal 2025
For Illustrative Purposes Only.

- EXTENDED SEMI-DETACHED COTTAGE
- LARGE LIVING ROOM WITH LOG BURNER
- DOWNSTAIRS CLOAKROOM
- TWO DOUBLE BEDROOMS
- UPSTAIRS BATHROOM + SHOWER CUBICLE
- NEW FITTED KITCHEN WITH HOB + OVEN + FRIDGE/FREEZER
- GENEROUS GARDEN
- TWO GARAGES AND AMPLE OFF ROAD PARKING
- EASY ACCESS TO A1 & LOCAL TRAIN STATION

