



200 Clare Road, Staines-upon-Thames, TW19 7EQ

SPACIOUS THREE BEDROOM MAISONETTE IDEALLY LOCATED FOR EASY ACCESS TO BOTH STAINES & ASHFORD TOWN CENTRES, LOCAL MOTORWAY NETWORKS & HEATHROW AIRPORT. The property benefits from a spacious lounge, separate modern fitted kitchen, three well-proportioned bedrooms, modern white bathroom suite and extensive rear garden. Unfurnished. Available Immediately. Viewings Highly Recommended!

ROOM DESCRIPTIONS

FLOORPLAN

First Floor

Approx. 59.2 sq. metres (637.0 sq. feet)

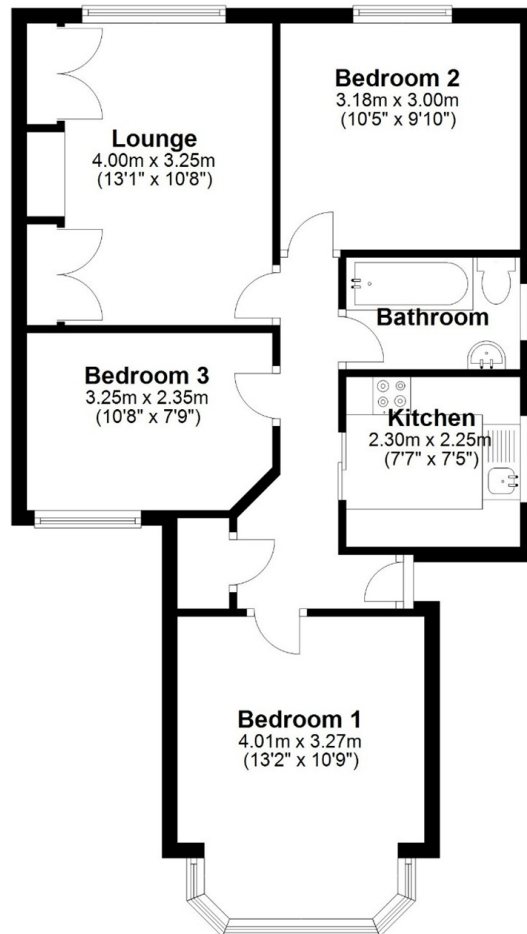

Total area: approx. 59.2 sq. metres (637.0 sq. feet)

127a, High Street, Staines-upon-Thames, TW18 4PD

01784 451458

staines@gregory-brown.co.uk