

Northumberland Gardens Isleworth, TW7

Approximate Floor Area = 60.7 sq m / 653 sq ft

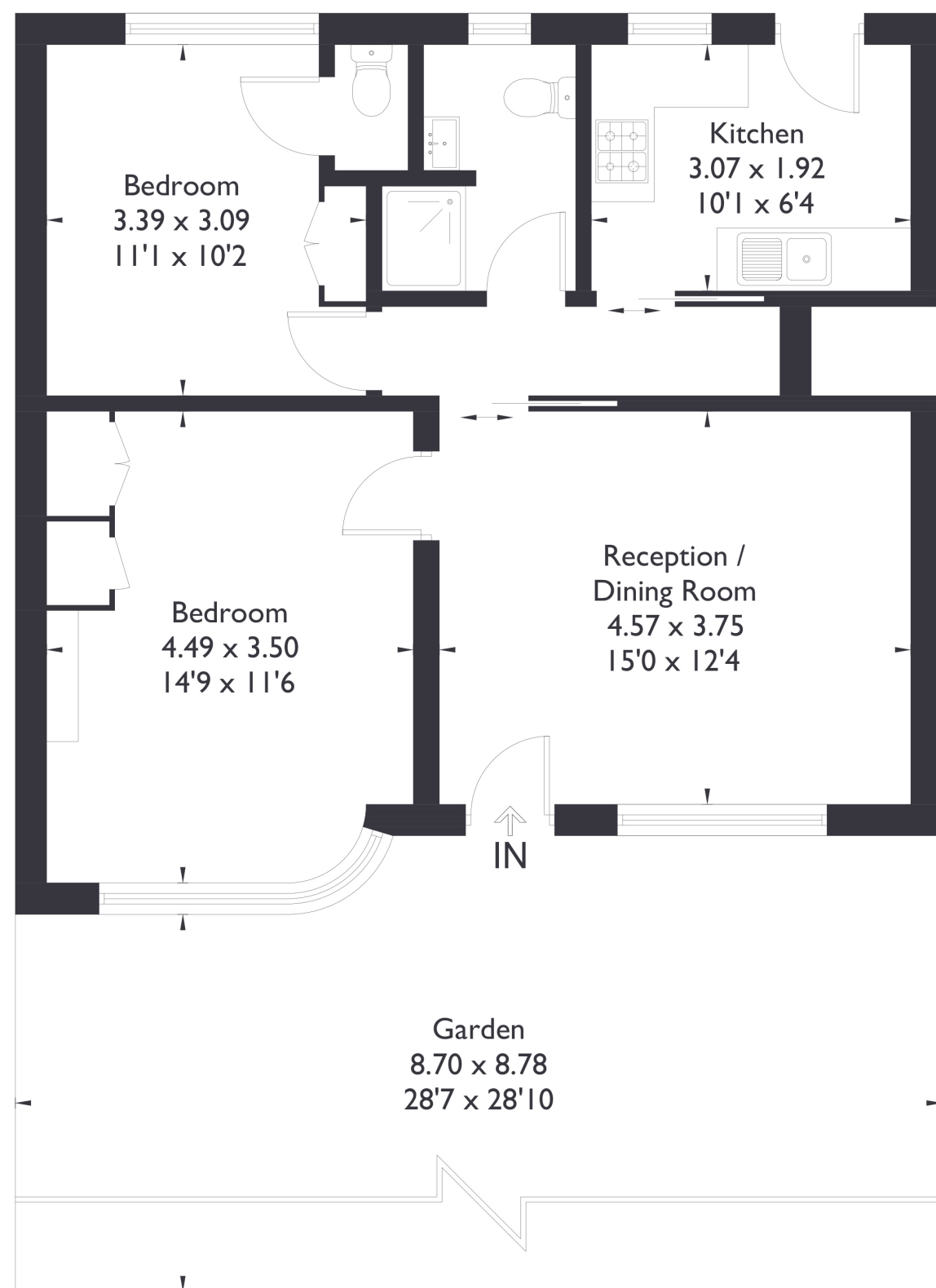

2 BEDROOM FLAT

Northumberland Gardens, TW7 £400,000

Welcome to this charming two bedroom, one bathroom ground floor flat, complete with its own private garden and separate entrance. This bright and inviting property offers a spacious reception area, two well proportioned double bedrooms, a family bathroom, and a kitchen conveniently situated at the rear of the property, opening directly onto the private garden perfect for outdoor relaxation.

FEATURES

- Two Bedrooms
- One Bathroom/ W/C
- Separate Kitchen & Living
- Private Entrance
- Private Garden
- Newly Refurbished
- EPC Rating C



2 BEDROOM FLAT

Northumberland Gardens £400,000

With plenty of potential, this home is ideally located, providing excellent access to the Great West Road, with convenient links to Brentford, Kew, and the stunning Syon Park.

Additionally, Syon Lane Station is just a short distance away, ensuring easy connectivity. EPC Rating C.

