



- One Bedroom Bungalow
- Excellent Sized Accommodation
- Over 55s Development
- 24 Hour Emergency Call System
- Residents' Pavillion including Lounge, Library, Conference Room and Guest Suite
- No Onward Chain
- Service Charge - £246.46 Per Month / Ground Rent - £350 Per Annum
- Four Piece Bathroom Suite

## 3 Meadow Park, Braintree, Essex. CM7 1TD.

Michaels Property Consultants are delighted to present to the market this recently decorated one bedroom bungalow occupying an excellent position within the sought after Meadow Park Village, an over 55s development consisting of just 55 properties. New to the market and offered for sale with no onward chain, this well proportioned home is conveniently positioned South of the Braintree town centre, with the development itself offering an excellent range of amenities including a residents lounge, a library, and a guest suite for visiting friends & family.



# Property Details.

## Accommodation

### Entrance Hall

### Four-Piece Bathroom Suite



### Bedroom



11' 7" x 11' 5" (3.53m x 3.48m)

## Lounge/Kitchen/Diner



25' 5" x 11' 5" (7.75m x 3.48m)

# Property Details.

## Landscaped Garden



# Property Details.

## Floorplans

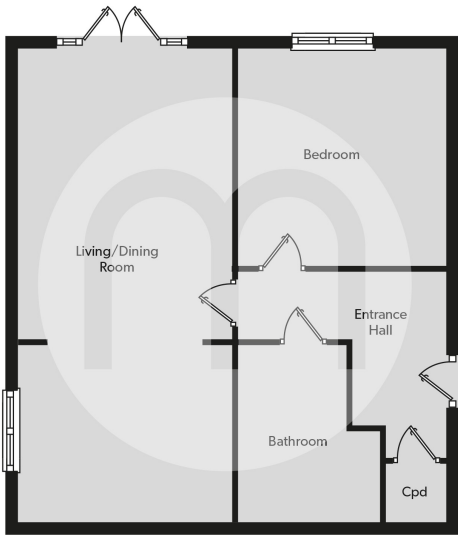

## Location

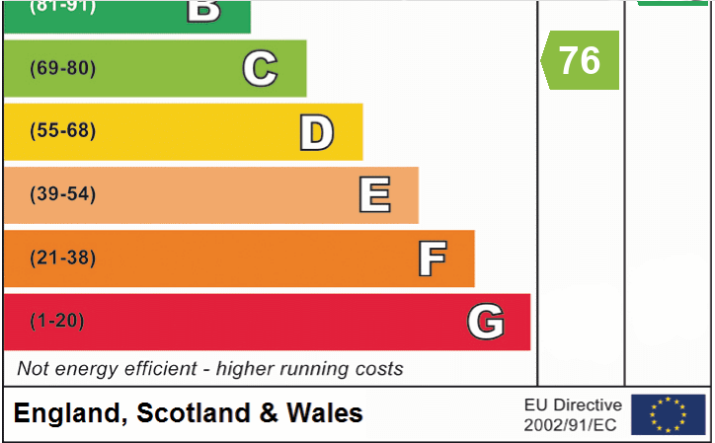
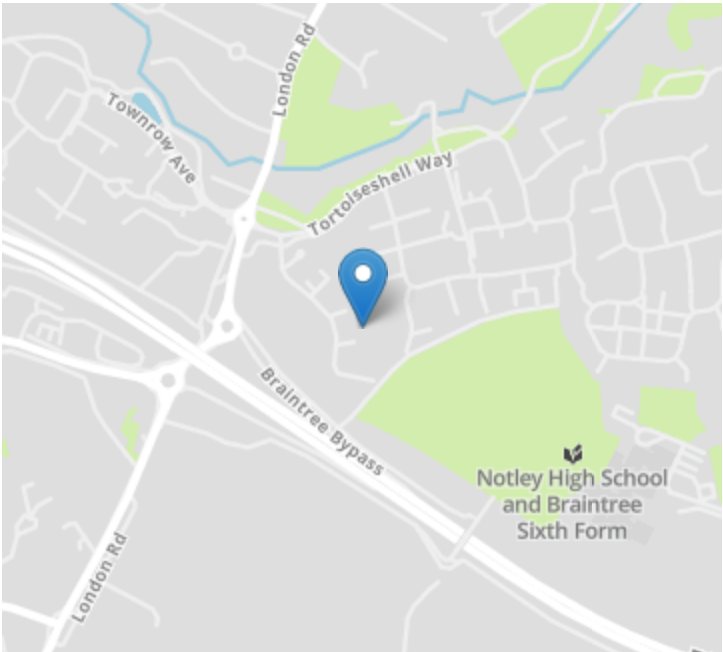

We have not carried out a structural survey and the services, appliances and specific fittings have not been tested. All photographs, measurements, floor plans and distances referred to are given as a guide only and should not be relied upon for the purchase of carpets or any other fixtures or fittings. Gardens, roof terraces, balconies and communal gardens as well as tenure and lease details cannot have their accuracy guaranteed for intending purchasers. Lease details, service ground rent (where applicable) are given as a guide only and should be checked and confirmed by your solicitor prior to exchange of contracts.