



LESBOURNE ROAD, REIGATE, SURREY RH2

HOUND & PORTER
FIND A HOUSE. MAKE IT HOME

LESBOURNE ROAD, REIGATE, SURREY RH2



- Set right in the heart of Lesbourne Village
- 2 bedroom Victorian cottage
- Arranged over three floors
- Beautifully improved by the current owners
- Cosy lounge with exposed brick chimney breast
- Log burner
- Custom built in storage throughout
- Recently fitted kitchen with stable door to garden
- Upstairs family bathroom
- An abundance of original features



Lesbourne Road, Reigate, RH2

Approximate Area = 637 sq ft / 59.1 sq m
For identification only - Not to scale

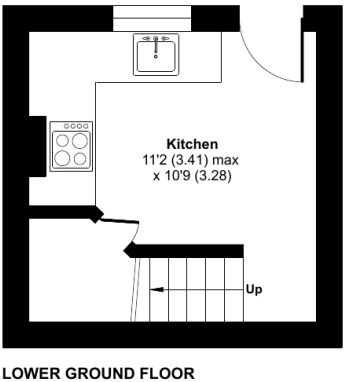
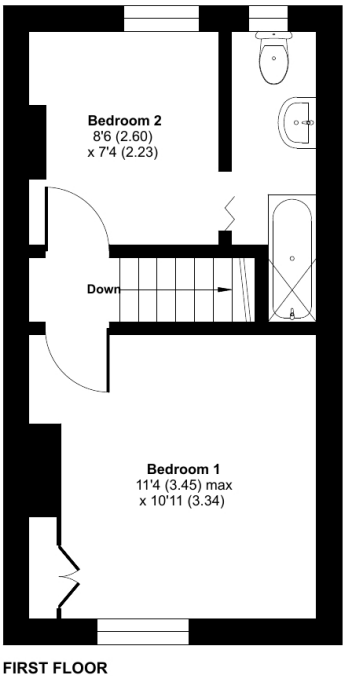
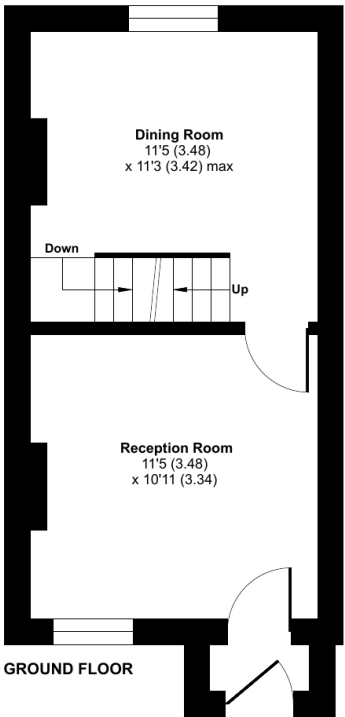

Hound and Porter are excited to be able to share with you this exceptional, 2 bedroom Victorian cottage set right in the heart of Lesbourne Village. From the moment you approach this beautiful home, via the characterful gate and front garden, you can see the care and attention that the current owners have put in to enhance and improve their home.

The treated and exposed floorboards, the exposed brick chimney breast, the log burner, the custom built in storage, the in keeping U.P.V.C sash windows...they are all features and elements to be enjoyed and appreciated for a property of its kind.

Arranged over three floors,, this property exudes charm. The lounge to the front is extremely cosy, the separate dining room to the rear, with views over the garden, offers a gorgeous space to entertain family and friends. On the first floor is 2 bedrooms and a family bathroom. Head down to the lower ground floor to the the recently fitted kitchen, with pantry and stable door to the garden. There is side access from the front to your garden, great for bike access or perhaps muddy paws that need wiping off!

LESBOURNE ROAD, REIGATE, SURREY RH2

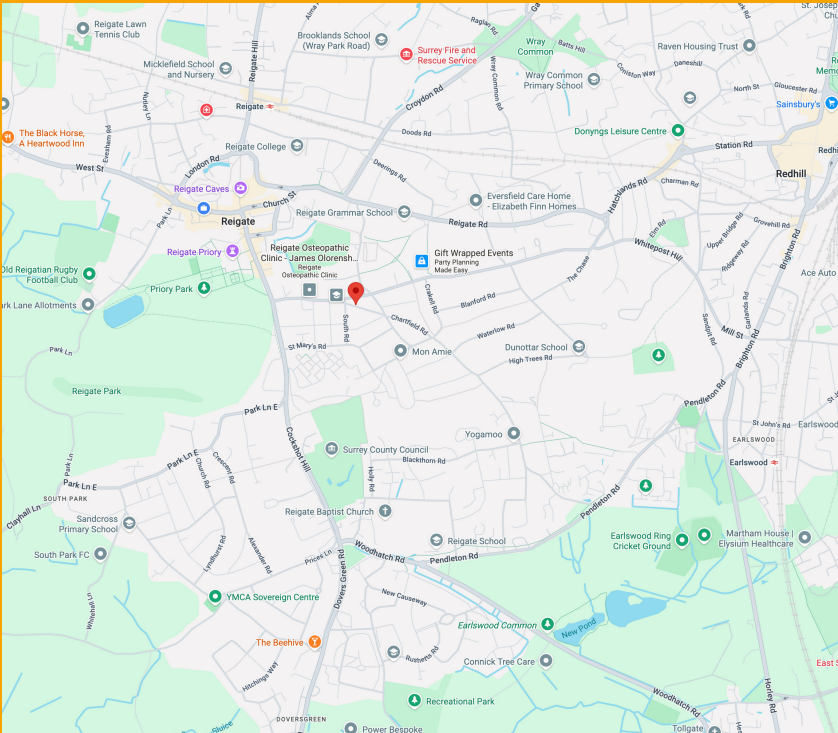

LOCATION

This fabulous home is located just outside Reigate town centre in the very popular Lesbourne Village. The town centre is less than 0.5 miles away so a brisk walk will get you there in under ten minutes. The market town of Reigate is brimming with boutique shops, cafes and restaurants, Priory Park offers lovely dog walks and a central children's play area is accompanied by a central cafe. Reigate main line station is under a mile away and offers great links to London and the South Coast.

TRANSPORT

Within easy reach of the A25, M23, M25 and Gatwick Airport

A bus service providing access to Redhill, Reigate and north of the M25

DISTANCE TO STATIONS FROM PROPERTY BY ROAD

- 0.7miles to Reigate Station
- 2.0 miles to Redhill Station



DID YOU LIKE WHAT YOU'VE JUST SEEN?

Get in touch. We are more than happy to arrange a viewing, assist you with the complicated paperwork and find you the best local businesses to help during and after your move. We look forward to hearing from you.

58 Castle Walk
Reigate, Surrey
RH2 9PX

01737 317880
hello@houndandporter.co.uk