

New



*160 Manchester Road, Rixton, Warrington,
Cheshire. WA3 6EA.
£950,000*



Freehold title | Four bedroom detached family home | A perfect blend of Rustic Charm and Contemporary Luxury. | Four receptions rooms | Loft conversion that is currently used as a cinema room | Perfectly located for motorway links and open green spaces | Master with dressing room and en



GROUND FLOOR
1503 sq.ft. (139.6 sq.m.) approx.

1ST FLOOR
1000 sq.ft. (92.9 sq.m.) approx.

2ND FLOOR
350 sq.ft. (32.6 sq.m.) approx.

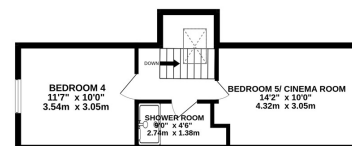
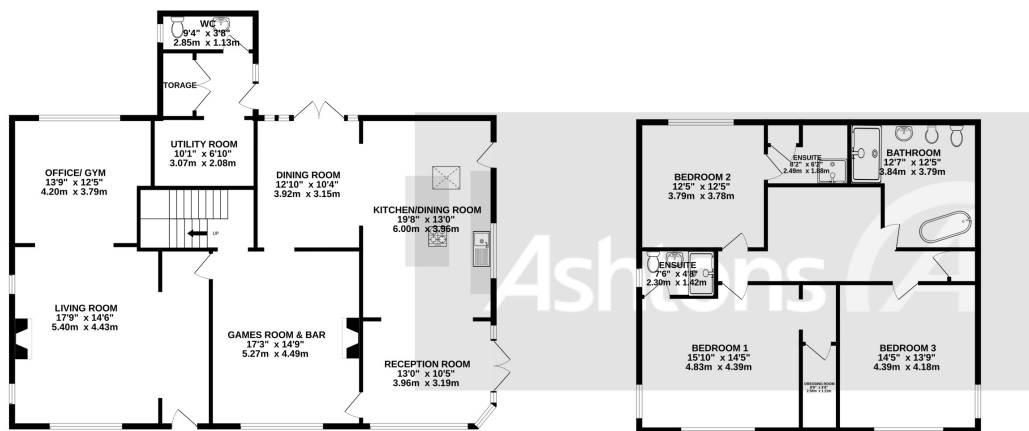

TOTAL FLOOR AREA : 2853 sq.ft. (265.1 sq.m.) approx.

Whilst every attempt has been made to ensure the accuracy of the floorplan contained here, measurements of doors, windows, rooms and any other items are approximate and no responsibility is taken for any error, omission or mis-statement. This plan is for illustrative purposes only and should be used as such by any prospective purchaser. The services, systems and appliances shown have not been tested and no guarantee as to their operability or efficiency can be given.
Made with Metropix ©2023

As you approach the house, you'll immediately notice the picturesque setting, surrounded by breathtaking natural beauty. The exterior boasts a beautifully lit up driveway, providing ample parking space, and a double garage for your convenience.

Stepping inside, you'll be greeted by a warm and inviting atmosphere. The lounge features a cozy wood burner, perfect for those chilly evenings, and showcases the original oak beams that add character and a touch of history to the space. The integrated Neff appliances and wine cooler in the kitchen make it a chef's delight, while the snug area provides a comfortable space for relaxation and casual dining.



Contact your local office
to arrange a viewing:

Padgate: 01925 479334
Great Sankey: 01925 454300
Winwick: 01925 232146
Stockton Heath: 01925 453400
St.Helens: 01744 754120
Wigan: 01942 498862
Culcheth: 01925 764744
Ashton-In-Makerfield: 01942 364446
Newton-Le-Willows: 01925 907770
Commercial Office: 01925 907709
Lettings Head Office: 01925 873533
Financial Services: 01925 221234

Viewing Arrangements

Viewing is strictly by appointment only through
Ashtons Estate Agency.

Disclaimer Property Details

These particulars, whilst being believed to be accurate are set out as a general outline only for guidance and do not constitute any part of an offer or contract. Intending purchasers should not rely on them as statements of representation of fact, but must satisfy themselves by inspection or otherwise as to their accuracy. We have not carried out a detailed survey nor tested the services, appliances and specific furnishings. The measurements given are approximate. No person in this firm's employment has the authority to make or give any representation or warranty in respect of the property.

All details, photographs and floorplans are the copyright of Ashtons Estate Agency.



How much you can borrow?
Speak to a mortgage expert in your local office.

Ashtons Financial Services

Ashtons.net rightmove

PrimeLocation.com Zoopla.co.uk

Ashtons

hosting gatherings, or simply enjoying the comforts of this exceptional home, this detached house in Rixton is sure to exceed your expectations.