



Triner Place,
Norton



OneAgency

01782 970222

hello@oneagencygroup.co.uk



Offers in Region of £110,000

Semi detached house which is considered an ideal first time buy or buy to let. The property offers family sized accommodation with the benefit of a conservatory and gardens.





Ground Floor

Hall

Entered through a UPVC front door.

Lounge

5.95m x 3.14m (19' 6" x 10' 4") A double glazed window to the front, radiator.

Kitchen

3.44m x 3.38m (11' 3" x 11' 1") A range of wall and base units with worktops, sink basin with mixer taps, window to rear and radiator.

Conservatory

3.57m x 2.84m (11' 9" x 9' 4") A conservatory with double doors to the lounge, door to garden.

Utility Area

2.57m x 2.32m (8' 5" x 7' 7") A useful utility space with plumbing for a washing machine and space for a dryer with a guest w/c.

First Floor

Bedroom One

4.17m x 3.46m (13' 8" x 11' 4") A double glazed window to the front, radiator.

Bedroom Two

3.29m x 3.17m (10' 10" x 10' 5") A double glazed window to the front, radiator.

Bedroom Three

3.18m x 2.57m (10' 5" x 8' 5") A double glazed window to the rear, radiator.

Bathroom

2.54m x 1.65m (8' 4" x 5' 5") Bath, pedestal hand wash basin, low level W/C, double glazed window.

Outside

Gardens to the front and rear.

Agents Notes

Stoke on Trent Council Tax Band A



GROUND FLOOR

1ST FLOOR

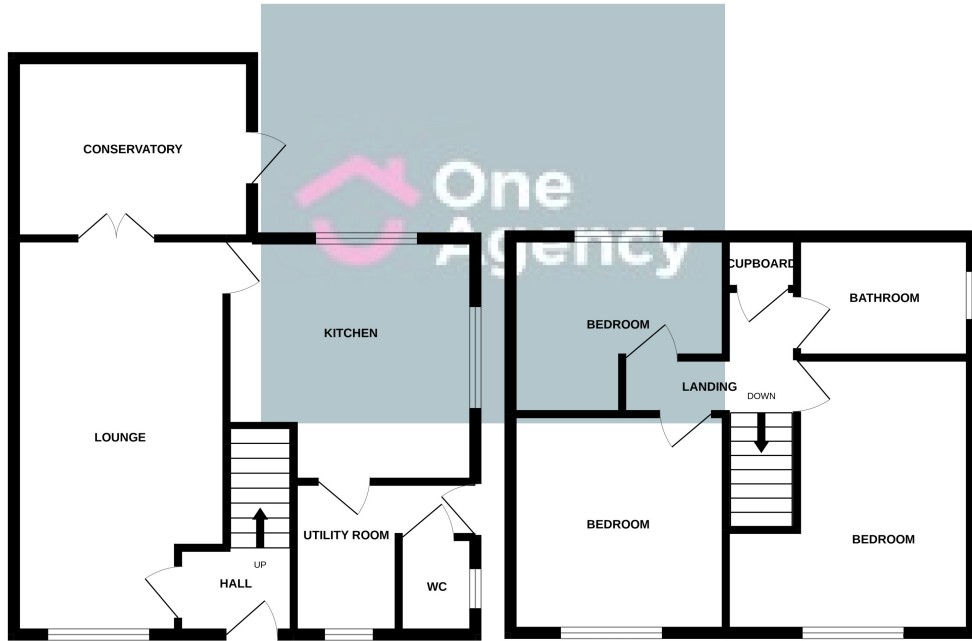

Whilst every attempt has been made to ensure the accuracy of the floorplan contained here, measurements of doors, windows, rooms and any other items are approximate and no responsibility is taken for any error, omission or mis-statement. This plan is for illustrative purposes only and should be used as such by any prospective purchaser. The services, systems and appliances shown have not been tested and no guarantee as to their operability or efficiency can be given.
Made with Metropix ©2022

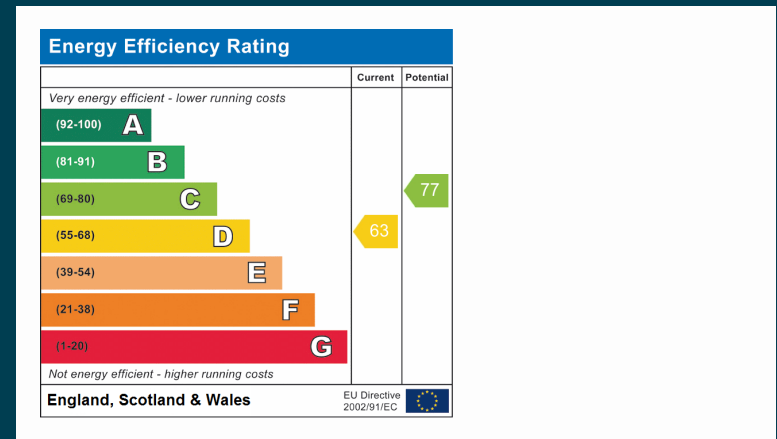

OneAgency, 9 & 10 Ridge House Drive, Festival Park, Stoke-on-Trent, ST1 5SJ

01782 970222

hello@oneagencygroup.co.uk

Every attempt has been made to ensure accuracy, however, all measurements are approximate and for illustrative purposes only. **Not to scale.**

In accordance with The Consumer Protection from Unfair Trading Regulations 2008 the following particulars have been prepared in good faith and they are not intended to constitute part of an offer or contract. We have not carried out a structural survey and the services, appliances and specific fittings have not been tested. All photographs, measurements, floor plans and distances referred to are given as a guide only and should not be relied upon for the purchase of carpets or any other fixtures and fittings. Lease details, service charges and ground rent (where applicable) are given as a guide only and should be checked and confirmed by your Solicitor prior to exchange of contracts.