



Perfectly located just a short drive from Heathrow Airport and with easy access to the M4, this extended and spacious semi-detached property offers a very generous living space, suitable for a family.

The property has been enhanced by an L-shaped side and rear extension, with the former garage now forming part of the living space downstairs.

The ground floor includes a large kitchen/dining room overlooking the garden, three reception rooms suitable for living and entertaining, and a fourth family room that can serve as a playroom or study. There is also a downstairs bedroom with en-suite shower room, perfect for guests.

Upstairs, the home offers three well-proportioned bedrooms and a family bathroom, providing ample space for growing families.

The front of the property offers driveway parking for at least 2 cars, whilst the well-maintained rear garden is mostly laid to lawn, and enjoys a high degree of privacy.

With over 1,550 square ft of accommodation, this practical and well-laid-out home is ideal for those seeking space combined with a convenient location. The property is located within easy reach of multiple nearby schools, including three local grammar schools.

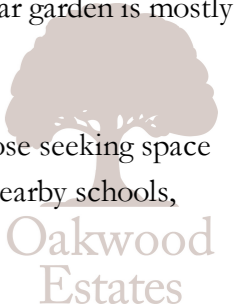

Property Information

-  FOUR BEDROOM SEMI-DETACHED HOUSE
-  3/4 RECEPTION ROOMS
-  PRIVATE REAR GARDEN
-  LARGE KITCHEN/DINER
-  EASY ACCESS TO HEATHROW AIRPORT
-  L-SHAPED SINGLE STOREY EXTENSION
-  GROUND FLOOR BEDROOM WITH EN-SUITE
-  DRIVEWAY PARKING FOR AT LEAST 2 CARS
-  STUDY ROOM
-  CLOSE TO MULTIPLE LOCAL SCHOOLS

x4
Bedrooms

x4
Reception Rooms

x2
Bathrooms

x3
Parking Spaces

Y
Garden

N
Garage

Transport Links

NEAREST STATIONS:

- Langley - 1.4 miles
- Sunnymeads - 1.6 miles
- Datchet - 1.9 miles

Local Schools

PRIMARY SCHOOLS:

- Foxborough Primary School

850 yards
- Holy Family Catholic Primary School

0.7 miles
- Colnbrook Church of England Primary School

0.7 miles
- Marish Primary School

1 mile
- The Langley Heritage Primary

1.1 miles
- Langley Hall Primary Academy

1.1 miles

1.1 miles

SECONDARY SCHOOLS:

- Langley Grammar School

1 mile
- The Langley Academy

1.3 miles
- Langley Hall Arts Academy

1.5 miles
- Ditton Park Academy

1.6 miles
- Churchmead Church of England (VA) School

1.9 miles
- St Bernard's Catholic Grammar School

2 miles
- Council Tax

Band D

Floor Plan

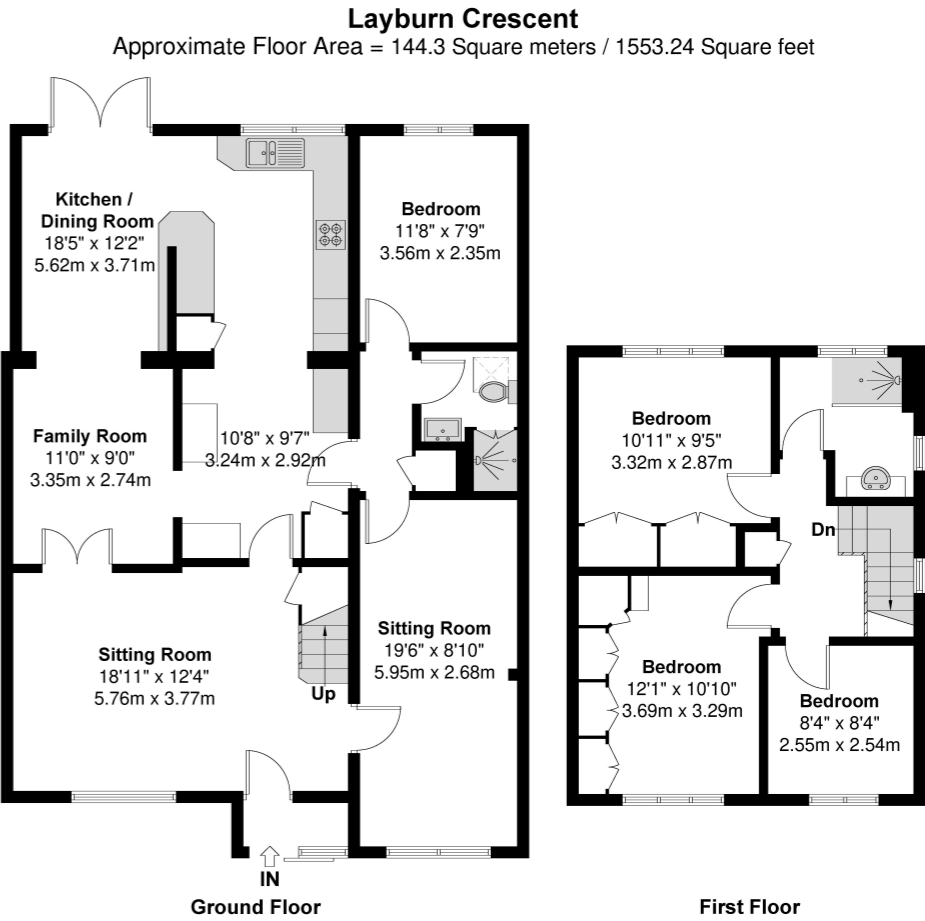

Illustration for identification purposes only,
measurements are approximate, not to scale.

Prospective purchasers should be aware that these sales particulars are intended as a general guide only and room sizes should not be relied upon for carpets or furnishing. We have not carried out any form of survey nor have we tested any appliance or services, mechanical or electrical. All maps are supplied by Goview.co.uk from Ordnance Survey mapping. Care has been taken in the preparation of these sales particulars, which are thought to be materially correct, although their accuracy is not guaranteed and they do not form part of any contract.

