









This well presented one bedroom starter home is located on a popular residential cul-de-sac in the charming village of Datchet. The property is well presented throughout and the ground floor features a contemporary 22ft open plan kitchen/living area with cream ceramic units and engineered wood flooring. On the first floor there is a double bedroom and a modern three piece bathroom. Externally there is a garden to the front and allocated parking for one car with ample visitor parking available. The property is an excellent first time purchase or investment.



Property Information

-  MODERN ONE BEDROOM TERRACED HOME
-  POPULAR CUL-DE-SAC
-  21FT CONTEMPORARY KITCHEN/LIVING AREA
-  3 PIECE BATHROOM
-  FRONT GARDEN
-  PARKING FOR 1 CAR

					
x1	x1	x1	x1	N	N
Bedrooms	Reception Rooms	Bathrooms	Parking Spaces	Garden	Garage

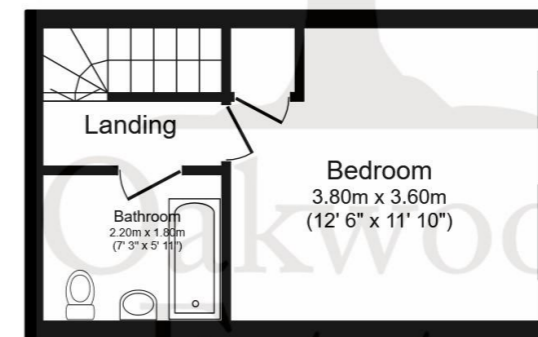
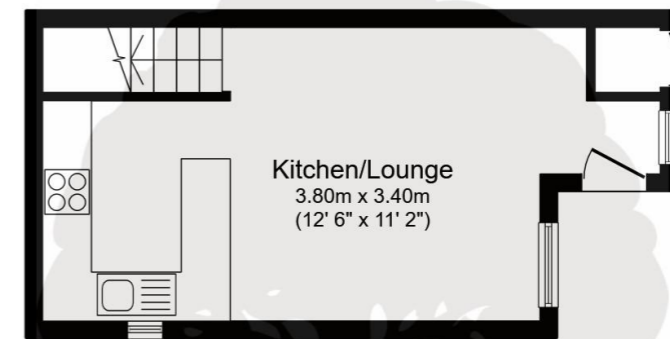

Total floor area 46.6 sq.m. (501 sq.ft.) approx

This plan is for illustration purposes only and may not be representative of the property. Plan not to scale. Powered by PropertyBox

Prospective purchasers should be aware that these sales particulars are intended as a general guide only and room sizes should not be relied upon for carpets or furnishing. We have not carried out any form of survey nor have we tested any appliance or services, mechanical or electrical. All maps are supplied by Goview.co.uk from Ordnance Survey mapping. Care has been taken in the preparation of these sales particulars, which are thought to be materially correct, although their accuracy is not guaranteed and they do not form part of any contract.

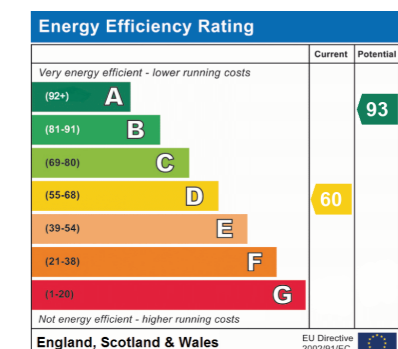
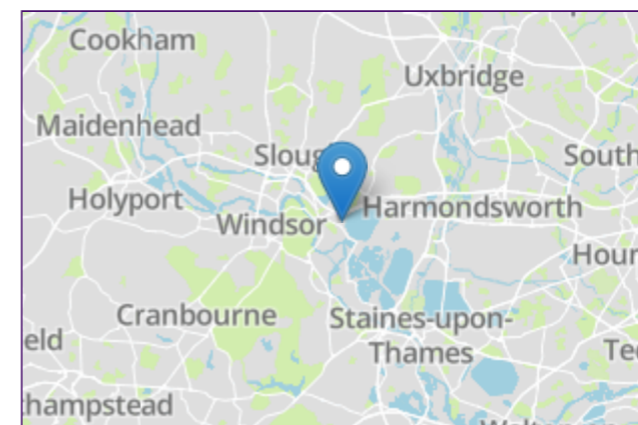

External

There is a garden to the front and allocated parking for one car with ample visitor parking available.

Transport Links

Nearest stations:

- Datchet (0.6 miles)
- Sunnymeads (0.9 miles)
- Windsor & Eton Riverside (1.8 miles)
- Langley (3.2 miles) - future Cross Rail line approx. 11 minutes drive

Location

Penn Road is a cul-de-sac situated in the picturesque Thameside village of Datchet. A range of shopping facilities for day-to-day needs are available in Datchet, whilst further amenities may be found in Windsor and Slough. Educational facilities in the area both state and private are excellent. Sporting facilities in the area include golf at Datchet, The Royal Berkshire, horse riding in Windsor Great Park, horse racing at Windsor and Ascot, boating on some stretches of the River Thames.

Schools

Primary Schools:
Datchet St Mary's CofE Primary School
0.6 miles away State school

Castleview Primary School
1.1 miles away State school

Eton End School Trust (Datchet) Limited

1.1 miles away Independent school

Holy Family Catholic Primary School
1.2 miles away State school

Foxborough Primary School
1.4 miles away State school

Secondary Schools:
Churchmead Church of England (VA) School
0.7 miles away State school

Langley Grammar School
1.3 miles away Grammar school

The Langley Academy
1.5 miles away State school

Long Close School
1.6 miles away Independent school

Upton Court Grammar School
1.6 miles away Grammar school

Council Tax

Band C