



Apartment 12, The Pavillions Fairway Drive, Ramsey, Isle of Man. IM8 2BQ

Very spacious purpose built apartment within gated development that enjoys superb views over Ramsey golf course



£399,950 Leasehold

PROPERTY DESCRIPTION

SITUATION From Parliament Square turn into Brookfield Avenue past The Spar store. Continue up the hill past the entrance into Ramsey Golf Club and take the next right onto Fairway Drive and immediate right into The Pavilions.

This immaculate top floor apartment within The Pavilions development in Ramsey, Isle of Man, offers luxurious living in a stunning setting. The highlight of the property is undoubtedly the spacious lounge/diner, which measures almost 30 feet long. This bright and airy space is perfect for both relaxing and entertaining, with plenty of room for a dining area and comfortable seating. The modern kitchen, seamlessly integrated into the living space, is beautifully designed and well-equipped with top-of-the-line appliances. From this exceptional living area, residents can enjoy breath-taking views over Ramsey golf course.

The apartment comprises two well-appointed bedrooms, each offering a tranquil retreat. The master bedroom boasts an en suite shower room, providing privacy and convenience. The second bedroom, serviced by a guest bathroom, offers ample space and is versatile enough to be used as a home office or study if desired. With high-quality fixtures and finishes throughout, this first floor apartment offers truly luxurious living in a desirable location. The Pavilions is a gated community which makes it an ideal lock and leave property, residents can also enjoy direct access onto Ramsey golf course.

FEATURES

- Immaculate Purpose Built Apartment
- Gated Development
- Direct Access to Ramsey Golf Course
- Large Lounge/Diner with Dual Aspect Windows
- Superb Fitted Kitchen with Granite Worktops
- Master Bedroom with En Suite Shower Room
- Additional Double Bedroom with Three Piece Bathroom
- Private West Facing Balcony
- Views over Ramsey Golf Course
- Two Allocated Parking Spaces



Property Images



FLOORPLAN

GROUND FLOOR
1191 sq.ft. (110.6 sq.m.) approx.

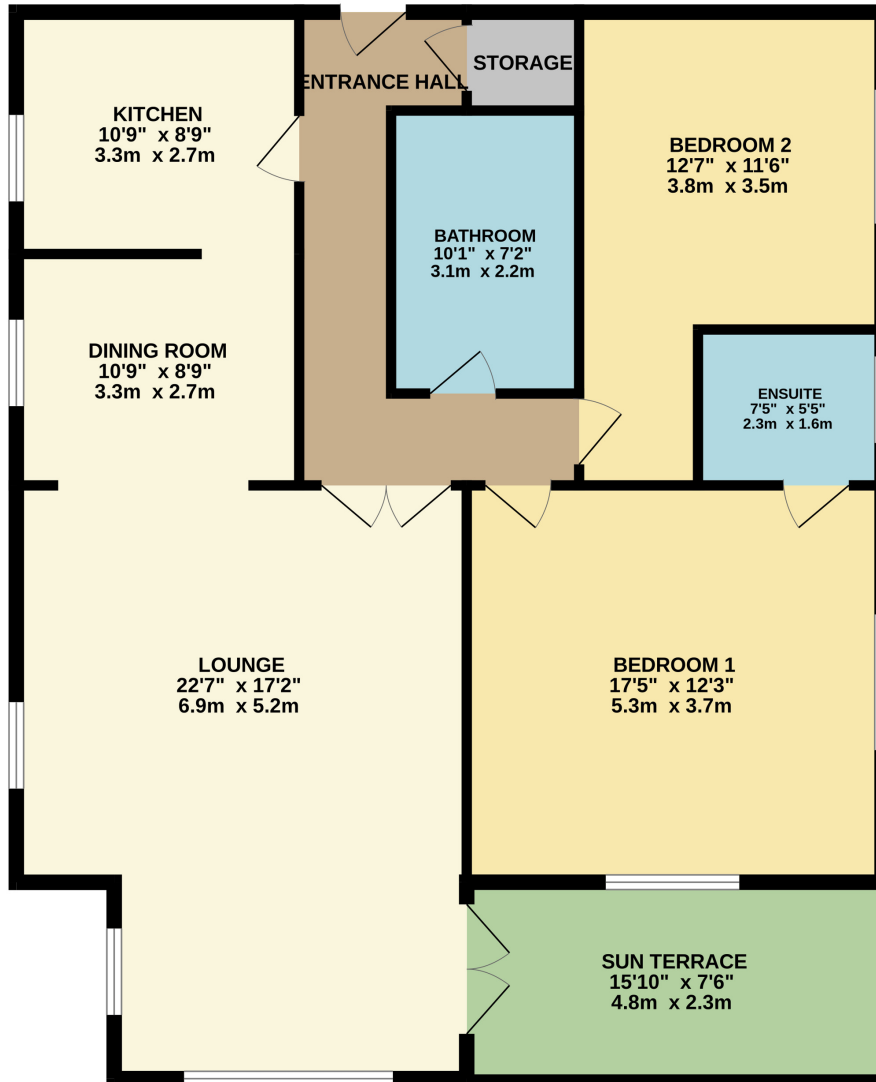

TOTAL FLOOR AREA: 1191 sq.ft. (110.6 sq.m.) approx.
Whilst every attempt has been made to ensure the accuracy of the floorplan contained here, measurements of doors, windows, rooms and any other items are approximate and no responsibility is taken for any error, omission or mis-statement. This plan is for illustrative purposes only and should be used as such by any prospective purchaser. The services, systems and appliances shown have not been tested and no guarantee as to their operability or efficiency can be given.
Made with Metropix ©2024

DISCLAIMER: Whilst Manxmove Ltd believe that these details are correct, neither Manxmove Ltd or their clients guarantee their accuracy in any way. Consequently, these details are not to be used to form part of any legally binding contract. Prospective purchasers or tenants are advised to visit this property to satisfy themselves as to the correctness of these details. Please note, we use wide angle camera lenses in order to show as much of each room as possible. This is not intended to mislead any prospective purchasers or tenants in any way and an honest verbal description is always available prior to viewing if required.