

FOR SALE

Greenside Road,
Shepherd's Bush, W12

Terraced House
Ravenscourt Park

£1,250,000 fh

3  2  2 



**horton
andgarton**

SALES / LETTINGS / PROPERTY MANAGEMENT

hortonandgarton.co.uk | Sales 020 8819 0510 | Lettings 020 8819 0511
172 King Street, Hammersmith, W6 0QU



FOR SALE

Greenside Road,
Shepherd's Bush, W12

Terraced House
Ravenscourt Park

£1,250,000 fh

3  2  2 



**horton
andgarton**

SALES / LETTINGS / PROPERTY MANAGEMENT

hortonandgarton.co.uk | Sales 020 8819 0510 | Lettings 020 8819 0511
172 King Street, Hammersmith, W6 0QU



FOR SALE

Greenside Road,
Shepherd's Bush, W12

Terraced House
Ravenscourt Park

£1,250,000 fh

3  2  2 



**horton
andgarton**

SALES / LETTINGS / PROPERTY MANAGEMENT

hortonandgarton.co.uk | Sales 020 8819 0510 | Lettings 020 8819 0511

172 King Street, Hammersmith, W6 0QU



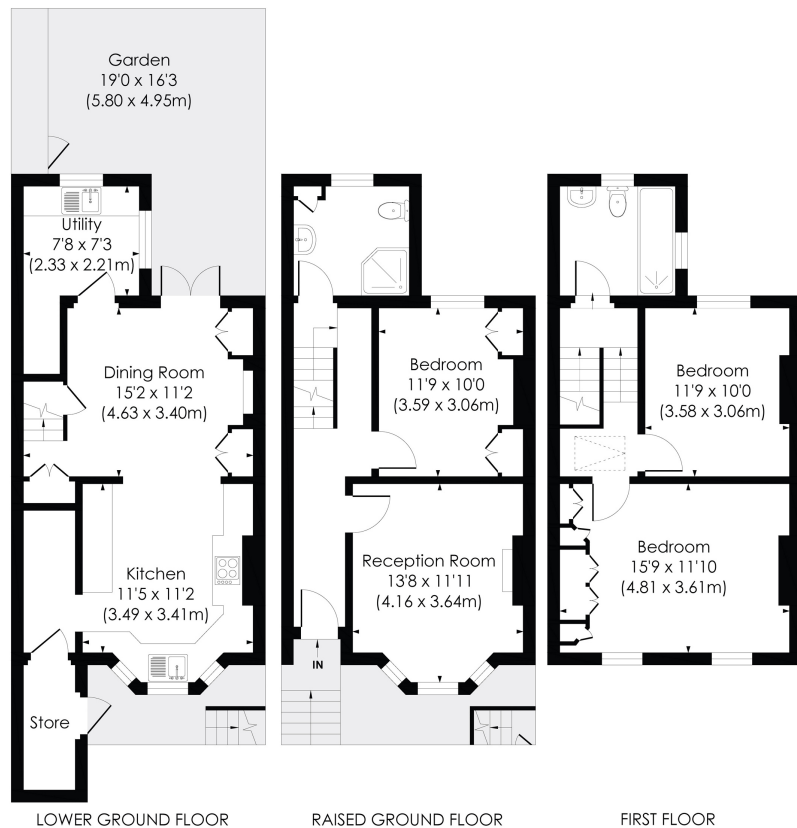

GREENSIDE ROAD, W12

Approx. Gross Internal Floor Area
1294 Sq' / 120.2 SqM (Excluding Store)
 Store: 32 Sq' / 2.99 SqM

© Pixangle Property Marketing Ltd. info@pixangle.com Tel: 0208 870 2118

**horton
andgarton**

This floor plan has been prepared for the purpose of illustration only in accordance with the latest RICS code of measuring practice and is not to scale. All measurements and areas are approximate and whilst every effort has been made to ensure the accuracy of the plan contained here, no responsibility is taken for any error, omission or misstatement.



Victorian family house | Three bedrooms - Two
 bathrooms | 1294 Sq' - 120.20 SqM | Superb condition
 throughout | EPC rating D | Ravenscourt Park



hortonandgarton.co.uk
 Sales 020 8819 0510
 Lettings 020 8819 0511

172 King Street, Hammersmith, W6 0QU