



THE ESTATE AGENTS
1977



166 Woodpecker Way, Northampton NN4 0QP
Guide Price £100,000 - Leasehold



PROPERTY DESCRIPTION

The Estate Agents are pleased to present this one bedroom, ground floor apartment, with garden and off road parking, in the highly desirable and sought after area of East Hunsbury. The accommodation briefly comprises; entrance hall with storage, living room opening into the garden, kitchen, bedroom and bathroom. Outside there's a lovely garden offering a good degree of privacy and three of road parking spaces.

There's approximately 87 years remaining on the lease.

POINTS OF INTEREST

- One Bedroom Apartment
- Ground Floor
- Garden
- Three Off Road Parking Spaces
- Highly Sought After Location
- Cul De Sac Location
- No Upward Chain
- Ideal Investment
- Cash Buyers Only

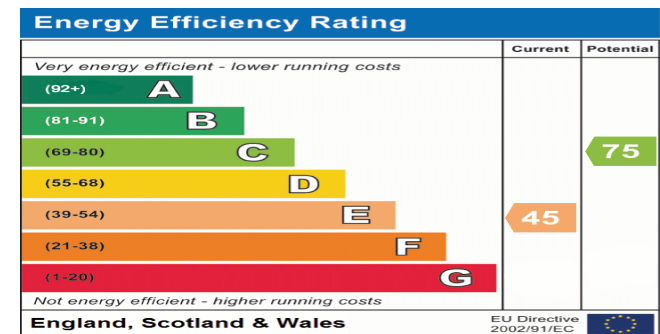

GROUND FLOOR
288 sq.ft. (26.8 sq.m.) approx.

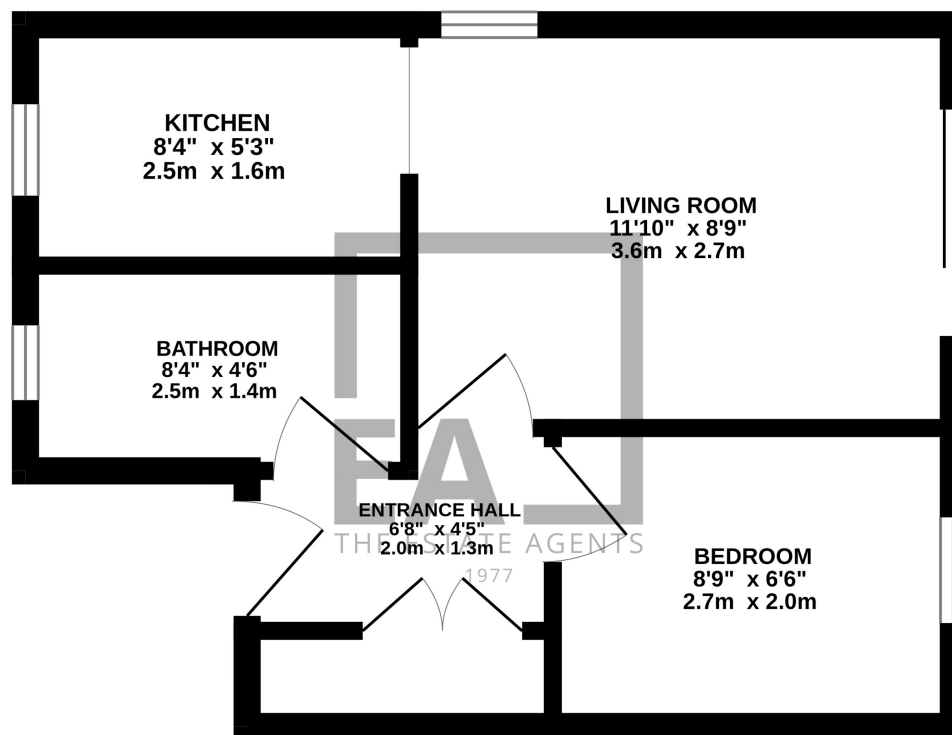

TOTAL FLOOR AREA : 288sq.ft. (26.8 sq.m.) approx.

Whilst every attempt has been made to ensure the accuracy of the floorplan contained here, measurements of doors, windows, rooms and any other items are approximate and no responsibility is taken for any error, omission or mis-statement. This plan is for illustrative purposes only and should be used as such by any prospective purchaser. The services, systems and appliances shown have not been tested and no guarantee as to their operability or efficiency can be given.

Made with Metropix ©2025