

FOR SALE

£400,000

Blandford Road, Beckenham, BR3



A two bedroom ground floor maisonette with its own private entrance, private garden and Share of Freehold offered chain free. Located just moments from Clock House, Kent House and Birkbeck stations.

Situated on a well located residential road, this well-maintained two double bedroom ground floor maisonette is offered to the market chain free and benefits from its own private entrance and a private rear garden.

Inside, the property features a bright living room off of a separate kitchen, two generous double bedrooms, and a family bathroom. Additional features include double glazing and gas central heating throughout.

Located within walking distance of Clock House, Kent House, and Birkbeck stations, this home provides excellent transport links into Central London. Local amenities, including shops, cafés, gyms, and restaurants, are all close by, along with a variety of green spaces, including South Norwood Country Park and Cator Park nearby.

With a Share of Freehold, private garden, and no onward chain, this home is an ideal purchase for first-time buyers, downsizers, or investors. Viewings are highly recommended.

- Share of Freehold
- Two bedrooms
- Private Entrance
- Private Garden
- Excellent Transport Links
- EPC Rating C





Blandford Road, Beckenham, BR3

Approximate Area = 680 sq ft / 63.2 sq m
For identification only - Not to scale

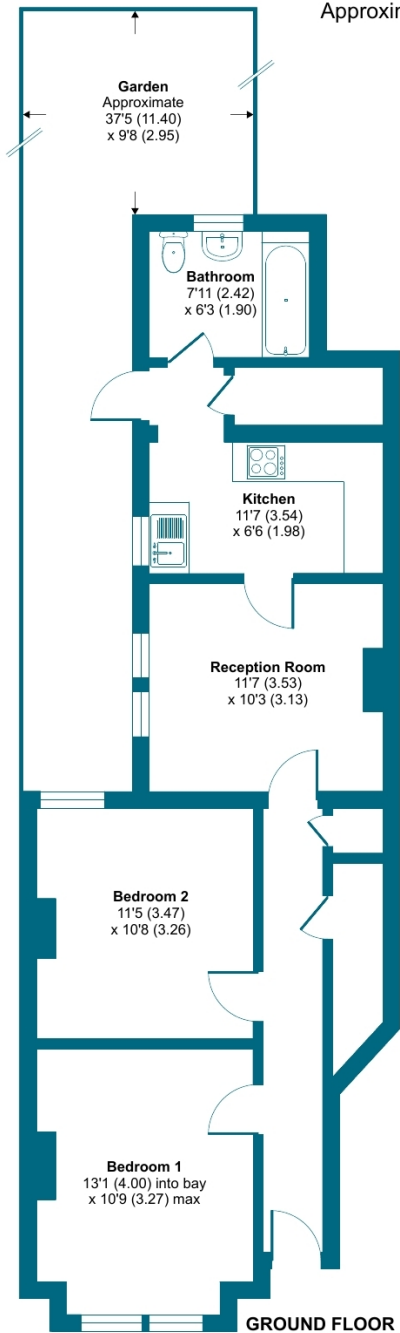

GROUND FLOOR



Floor plan produced in accordance with RICS Property Measurement 2nd Edition, Incorporating International Property Measurement Standards (IPMS2 Residential). © nitchecom 2025. Produced for Grafton Estate Agents. REF: 1332039

