

£230,000  
Leasehold



**THOMAS CONNOLLY**

ESTATE AGENTS | LETTING AGENTS | NEW HOMES | PROPERTY MANAGEMENT



## Summary of Property

Thomas Connolly Estate Agents are delighted to offer for sale this two bedroom ground floor apartment located in Campbell Park, Central Milton Keynes offering close proximity to the central shopping district, restaurants, bars, TRAIN STATION and all local amenities.

Accommodation briefly comprises; entrance hall, kitchen, living / dining area with access to feature balcony looking onto opposing parkland, two bedrooms with an en-suite to the master bedroom with wardrobes, a bathroom and storage cupboard. The property further benefits from gas central heating, allocated private underground parking, a lift and entry communication system. An early viewing is highly recommended

Please note the following charges: Ground Rent £250pa. Service Charge £2200pa.

Please contact Thomas Connolly Estate Agents for further information or to confirm your viewing appointment; T: 01908 774422

## Room Descriptions

### ENTRANCE HALL:

### KITCHEN:

6' 8" x 9' 4" (2.03m x 2.84m) 0m x 0m (0' 0" x 0' 0")

### SITTING ROOM:

10' 8" x 20' 4" (3.25m x 6.20m)

### BATHROOM:

### BEDROOM ONE:

11' 2" x 13' 6" (3.40m x 4.11m)

### ENSUITE:

### BEDROOM TWO:

10' 4" x 12' 8" (3.15m x 3.86m)

### BALCONY:

### OUTSIDE:

### SECURE UNDERGROUND PARKING:



# THOMAS CONNOLLY

ESTATE AGENTS | LETTING AGENTS | NEW HOMES | PROPERTY MANAGEMENT

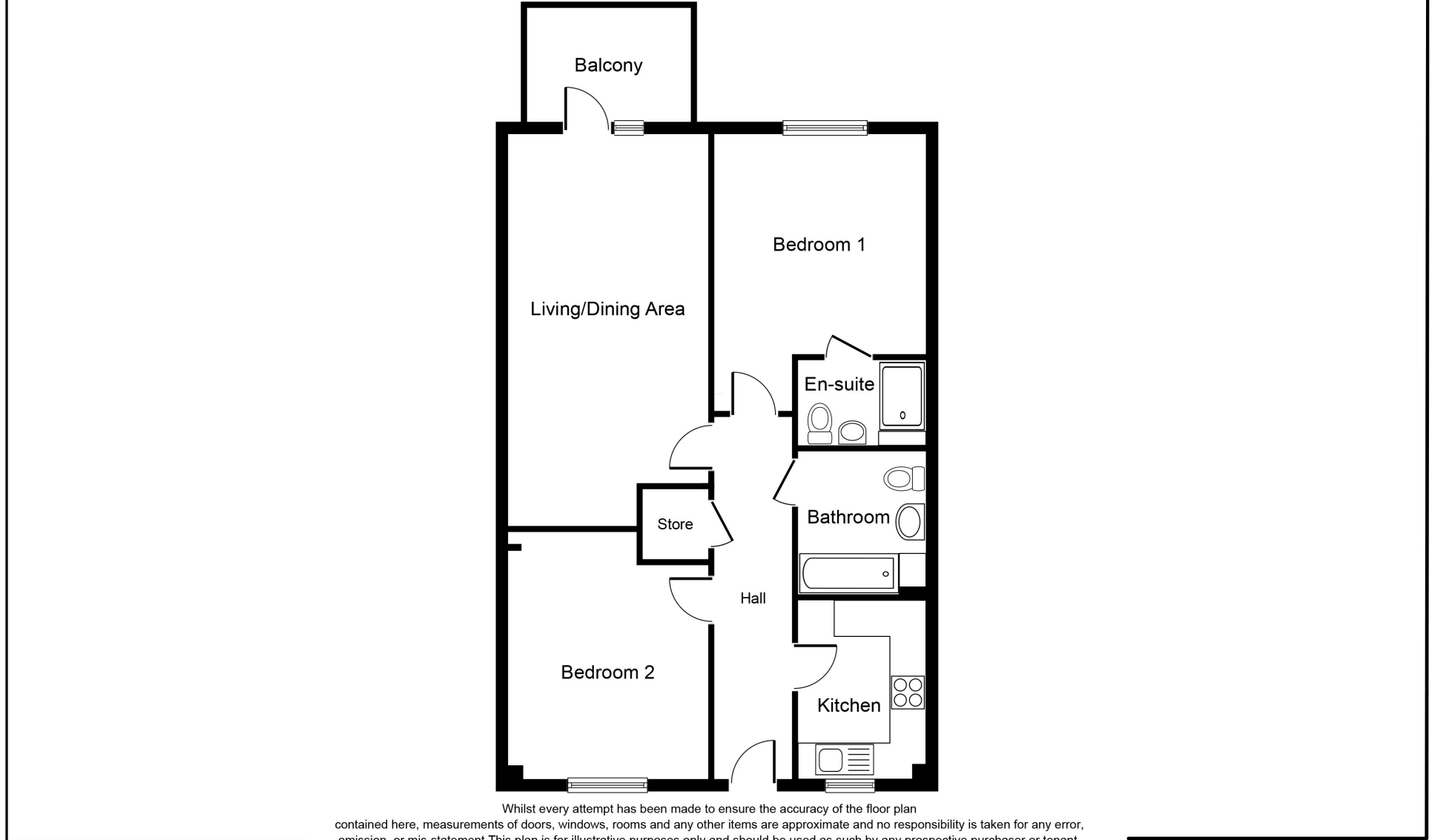

Whilst every attempt has been made to ensure the accuracy of the floor plan contained here, measurements of doors, windows, rooms and any other items are approximate and no responsibility is taken for any error, omission, or mis-statement This plan is for illustrative purposes only and should be used as such by any prospective purchaser or tenant. The services, systems and appliances shown have not been tested and no guarantee as to their operability or efficiency can be given.

Copyright V360 Ltd 2024 | [www.houseviz.com](http://www.houseviz.com)