



diamond
PROPERTIES



306 The Gateway West, Leeds City Centre, Leeds. LS9 8DZ.

£125,000 Leasehold

- Open plan living
- Amenities on site
- Achieving £775 PCM

306 The Gateway West, Leeds City Centre, Leeds. LS9 8DZ.

£125,000 Leasehold

Diamond Properties are pleased to offer a stunning third floor apartment in the popular Gateway complex. A short walk to many local amenities in the heart of Leeds, with easily accessible bus and train routes.

The apartment benefits from a large double bedroom, house bathroom, spacious open plan kitchen / lounge and a balcony over looking the city.

Gateway is on the junction of East Street , benefiting from an on site gym , local store and under ground parking.

Ideal for first time buyers , investors , professionals and families a like.

*Property is tenanted until December 2025, achieving £775 per calendar month.

Service charge - £2340 per annum.

Ground rent - £250 per annum.

Lease length: 150 years from 2006

Viewing via appointment only

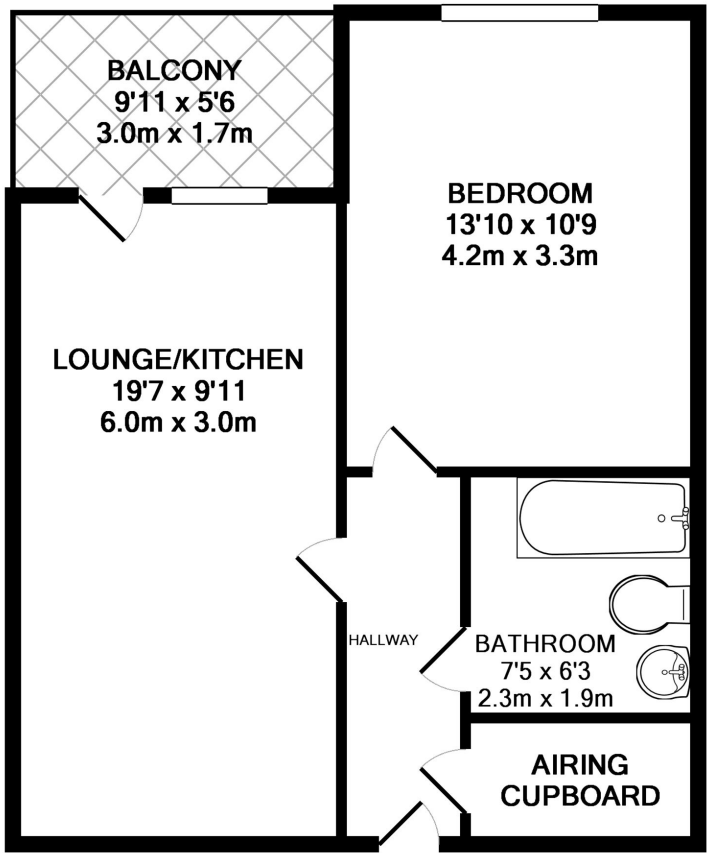

TOTAL APPROX. FLOOR AREA 463 SQ.FT. (43.1 SQ.M.)

Whilst every attempt has been made to ensure the accuracy of the floor plan contained here, measurements of doors, windows, rooms and any other items are approximate and no responsibility is taken for any error, omission, or mis-statement. This plan is for illustrative purposes only and should be used as such by any prospective purchaser. The services, systems and appliances shown have not been tested and no guarantee as to their operability or efficiency can be given
Made with Metropix ©2018

