



DP DERBYSHIRE
PROPERTIES
— SALES & LETTINGS —



Bridle Lane, Lower Hartshay, Ripley, Derbyshire DE5 3RQ
£425,000 -



PROPERTY DESCRIPTION

Derbyshire Properties are delighted to present for sale this charming and characterful period home, located in the picturesque hamlet of Lower Hartshay. Conveniently positioned between the towns of Belper and Ripley, the property offers excellent road links including the A610, A38, and M1 (Junction 28) just 5 miles away—making it ideal for commuters. The location enjoys rolling countryside views, peaceful surroundings, and a sought-after village pub, all of which add to the rural charm of this delightful setting. The accommodation is arranged over three floors, blending original period features with modern fixtures and fittings to create a truly beautiful and versatile family home. Externally, the property benefits from ample off-road parking to the front, and a generous paddock to the rear—perfect for those with an interest in keeping horses or livestock. The surrounding countryside provides a stunning backdrop and adds to the sense of privacy and space. We believe this unique property will appeal particularly to buyers seeking a semi-rural lifestyle with land. A viewing is essential to fully appreciate the accommodation and outdoor space on offer.

POINTS OF INTEREST

- Charming Character Cottage
- Accommodation Over 3 Floors
- Original Character Features Throughout
- Parking for Numerous Vehicles
- Large Paddock To The Rear
- Quiet Countryside Position
- Beautifully Presented Throughout
- Sought After Village
- Viewing Essential
- Council Tax Band B

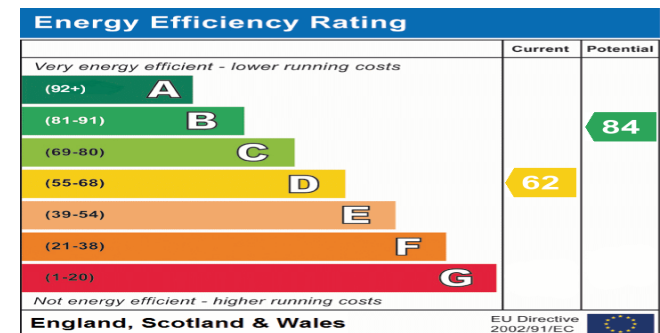

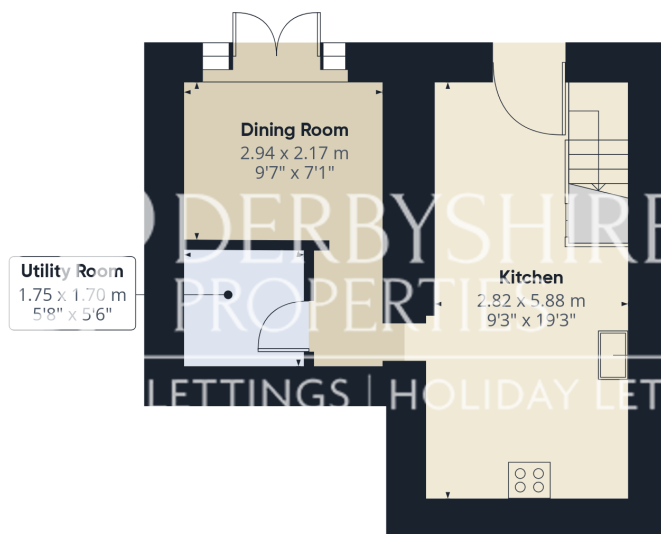

Ground Floor



Floor 1

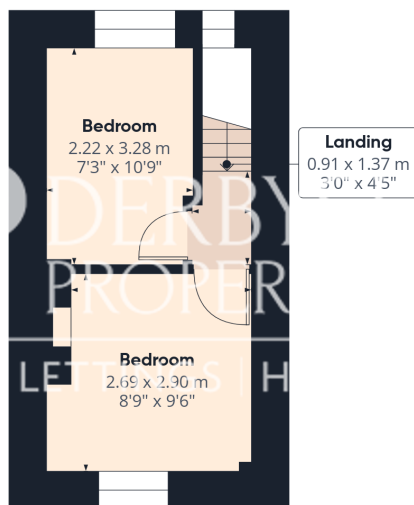

Floor 2

Approximate total area⁽¹⁾

79.7 m²
857 ft²

(1) Excluding balconies and terraces

Calculations reference the RICS IPMS 3C standard. Measurements are approximate and not to scale. This floor plan is intended for illustration only.

GIRAFFE360