

FOR SALE

£355,000

Ashdown Drive, Greasby, Wirral. CH49 3QU



Extended Detached Bungalow! This charming 2/3 bedroom residence has been well-maintained by our sellers offering well-proportioned living space throughout and sits on a generously sized plot. Nicely positioned at the top of Ashdown Drive giving the property that extra bit of privacy, you are instantly impressed on arrival by the ample off road parking and detached garage on offer.

The accommodation sits on a single level making it the ideal downsize and is nearby to Greasby Village where a buyer can benefit from amenities such as shops, pubs, restaurants and bus services to West Kirby and Liverpool.

Ground Floor

Kitchen

13' 0" x 11' 6" (3.96m x 3.51m)

Bathroom

5' 11" x 5' 11" (1.80m x 1.80m)

WC

Lounge

15' 0" x 19' 2" (4.57m x 5.84m)

Bedroom

9' 7" x 14' 11" (2.92m x 4.55m)

Bedroom

9' 11" x 11' 5" (3.02m x 3.48m)

Bedroom

8' 0" x 11' 5" (2.44m x 3.48m)

Conservatory

16' 10" x 9' 4" (5.13m x 2.84m)





Ground Floor

Garage

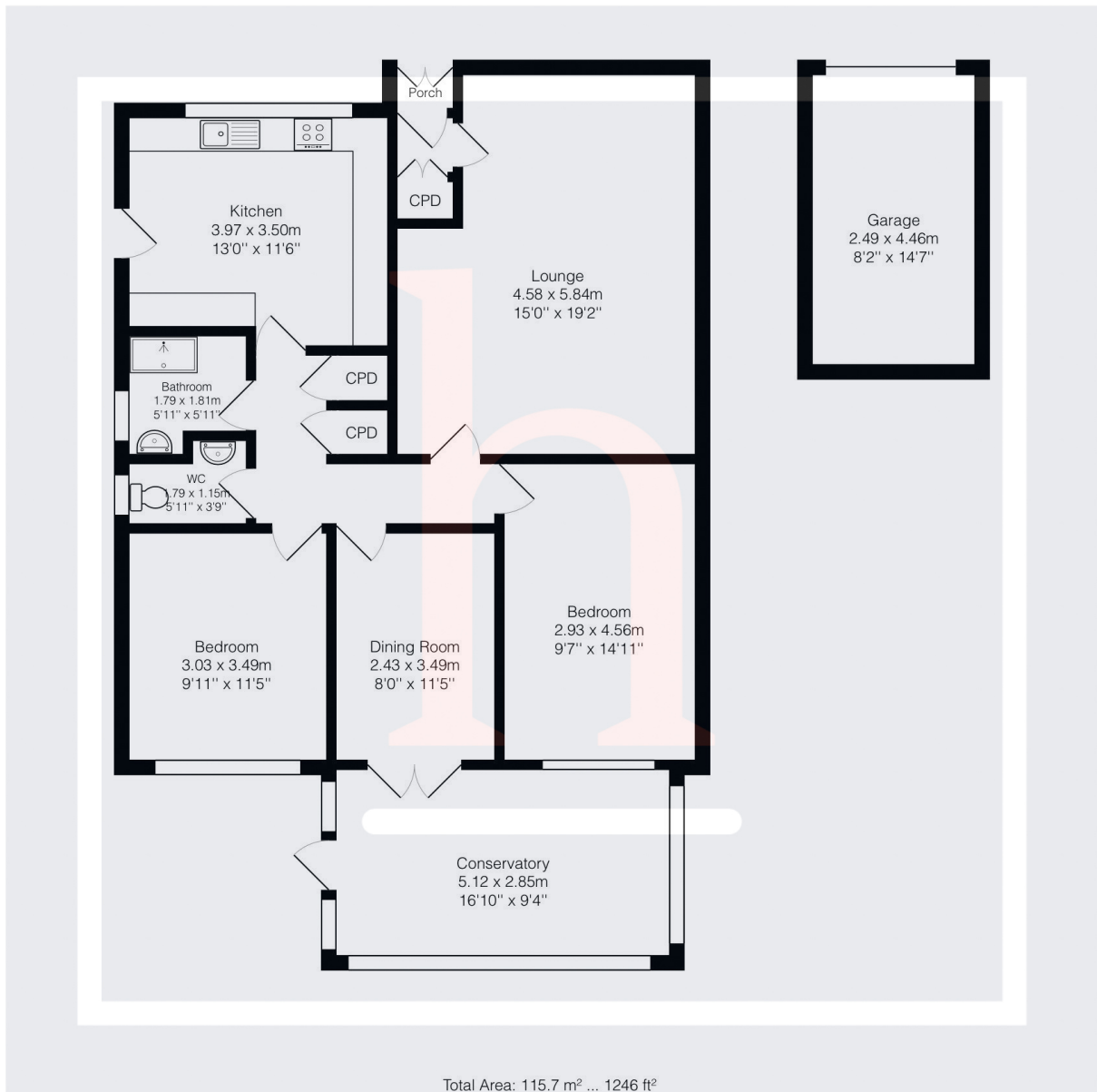

Total Area: 115.7 m² ... 1246 ft²

All measurements are approximate and for display purposes only.