

9 Whittle Court,  
Knowlhill, Milton Keynes, MK5 8FT

Tel: 01908 231 551   
mail@elevationstateagents.com



## 9 Worth Court, Monkston, Milton Keynes, Buckinghamshire, MK10 9LU

### £360,000 Freehold

- Great school catchment and local amenities
- Three good size bedrooms
- Large conservatory
- Parking for three cars
- Desirable and highly sought after location
- New kitchen
- EPC Rating





A three bedroom property within the popular area of Monkston which has excellent schooling and local shops.

Presented in good condition the accommodation comprises of lounge/dinning room leading into the conservatory which overlooks the large garden. The kitchen is at the front of the house along with a cloakroom. To the first floor there are three bedrooms, master bedrooms and then two further bedrooms and a main bathroom.

Outside you will find a laid to lawn rear garden with gated access, to the side you will find a driveway to the rear for off road parking for 1 car. There is further parking to the front for up to 4 cars.

Monkston is ideally located east side of Milton Keynes, within a short distance to the Kingston Shopping centre. The Shopping centre has an array of shops such as: Tesco superstore, home sense, Costa, Smash Burger, Nando's, Boots and many more, Gym facilities are also close by. This area is also located within a short distance from the junction 13 M1 motorway and Central Milton Keynes.

### Disclaimer

Whilst we have endeavoured to prepare our sales particulars accurately none of the services, appliances or equipment have been tested. A buyer should satisfy themselves on such matters prior to purchase. Any measurements or distances mentioned in these particulars are for guide reference only. If such particulars are fundamental to a purchase, buyers should rely on their own enquiries. All enquiries should be directed to Elevation Estate Agents in the first instance.

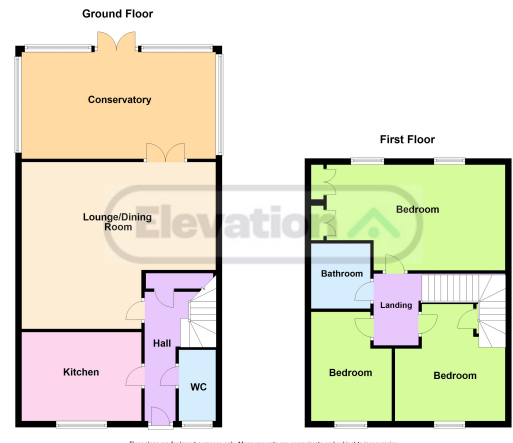

Floor plans are for layout purposes only. Measurements are approximate and subject to inaccuracies. Plans produced using Planific.