



# Willow Tree Court

Crow Wood Lane



0151 424 5100  
[info@mylerestates.com](mailto:info@mylerestates.com)



# Willow Tree Court

Widnes, WA8 3LZ

OIRO £160,000

Offered to market, NO CHAIN, TWO BEDROOM BUNGALOW, Located in a GATED SECURE community with allocated parking. Close to all local amenities, shops, schools, pubs & restaurants, WALKING DISTANCE TO TOWN CENTRE and with good access to ROAD & RAILWAY links. Viewings are highly recommended!!





### Porch

Laminate to floor, ceiling light, UPVC double glazed window, radiator, door to hall.

### Entrance Hall

Laminate to floor, ceiling light, radiator, doors to lounge, two bedrooms and bathroom.

### Lounge / Diner

7.52m x 4.61m (24' 8" x 15' 1")

#### Lounge area

Carpet to floor, ceiling light, two radiators, UPVC double glazed window, door to bedroom one.

#### Dining Area

Carpet to floor, ceiling light, radiator, archway to kitchen.

### Kitchen

2.83m x 2.58m (9' 3" x 8' 6")

Laminate to floor, ceiling spot lights, UPVC double glazed window, kitchen comprises of a range of wall and base units with work surface over, stainless steel cooker and gas hob with extractor canopy over, space and plumbing for fridge freezer & washing machine.

### Bedroom One

4.56m x 2.90m (15' 0" x 9' 6")

Carpet to floor, ceiling light, radiator, UPVC

### Bedroom Two

4.61m x 2.81m (15' 1" x 9' 3")

Carpet to floor, ceiling light, radiator, UPVC double glazed window.

### Bathroom

Vinyl to floor, ceiling spot lights, radiator, UPVC double glazed obscured window, double shower cubicle with chrome mixer shower, vanity hand wash basin and low level W/C.



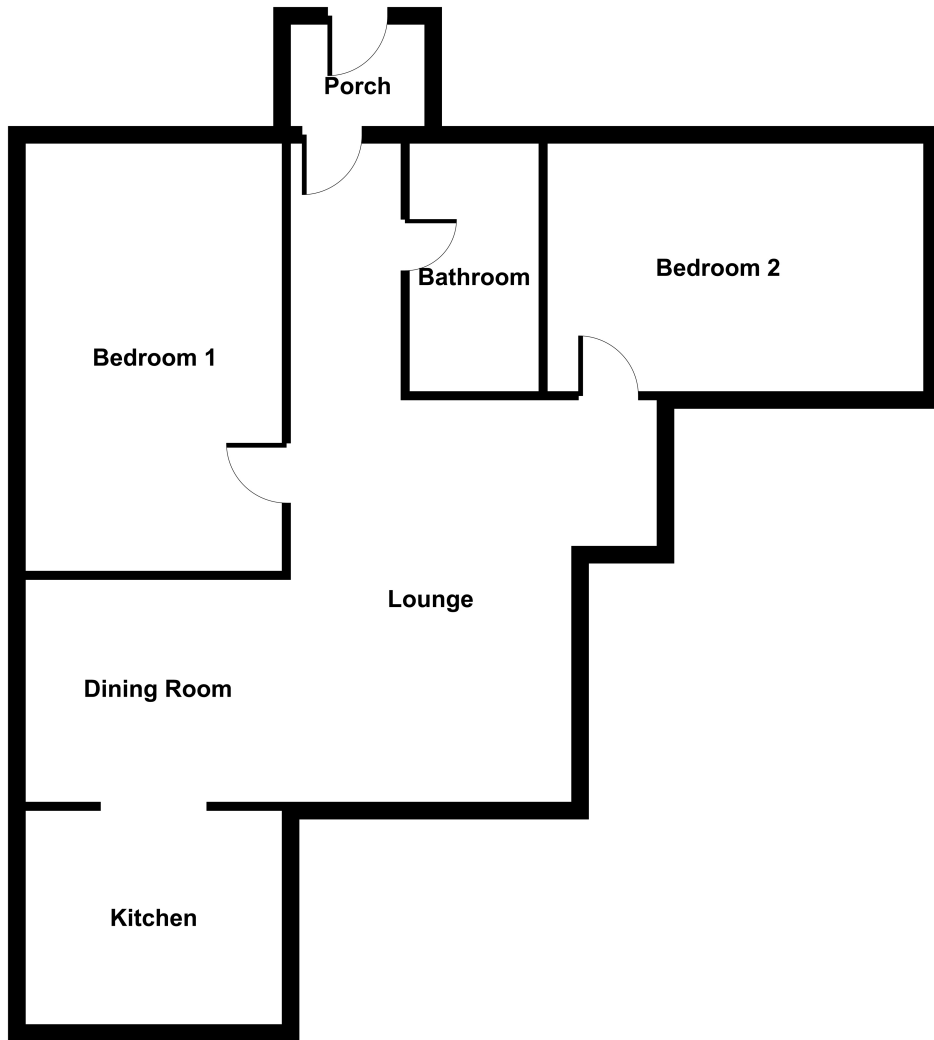

Myler & Co  
77, Albert Road, Widnes, Cheshire, WA8 6JS  
0151 424 5100  
[info@mylerestates.com](mailto:info@mylerestates.com)