

Carville Crescent, TW8

Approximate Floor Area = 51.5 sq m / 554 sq ft
Outbuilding = 4.4 sq m / 47 sq ft
Total = 55.9 sq m / 601 sq ft

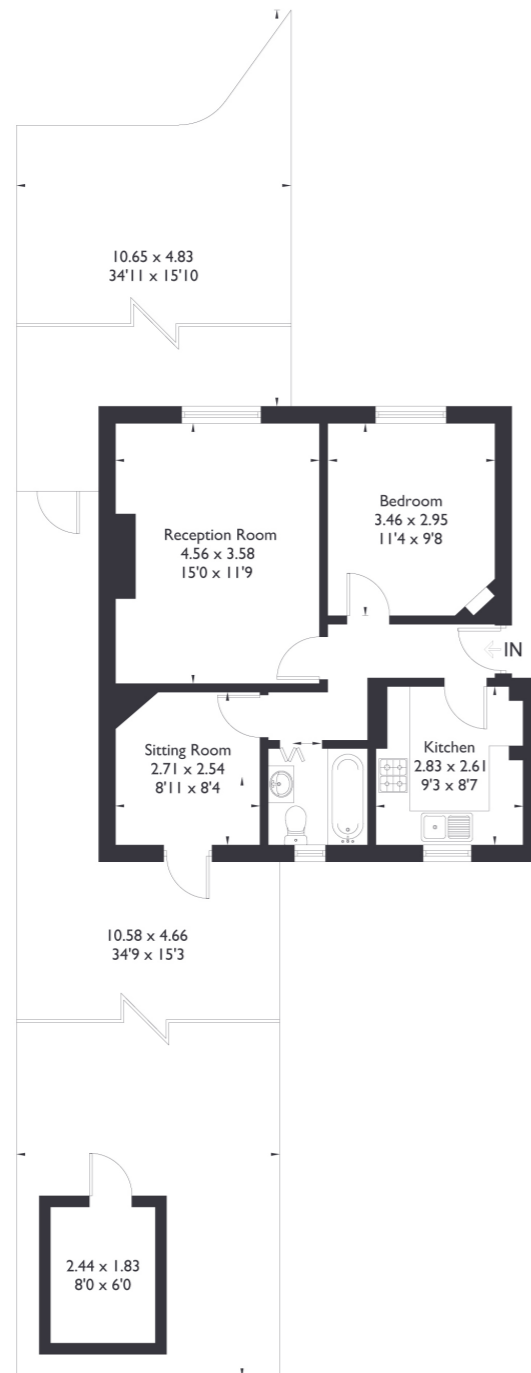

Ground Floor



2 BEDROOM FLAT

Carville Crescent, TW8

£400,000

Welcome to this beautifully presented two bedroom, one bathroom garden flat, situated in a fantastic location. The property boasts a stunning interior and is thoughtfully designed throughout. Upon entering, you'll find a spacious kitchen to your left and a generous double bedroom to your right. Moving through the hallway, this space opens up into a large, light filled reception room.

FEATURES

- Two Bedrooms
- One Bathroom
- Separate Reception
- Private Garden Side And Rear Access
- Contemporary Design
- Kew Bridge Station
- Lionel Primary School Catchment
- Gunnersbury Park



2 BEDROOM FLAT

Carville Crescent, TW8

Toward the rear, there's a chic, modern bathroom and a second, smaller bedroom that leads directly to a private garden. With contemporary features throughout, this home seamlessly blends style with functionality.

Situated in a prime location, it's just a short stroll from the beautiful Gunnersbury Park and is close to the amenities of South Ealing.

The property also falls within the catchment area of the highly regarded Lionel Primary School. Excellent transport links are easily accessible, with Kew Bridge station only a 10 minute walk away and South Ealing Station (Piccadilly Line) nearby.

The Great West Road is just 2 minutes away via car which makes access to the city super easy, enhancing the property's overall convenience.

EPC Rating D.

