



48 Saddle Mews, Douglas, Isle of Man. IM2 1HS

Well presented first floor apartment with private entrance, spacious lounge/diner with views over communal gardens, generous double bedroom with fitted wardrobes and South facing balcony. All offered with no onward chain.



£175,000 Leasehold

PROPERTY DESCRIPTION

A well-presented first-floor, purpose-built apartment situated within a popular and well-maintained development for residents aged 50 years and over. Offered to the market with no onward chain, the property occupies a quiet cul-de-sac position and is conveniently located within walking distance of a regular bus route.

The accommodation is light and well proportioned, comprising a spacious living/dining room with an abundance of natural light, a separate fitted kitchen, and a generous double bedroom benefiting from built-in wardrobes. A modern shower room completes the internal layout, providing stylish and practical facilities.

Externally, the apartment enjoys the added benefit of a private South facing balcony, accessed from the bedroom area, offering a pleasant space to sit and relax.

The development is further enhanced by beautifully maintained communal landscaped gardens and communal parking for residents and visitors. This attractive apartment offers comfortable, low-maintenance living in a peaceful setting, while remaining conveniently close to local amenities and transport links.

Tenure - Leasehold with active management company in place (Saddle Mews Residents Association) charges are circa £165pcm and include boiler and exterior maintenance.

FEATURES

- Well Presented 1st Floor Apartment
- Well Run Over 50's Development
- Beautiful Communal Gardens
- Spacious Lounge/Diner plus Kitchen
- Large Double Bedroom with Fitted Wardrobes
- South Facing Balcony
- Communal Parking
- No Onward Chain



Property Images



FLOORPLAN

GROUND FLOOR

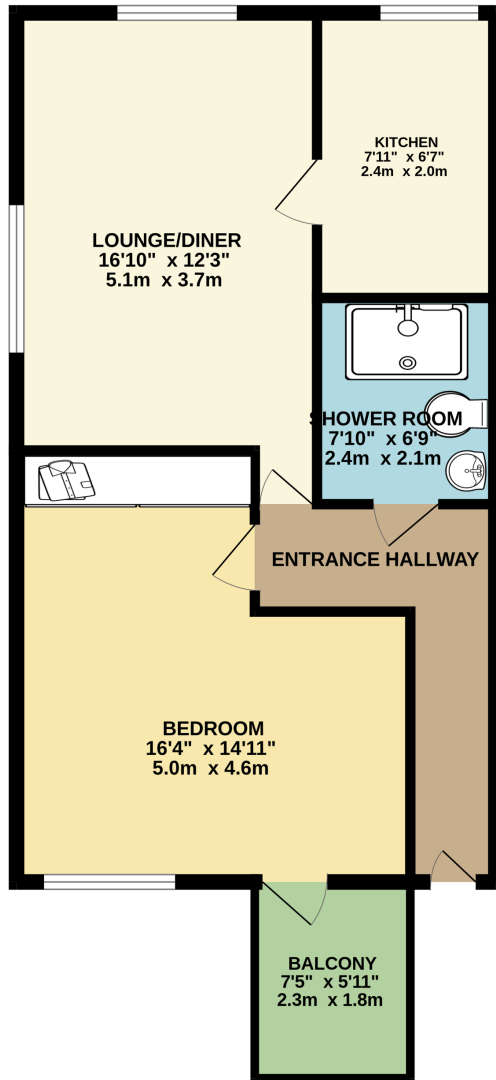

Whilst every attempt has been made to ensure the accuracy of the floorplan contained here, measurements of doors, windows, rooms and any other items are approximate and no responsibility is taken for any error, omission or mis-statement. This plan is for illustrative purposes only and should be used as such by any prospective purchaser. The services, systems and appliances shown have not been tested and no guarantee as to their operability or efficiency can be given.
Made with Metropix ©2026

DISCLAIMER: Whilst Manxmove Ltd believe that these details are correct, neither Manxmove Ltd or their clients guarantee their accuracy in any way. Consequently, these details are not to be used to form part of any legally binding contract. Prospective purchasers or tenants are advised to visit this property to satisfy themselves as to the correctness of these details. Please note, we use wide angle camera lenses in order to show as much of each room as possible. This is not intended to mislead any prospective purchasers or tenants in any way and an honest verbal description is always available prior to viewing if required.