

Cruikshank Grove, Locking Parklands, Weston-Super-Mare,
Somerset. BS24 7NL

Shared Ownership £140,000 Leasehold

FOR SALE



HOUSE FOX
ESTATE AGENTS

www.housefox.co.uk

01934 314242
01275 404601
01278 557700
sales@housefox.co.uk

PROPERTY DESCRIPTION

HOUSE FOX ESTATE AGENTS PRESENTS.....WOW, what an opportunity to get on to the ladder, and jump straight to a 3 bedroom home, in a highly sought after location.

This property is being SOLD WITH 50% OWNERSHIP and 50% Rent.

THE ASKING PRICE IS OFFERS IN EXCESS OF £140,000, BUT YOU WILL ONLY OWN 50% OF THE PROPERTY, Heylo will own the other 50%, but you are able to purchase the full amount, subject to speaking with Heylo

The rent is £410...Monthly lease management fee £26.....Buildings insurance £13.....Local management fee £20, so you add these figures to your monthly mortgage payment, to get your final figure for your monthly cost of mortgage/rent

The house is presented in immaculate condition, and comprises hallway, cloakroom, kitchen, living room with double doors to the landscaped garden, 3 bedrooms, family bathroom, en-suite shower room, plus gas central heating, double glazing, 2 parking spaces, and a great landscaped garden, perfect for entertaining

FEATURES

- WALK THROUGH 360 VIDEO TOUR AVAILABLE
- SHARED OWNERSHIP 50% plus rent
- End of terrace house
- Immaculate condition
- 3 bedrooms
- Lounge with double doors onto the garden
- Landscaped Garden
- Cloakroom
- Bathroom and en-suite shower room
- EPC-B



ROOM DESCRIPTIONS

Main front door to the hallway

Hallway:

Stairs to the first floor,
understairs cupboard

Cloakroom:

WC, radiator, wash hand basin,
double glazed window

Living room:

4.63m x 3.28m (15' 2" x 10' 9")
Radiator, double glazed double
doors to the garden

Kitchen:

3.30m x 2.43m (10' 10" x 8' 0")
Sink unit, floor and wall units,
breakfast bar, double glazed
window, built in oven and hob,
extractor fan over, plumbing for
washing machine

First floor landing

Bedroom 1:

2.89m x 2.47m (9' 6" x 8' 1")
Radiator, double glazed window,
built in wardrobe, door to the
en-suite

En-suite shower room

Shower cubicle, wash hand
basin, WC, double glazed
window, heated towel rail

Bedroom 2

3.08m x 2.69m (10' 1" x 8' 10")
Double glazed window, radiator

Bedroom 3:

3.25m x 1.86m (10' 8" x 6' 1")
Radiator, double glazed window

Bathroom:

Bath with shower over, wash
hand basin, WC, heated towel
rail

Rear garden:

Patio area, artificial grass area,
decked area, all enclosed by
fencing plus a side gate

Parking:

2 parking spaces to the front of
the house



FLOORPLAN & EPC

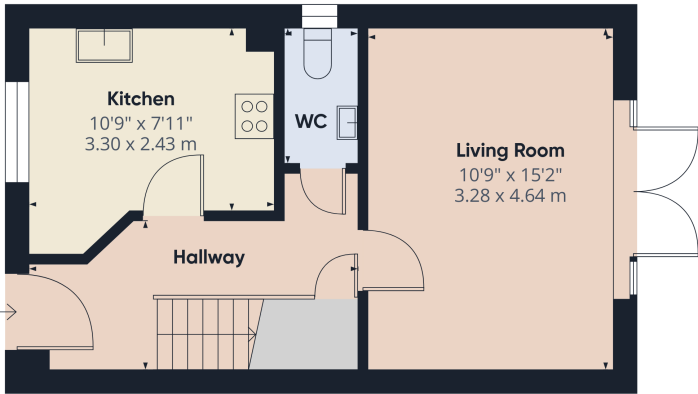

Floor 0

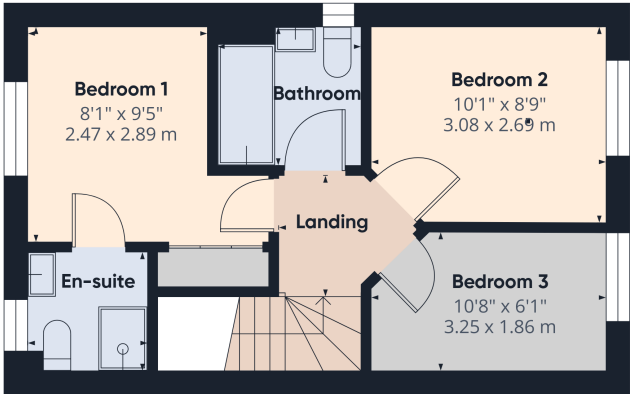

Floor 1



Approximate total area⁽¹⁾
715 ft²
66.4 m²

(1) Excluding balconies and terraces

Calculations reference the RICS IPMS 3C standard. Measurements are approximate and not to scale. This floor plan is intended for illustration only.

GIRAFFE360

