



15/3 Hutchison Terrace, Chesser, Edinburgh, EH14 1QD

Beautifully Presented, Spacious, Two-Bedroom, Triple-Aspect, First-Floor Flat

Up to date price and viewing info at mov8realestate.com/property

espc rightmove  Zoopla
find your happy

Property Description

Beautifully presented, spacious, two-bedroom, triple-aspect, first-floor flat, forming part of an established development. Conveniently located in the popular Chesser area, lying west of Edinburgh city centre.

Comprises an entrance hall, living/dining room, kitchen, two double bedrooms and a shower room.

Highlights include a modern fitted kitchen, with appliances, and solid wood worktops, a contemporary bathroom suite, and a log-burning stove. In addition, there is gas central heating, double glazing, hardwood flooring, an upgraded front door and good storage.

To the rear is a shared drying green, with a private shed, whilst unrestricted parking is available on the surrounding streets.

A spacious entrance hall, with storage, is finished with light, neutral decor and wood-effect flooring. A well-proportioned living room enjoys plenty of natural light from dual-aspect glazing and features a wood-burning stove, with a rustic timber surround. Plenty of space is available for freestanding furniture and the reception room conveniently opens into a kitchen. Fitted with modern units, solid wood worktops and LED plinth lighting, the kitchen includes an integrated oven, a gas hob, a canopy, a freestanding fridge/freezer, a dishwasher and a washing machine.

Two double bedrooms maximise floor space with integrated wardrobe storage and whilst bedroom two benefits from carpeted flooring, the main bedroom enjoys varnished, hardwood flooring.

Completing the accommodation, a shower room comprises a glazed shower cubicle, a two-piece suite, vanity storage and splash panel walls.



15/3 Hutchison Terrace, Edinburgh EH14 1QD

Approximate Gross Internal Area: (732 sq ft - 68 sq m.)

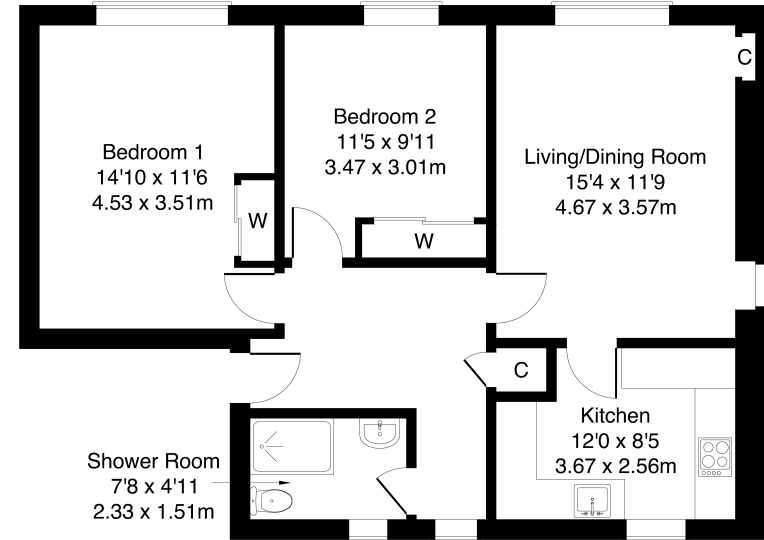
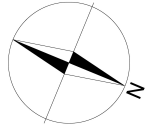

Legal Disclaimer : Floor-plan and measurements are for illustrative guidance only, and not intended to form part of any contract.

Area Description

Chesser is a popular residential area situated west of the city centre, and conveniently placed for a wide range of amenities, including a great selection of local shops, banking and post office facilities, a 24-hour ASDA superstore and the new Edinburgh West Retail Park. Recreational facilities are well catered for by the nearby Edinburgh Corn Exchange, Fountain Park multi-complex, Nuffield

Health Club, Craiglockhart Sports Centre, and numerous golf courses. Excellent transport links are available locally, including regular bus services to and from the city centre, and a railway station at Slateford. Schooling is well represented in the area, whilst Napier, Heriot-Watt and Edinburgh universities are all easily accessible.





Our Services

- Free pre-sale property valuations
- Great value fixed estate agency fees
- Extensive buyer matching database
- Purchase and sale conveyancing

Contact Us

0345 646 0208

sales@mov8realestate.com

www.mov8.com

Head Office

6 Redheughs Rigg, Edinburgh, EH12 9DQ

Glasgow Office

77 Renfrew Street, Glasgow, G2 3BZ



Estate Agents and Solicitors

