



Chatsworth Road, London, NW2

£399,950



Chatsworth Road, London, NW2

An ideal first time purchase is this generously proportioned and well presented one bedroom ground floor apartment offering 558 Sq Ft (51 Sq M) of internal space including a modern reception room and a large bedroom.

This stunning apartment forms part of an impressive recently developed building and is being sold with a long lease along with access to a communal garden and the option of purchasing an allocated parking space as well.

Chatsworth Road is ideally located just moments from Willesden Green station (Jubilee Line) and is also positioned within close proximity to further transport links, local amenities and restaurants.

Features

- Ideal First Time Purchase
- One Bedroom Apartment
- Ground Floor Flat
- Communal Gardens
- Option To Purchase Allocated Parking Space
- Recently Developed Building
- Long Lease
- Fully Fitted Kitchen
- Generously Proportioned



Chatsworth Road,
London, NW2

Chatsworth Road, NW2

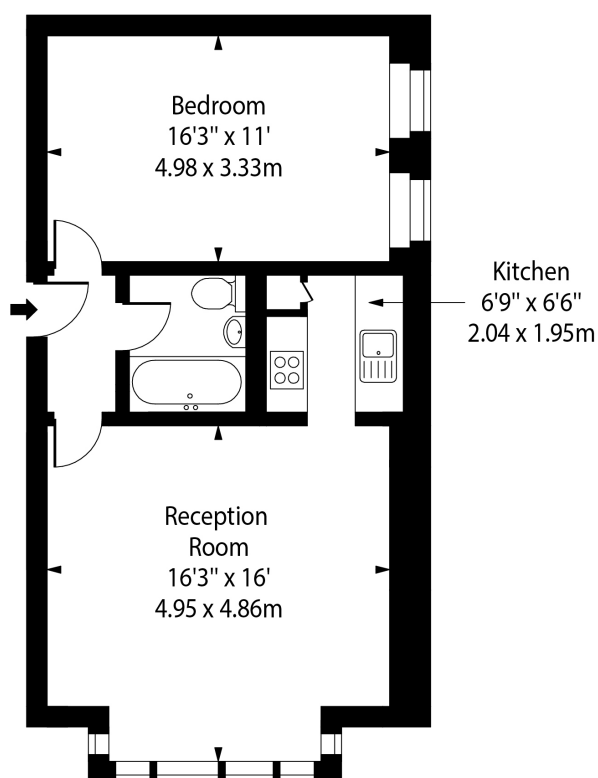
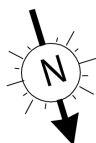

Ground Floor

Approx Gross Internal Area 558 Sq Ft - 51.88 Sq M

For Illustration Purposes Only - Not To Scale Floor Plan by www.nogaphotostudio.com Ref: No.51616

This floor plan should be used as a general outline for guidance only. Any intending purchaser or lessee should satisfy themselves by inspection, searches, enquiries and full survey as to the correctness of each statement. Any areas, measurements or distances quoted are approximate and should not be used to value a property or be the basis of any sale or let.